

FOR LEASE

Glencairn Shopping Centre | Regina | SK



GLENCAIRN SHOPPING CENTRE



Prominent Location

Flexible space facing Cavendish Street in this busy neighborhood strip centre servicing the entire Glencairn subdivision. Located only blocks from the Victoria East retail district and next to nail salon, plenty of parking at the door.

- Traffic count approximately 25,000 vehicles per day
- Shared/ random parking

Available Size: 1,200 SF

Net Lease Rate: \$18.00/ SF

Operating Costs: \$9.00/ SF

Tenants of this neighborhood strip centre include:

*The Salvation Army Thrift Store |
Ginger Beef | 7 Eleven | Western
Pizza | Polar Palace | H.K.
Insurance | Glencairn Drug Mart*

Contact Us

MICHAEL KELSEY
Associate VP | Sales Associate |
Partner
+1 306 501 8768
Michael.Kelsey@colliers.com

D'ARCY SKWARA
Associate VP | Sales Associate |
Partner
+1 306 535 2600
Darcy.Skwara@colliers.com

2505 11th Avenue, Suite 200
Regina, SK S4P 0K6
+1 306 789 8300

www.collierscanada.com/200209

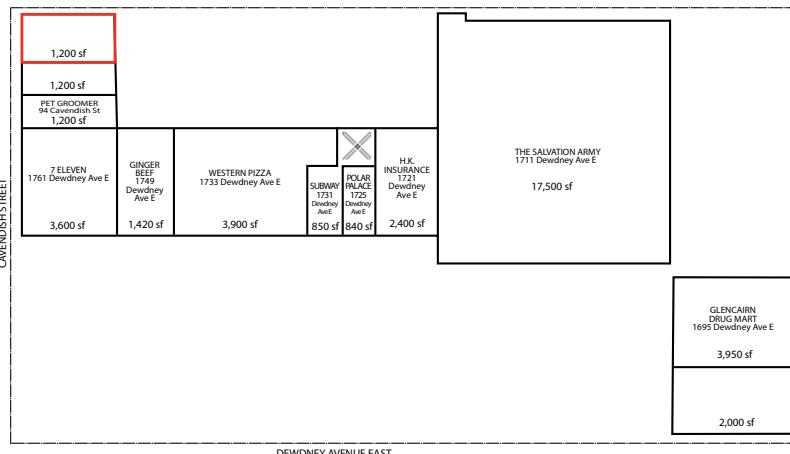

DEWDNEY AVENUE EAST

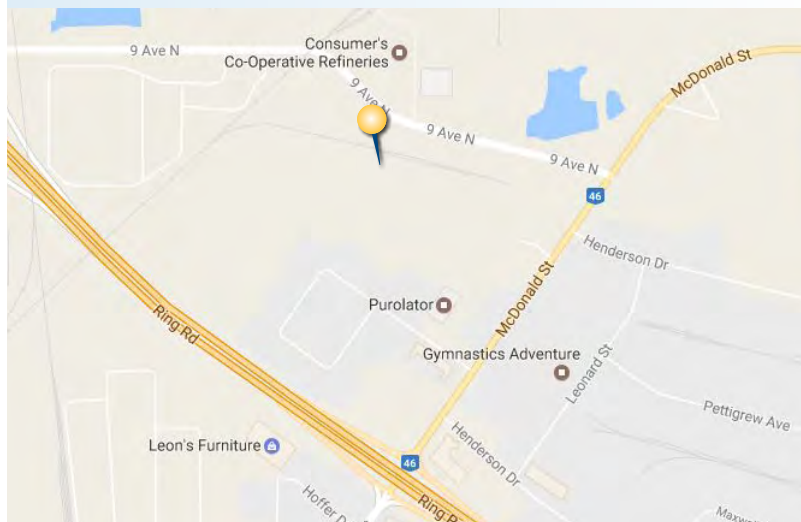

GLENCAIRN SHOPPING CENTRE
Regina, SK

TOTAL RENTABLE AREA: 40,060 SF