



Suburban Office Space for Lease

1,130 SF AVAILABLE

MARC FOUCHER
250 414 8392
marc.foucher@colliers.com



COLLIERS INTERNATIONAL
1175 Douglas Street, Suite 1110
Victoria, BC V8W 2E1
250 388 6454
www.collierscanada.com/victoria

The Pyramid Building 3301 Douglas Street | Victoria, BC

- › Conveniently located at the intersection of Douglas Street and Cloverdale Avenue
- › Fully renovated common areas
- › Generous on-site parking, plus client parking
- › Prominent pylon signage opportunities facing Douglas Street

3301 Douglas Street | Victoria, BC

FEATURES

- > Central North Douglas location
- > Renovated common areas
- > Generous free parking plus client parking
- > Excellent natural light
- > Bike storage
- > Signage on Douglas Street

AVAILABILITY

Suite	Size (SF)	Rate (PSF)	Op. Costs/Taxes (PSF)
103	1,130	\$17.00	\$10.89*

* Separately metered for hydro.



FIRST FLOOR PLAN

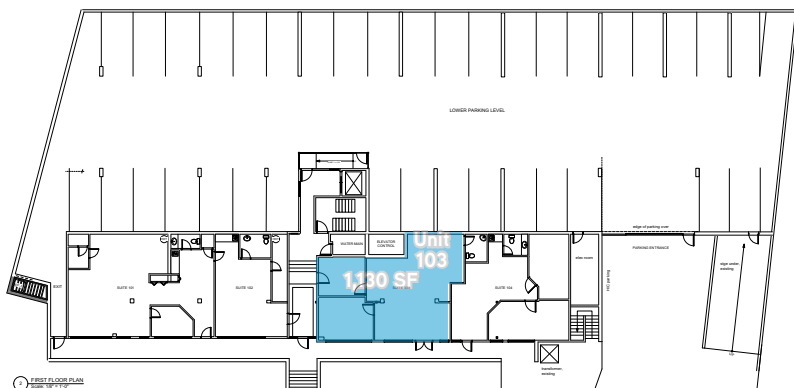

This document/email has been prepared by Colliers International for advertising and general information only. Colliers International makes no guarantees, representations or warranties of any kind, expressed or implied, regarding the information including, but not limited to, warranties of content, accuracy and reliability. Any interested party should undertake their own inquiries as to the accuracy of the information. Colliers International excludes unequivocally all inferred or implied terms, conditions and warranties arising out of this document and excludes all liability for loss and damages arising there from. This publication is the copyrighted property of Colliers International and/or its licensor(s). © 2018. All rights reserved. This communication is not intended to cause or induce breach of an existing listing agreement. Colliers Macaulay Nicolls Inc.



CONTACT US

MARC FOUCHER
250 414 8392
marc.foucher@colliers.com



COLLIERS INTERNATIONAL
1175 Douglas Street, Suite 1110
Victoria, BC
250 388 6454
www.collierscanada.com