



For Sublease | 623 Fort Street, Victoria, BC

# Fully Furnished Downtown Office Space

Located on vibrant Fort Street, directly opposite The Bay Centre and a short walk to Government Street, 623 Fort Street takes advantage of the best of the downtown core. Restaurants, shopping, the inner harbour and more are all within close proximity.

Accelerating success.

**Graham Smith**

Personal Real Estate Corporation  
Senior Vice President  
+1 250 414 8390  
graham.smith@colliers.com

**Colliers**

# Property Overview

Constructed in 2014, the subject property benefits from modern design features, including up to date elevators, HVAC and seismic. There are excellent end of trip facilities and a fitness area for tenants.

Features Include:

- Extensive glazing, allowing for exceptional natural light
- Existing buildout offering 12 offices, large open areas, lunchroom and copy area
- Full seismic upgrade to the building
- Approximately 8,500 SF of floor area
- Existing furniture, which can be included

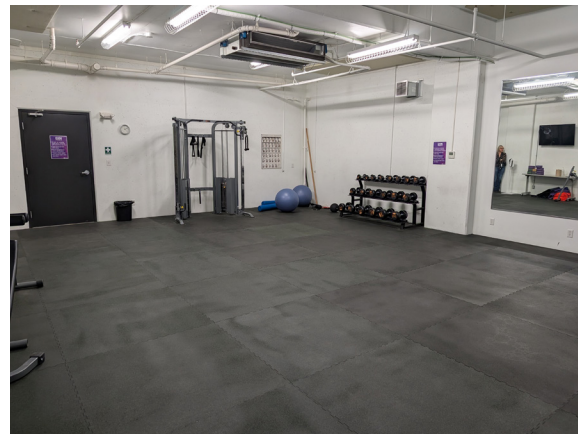

<b>Asking Net Rental Rate</b>	\$22.00 PSF
<b>Operating Costs &amp; Taxes</b>	\$14.89 PSF (estimated for 2025)
<b>Head Lease Expiry Date</b>	October 31, 2034

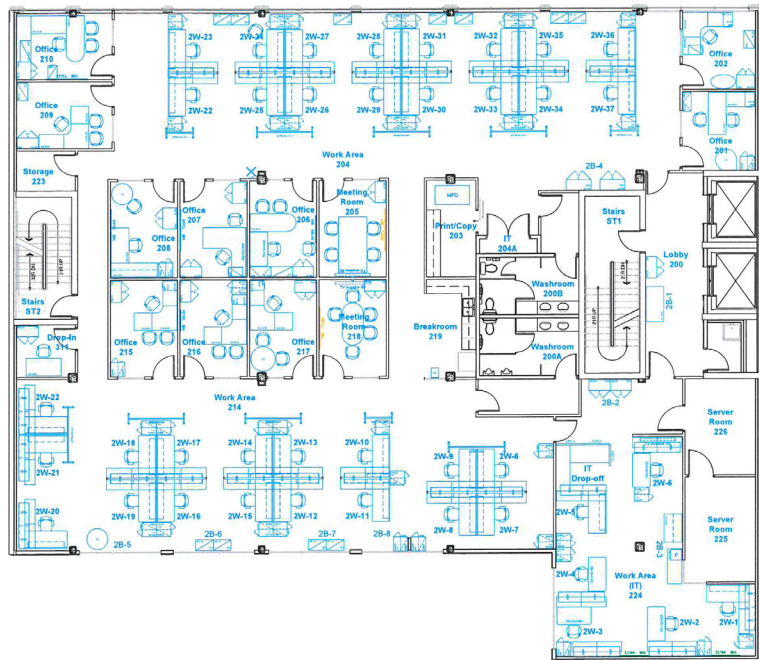

This document has been prepared by Colliers for advertising and general information only. Colliers makes no guarantees, representations or warranties of any kind, expressed or implied, regarding the information including, but not limited to, warranties of content, accuracy and reliability. Any interested party should undertake their own inquiries as to the accuracy of the information. Colliers excludes unequivocally all inferred or implied terms, conditions and warranties arising out of this document and excludes all liability for loss and damages arising there from. This publication is the copyrighted property of Colliers and/or its licensor(s). Copyright © 2025. All rights reserved. This communication is not intended to cause or induce breach of an existing listing agreement. Colliers Macaulay Nicolls Inc., Brokerage