

4800 GREAT 4980 AMERICA 4988 PARKWAY

SANTA CLARA



±451,900 SF

▶ Class A Office Campus
Sublease/Direct Lease

▶ **CRAIG L. FORDYCE**, SIOR, CCIM

+1 408 282 3911

craig.fordyce@colliers.com

CA Lic. 00872812

▶ **GRANT ZAMUDIO**, MCR

+1 408 656 1894

grant.zamudio@colliers.com

CA Lic. 01858005

Colliers

±451,900 SF ▽ Class A Office Campus Sublease/Direct Lease

4800 GREAT
4980 AMERICA
4988 PARKWAY
SANTA CLARA

CAMPUS OVERVIEW

► **CAMPUS SUBLEASE EXPIRATION**
February 28, 2026

► **LONG TERM LEASE AVAILABLE**

- Divisible to ±170,689 SF and ±281,900 SF
- 3.3/1,000 parking + EV parking on site
- Impressive views of Santa Clara's most prominent corridor from outdoor patios at each building
- Direct VTA access and quick entry/exit to Highways 237 and 101
- Efficient floorplates with low operating expenses and low-cost Silicon Valley Power
- All buildings feature their own generator and 3 passenger elevators and 1 freight elevator

±281,900 SF COMBINED

4988

Great America Parkway

±140,935 SF

4980

Great America Parkway

±140,965 SF

4800

Great America Parkway

±170,689 SF

PRIVATE
OUTDOOR
PATIO

CAMPUS
PARKING

HIGHLIGHTS

NEARBY TENANTS

4800 GREAT
4980 AMERICA
4988 PARKWAY





4988

GREAT AMERICA PARKWAY

Class A Office
Campus Sublease/Direct Lease

4800 GREAT
4980 AMERICA
4988 PARKWAY

4988

GREAT AMERICA PARKWAY

FLOORPLAN

FIRST FLOOR



Virtual Tour

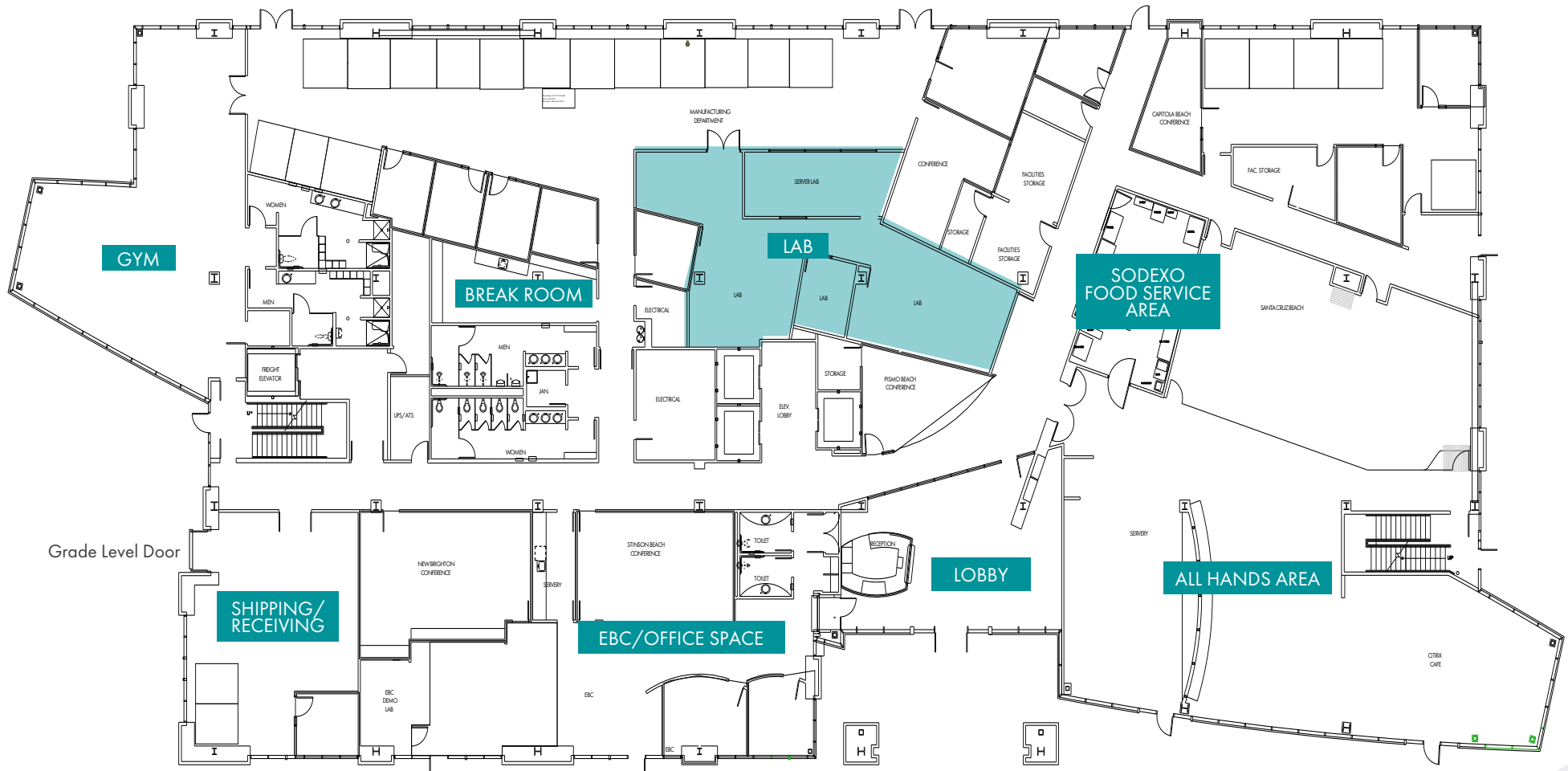
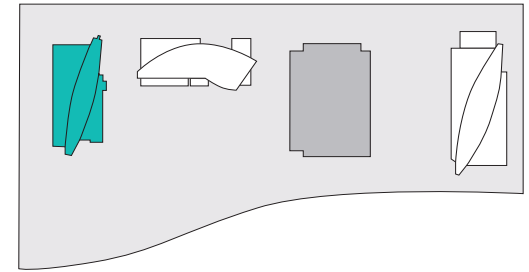

22	±8x8 Herman Miller workstations
12	Private Offices
5	Conference Rooms
5	Labs/Server Rooms

4800 GREAT
4980 AMERICA
4988 PARKWAY

GREAT AMERICA PARKWAY

TYPICAL FLOOR PLATE

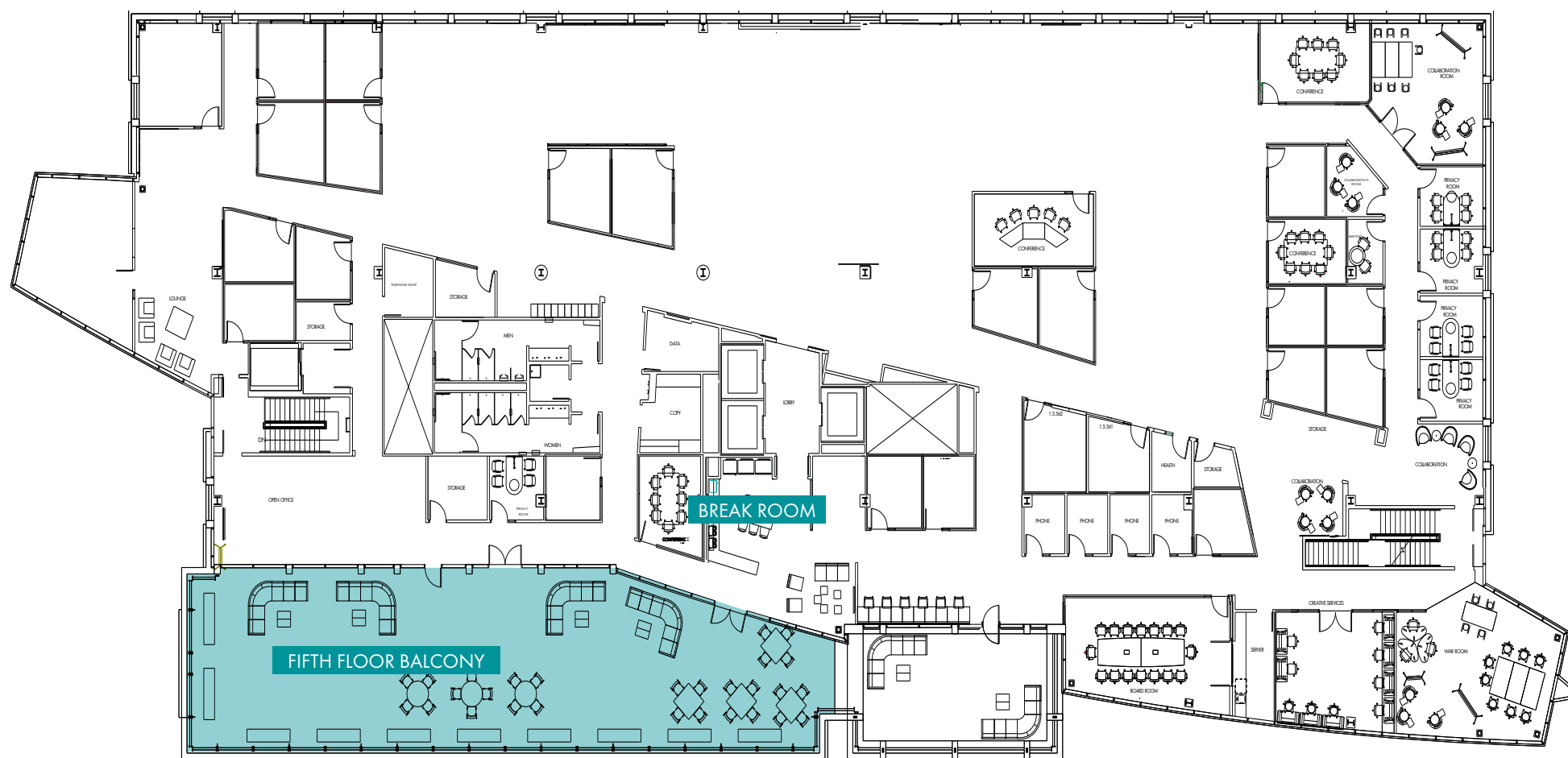

105	±7x7 Hayworth workstations
62	Private Offices
16	Conference Rooms
1	Labs/Server Rooms

4800 GREAT
4980 AMERICA
4988 PARKWAY

4988

GREAT AMERICA PARKWAY

BUILDING AMENITIES

4800 GREAT
4980 AMERICA
4988 PARKWAY



Ground Floor Café



Ground Floor Café Support



Ground Floor Gym



Shipping & Receiving

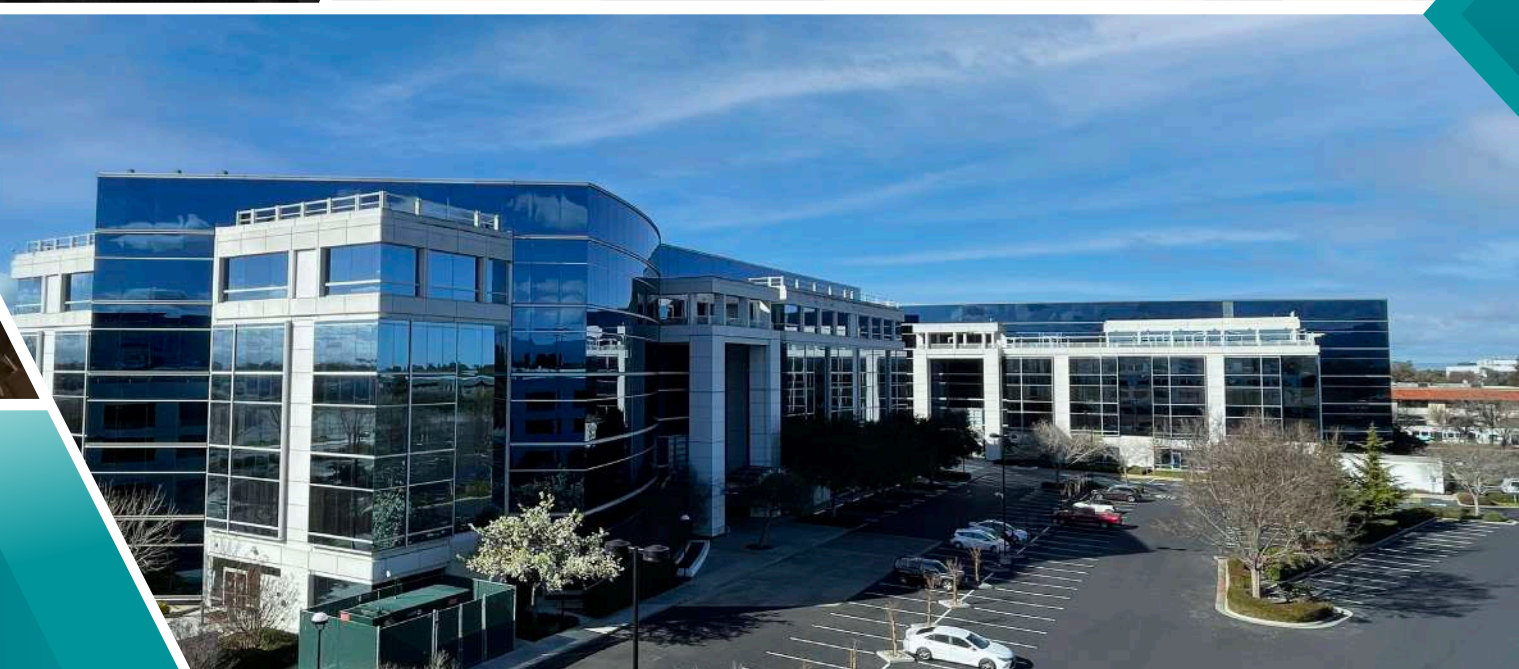
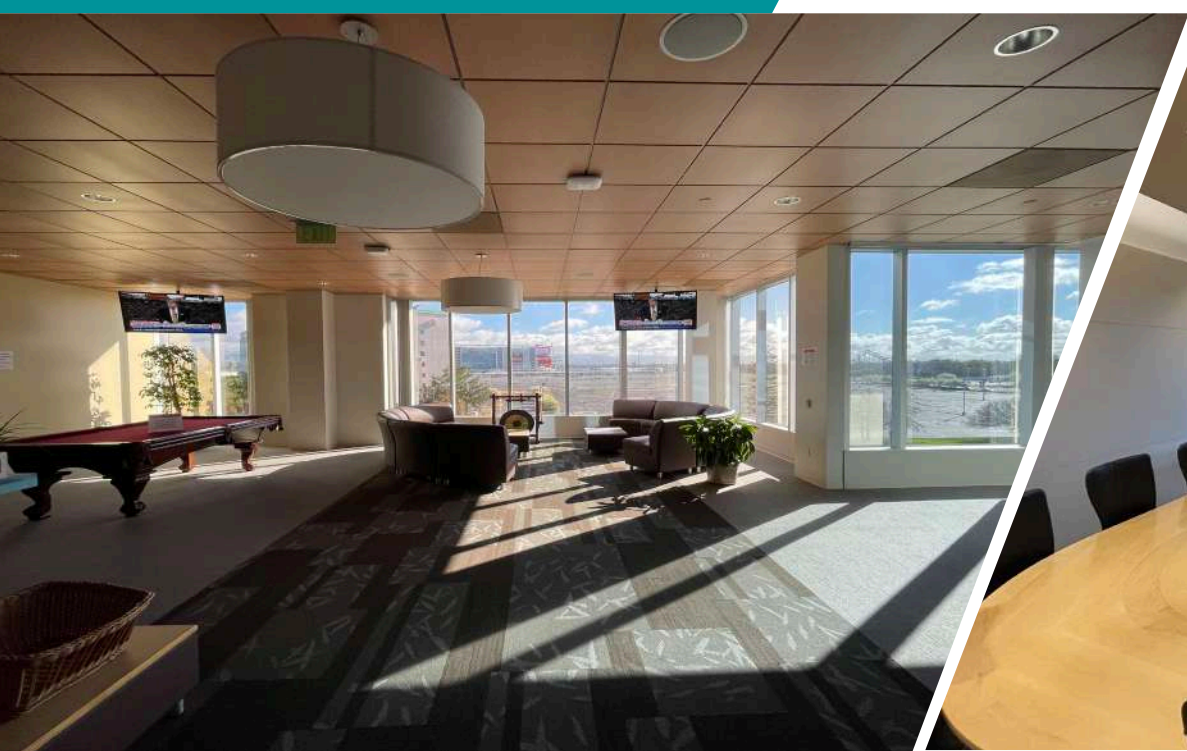

4980

GREAT AMERICA PARKWAY

Class A Office
Campus Sublease/Direct Lease

4800 GREAT
4980 AMERICA
4988 PARKWAY

4980

GREAT AMERICA PARKWAY

FLOORPLAN

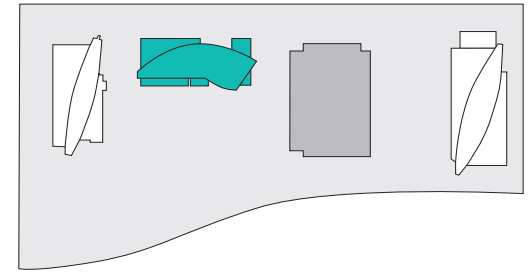

EXISTING LAYOUT

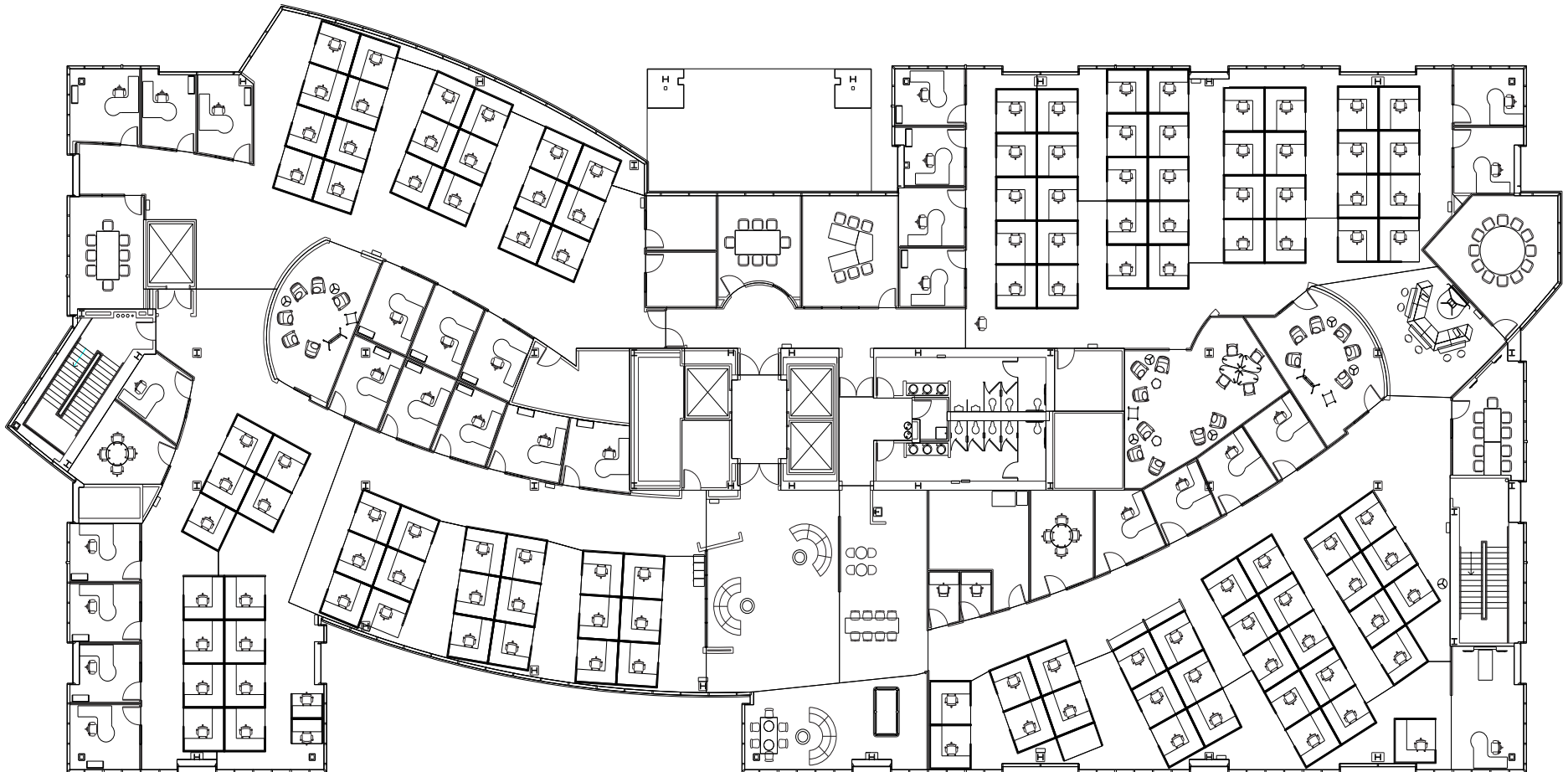

119	Workstations
27	Private Offices
8	Conference Rooms

4800 GREAT
4980 AMERICA
4988 PARKWAY

4980

GREAT AMERICA PARKWAY

FLOORPLAN

TYPICAL FLOOR PLATE

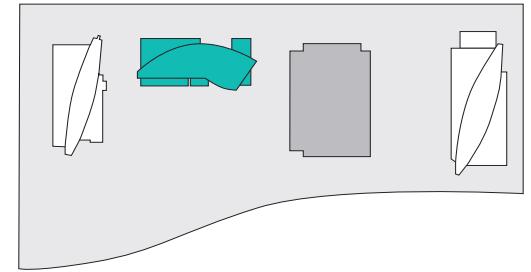

27	Private Offices
8	Conference Rooms

4800 GREAT
4980 AMERICA
4988 PARKWAY

4980

GREAT AMERICA PARKWAY

BUILDING AMENITIES

4800 GREAT
4980 AMERICA
4988 PARKWAY



Representative Office Space



Large Conference Room



Standard Breakroom

4800 GREAT
4980 AMERICA
4988 PARKWAY



Class A Office Campus
Sublease/Direct Lease

4800
GREAT AMERICA PARKWAY



4800

GREAT AMERICA PARKWAY

FLOORPLAN

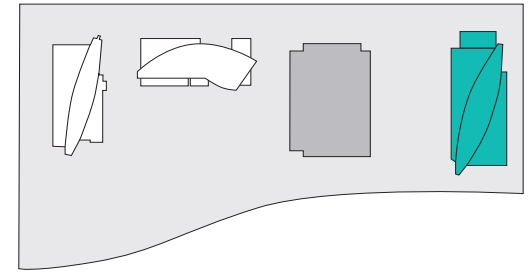

FIRST FLOOR

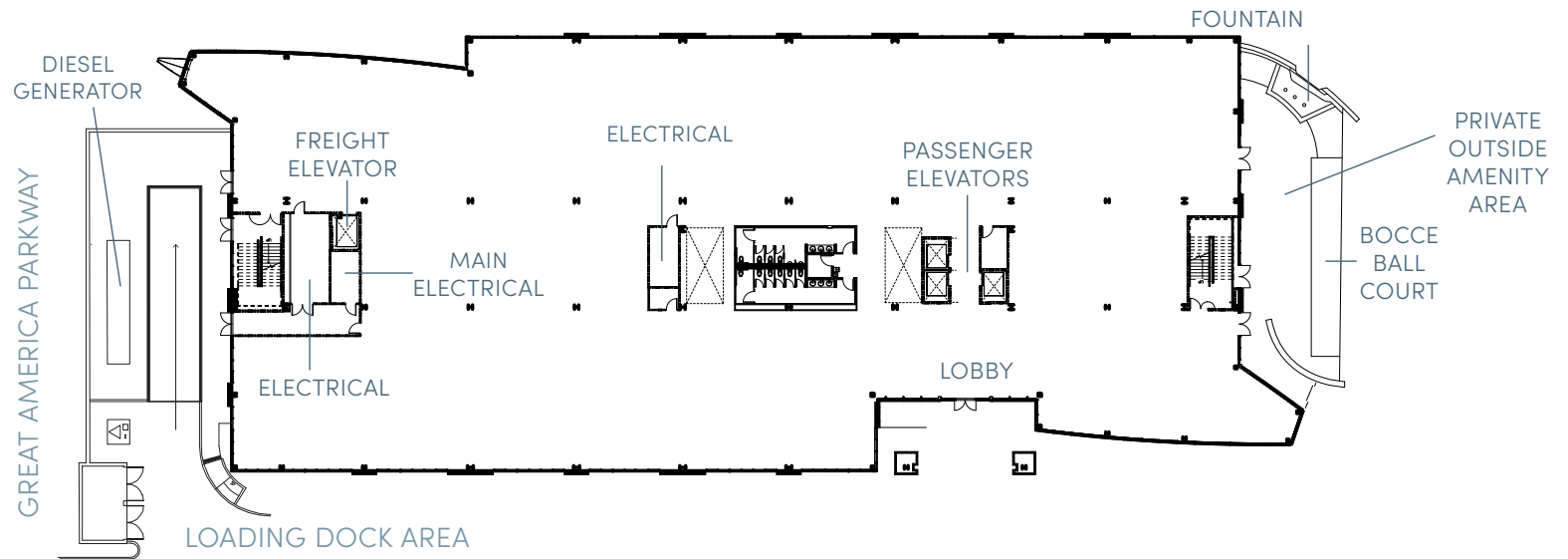

TYPICAL FLOOR PLATE

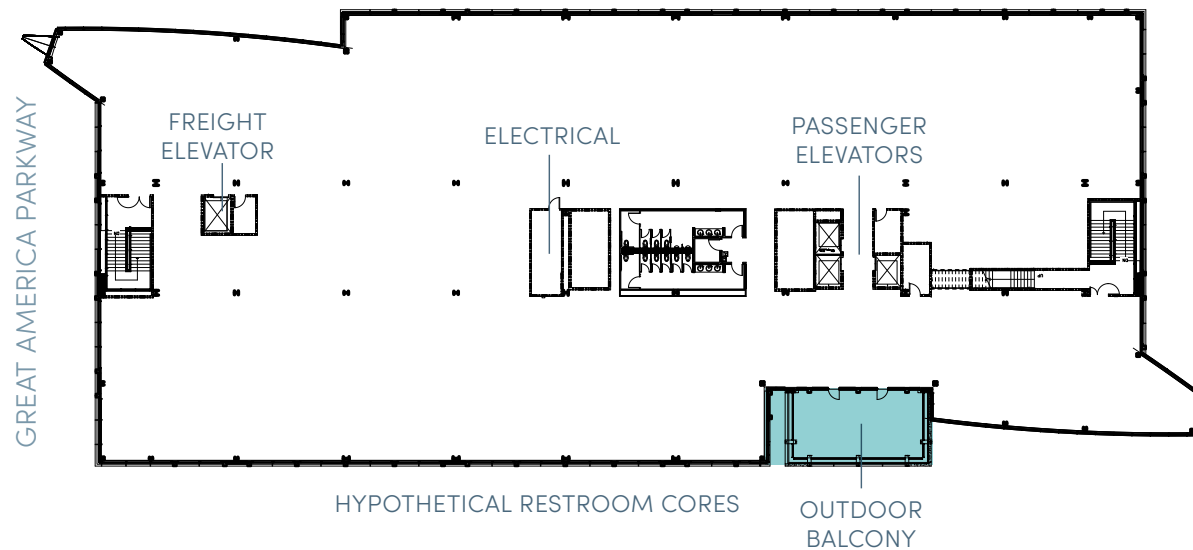

4800 GREAT
4980 AMERICA
4988 PARKWAY

4800 GREAT
4980 AMERICA
4988 PARKWAY
SANTA CLARA

±451,900 SF

Class A Office Campus
Sublease/Direct Lease

▼ **CRAIG L. FORDYCE**, SIOR, CCIM

+1 408 282 3911

craig.fordyce@colliers.com

CA Lic. 00872812

▼ **GRANT ZAMUDIO**, MCR

+1 408 656 1894

grant.zamudio@colliers.com

CA Lic. 01858005

This document has been prepared by Colliers for advertising and general information only. Colliers makes no guarantees, representations or warranties of any kind, expressed or implied, regarding the information including, but not limited to, warranties of content, accuracy and reliability. Any interested party should undertake their own inquiries as to the accuracy of the information. Colliers excludes unequivocally all inferred or implied terms, conditions and warranties arising out of this document and excludes all liability for loss and damages arising there from. This publication is the copyrighted property of Colliers and/or its licensor(s). ©2023. All rights reserved.



225 West Santa Clara Street, 10th Floor, Suite 1000, San Jose, CA 95113 | 650 486 2200 | colliers.com/siliconvalley