

FOR LEASE > FLEX SPACE

Colonel Glenn Corporate Center I
10600 Colonel Glenn Rd, Little Rock, AR



Location

10600 Colonel Glenn is located in south Little Rock with great access to I-430

Site Size

- > 61,500 SF
- > +/- 4.24 acres

Zoning

- > I-1 - Industrial Park District

Year Built / Expanded

- > 1996

Building Features

- > 24' clear height
- > 7 dock doors and 5 drive in doors
- > Fully sprinklered
- > Rear loading

Available Suites & Rates

Suite 300	5,000 SF (2,395 SF office)	\$9.25 NNN
Suite 500	7,520 SF (2,395 SF office)	\$8.50 NNN
CAM: \$1.60/SF		

FOR LEASE > FLEX SPACE

Colonel Glenn Corporate Center I
10600 Colonel Glenn Rd, Little Rock, AR

Colliers
INTERNATIONAL

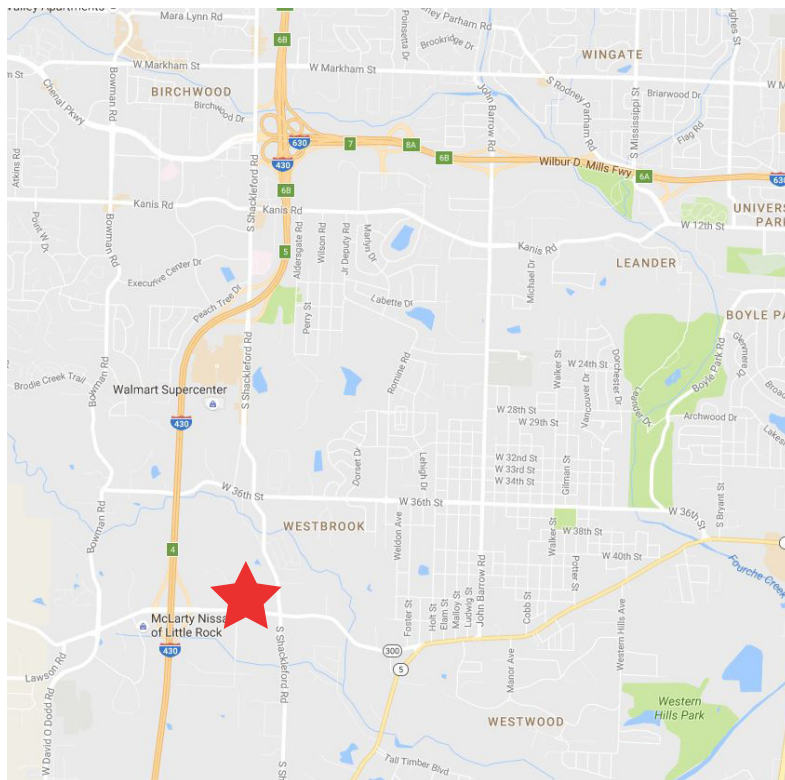

Contact Us

CASI RUNNELLS, RPA
501 372 6161 | 713
casi.runnells@colliers.com

DREW HOLBERT, CCIM, SIOR
501 372 6161 | 756
drew.holbert@colliers.com

COLLIERS INTERNATIONAL
1 Allied Dr, Suite 1500
Little Rock, AR 72202
+1 501 372 6161
www.colliers.com/arkansas

FLOOR PLANS

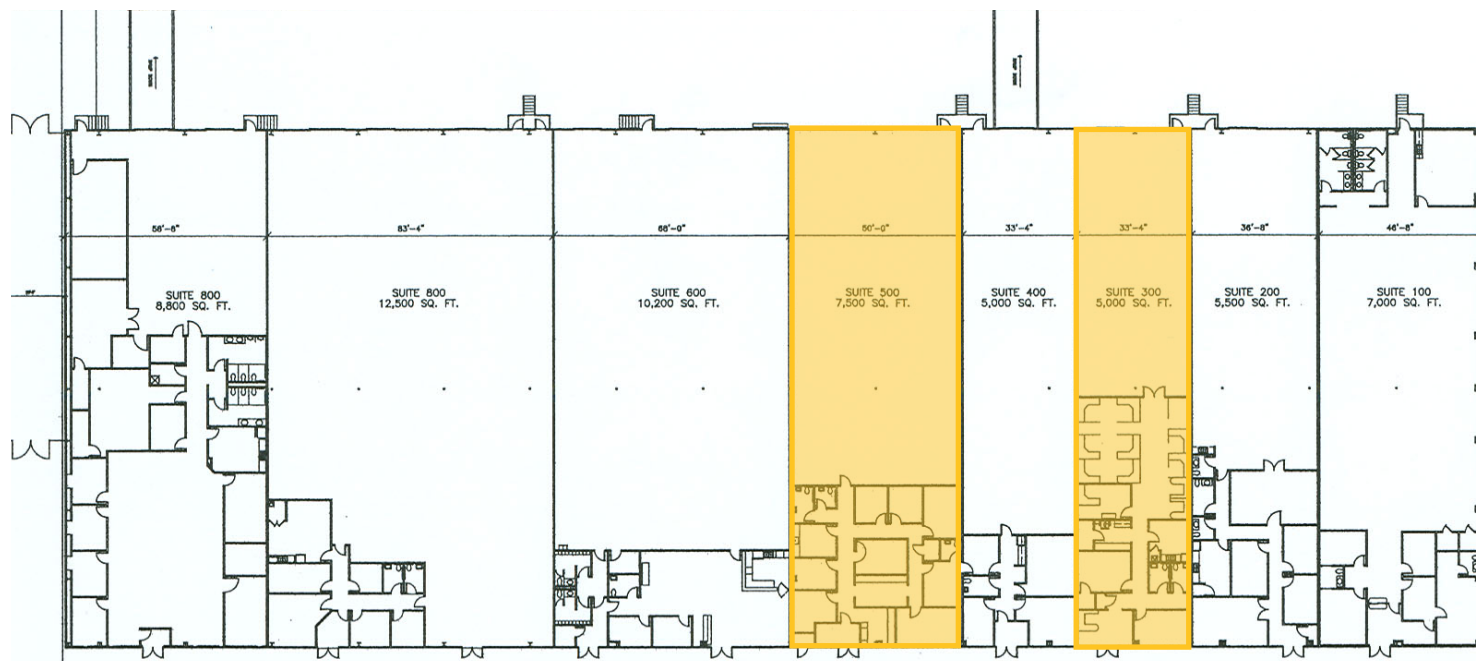

This document has been prepared by Colliers International for advertising and general information only. Colliers International makes no guarantees, representations or warranties of any kind, expressed or implied, regarding the information including, but not limited to, warranties of content, accuracy and reliability. Any interested party should undertake their own inquiries as to the accuracy of the information. Colliers International excludes unequivocally all inferred or implied terms, conditions and warranties arising out of this document and excludes all liability for loss and damages arising there from. This publication is the copyrighted property of Colliers International and/or its licensor(s). ©2016. All rights reserved.