



RETAIL SPACE FOR LEASE

# FISHER BUILDING

3011 | W. GRAND BOULEVARD  
DETROIT, MI

746 | Min. Available  
SF

8,149 | Max. Available  
SF



## PROPERTY HIGHLIGHTS

- Historic Building
- Fisher Theater Will Host Approximately 200 Events in 2018
- 1,500 to 2,000 Daily Employees in the Building
- Ample Parking in Surrounding Lots & Structures

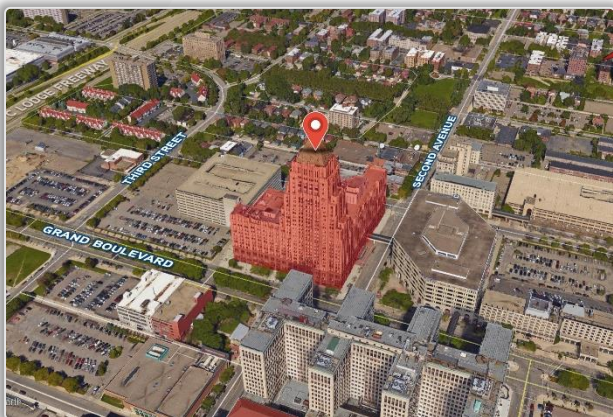

## DEMOGRAPHICS

	1 MILE	3 MILE	5 MILE
POPULATION	15,264	131,430	333,094
AVG. INCOME	\$36,268	\$36,433	\$37,850
HOUSEHOLDS	7,254	56,464	134,273

## CONTACT US

**BEN HUBERT**  
VICE PRESIDENT  
PHONE: (248) 540-1000 EXT: 1864  
EMAIL: ben.hubert@colliers.com

**BEN ROSENZWEIG**  
VICE PRESIDENT  
PHONE: (248) 540-1000 EXT: 1866  
EMAIL: ben.rosenzweig@colliers.com

**COLLIERS INTERNATIONAL | DETROIT**  
2 Corporate Drive | Suite 300  
Southfield, MI 48076  
[www.colliers.com/detroit](http://www.colliers.com/detroit)



# PROPERTY PHOTOS

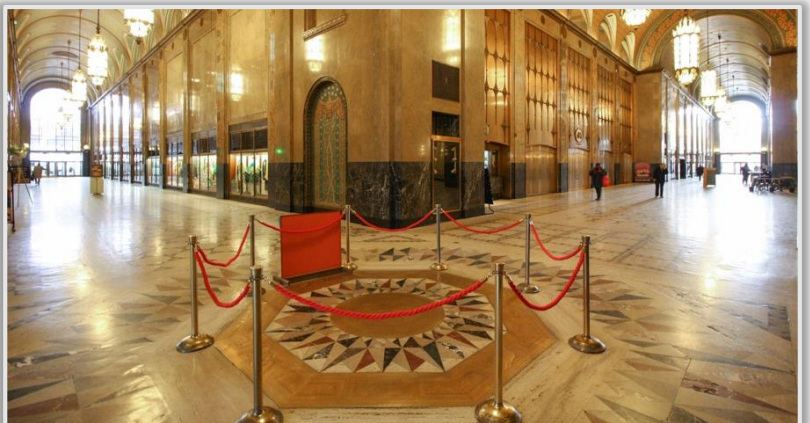





# PROPERTY LOCATION

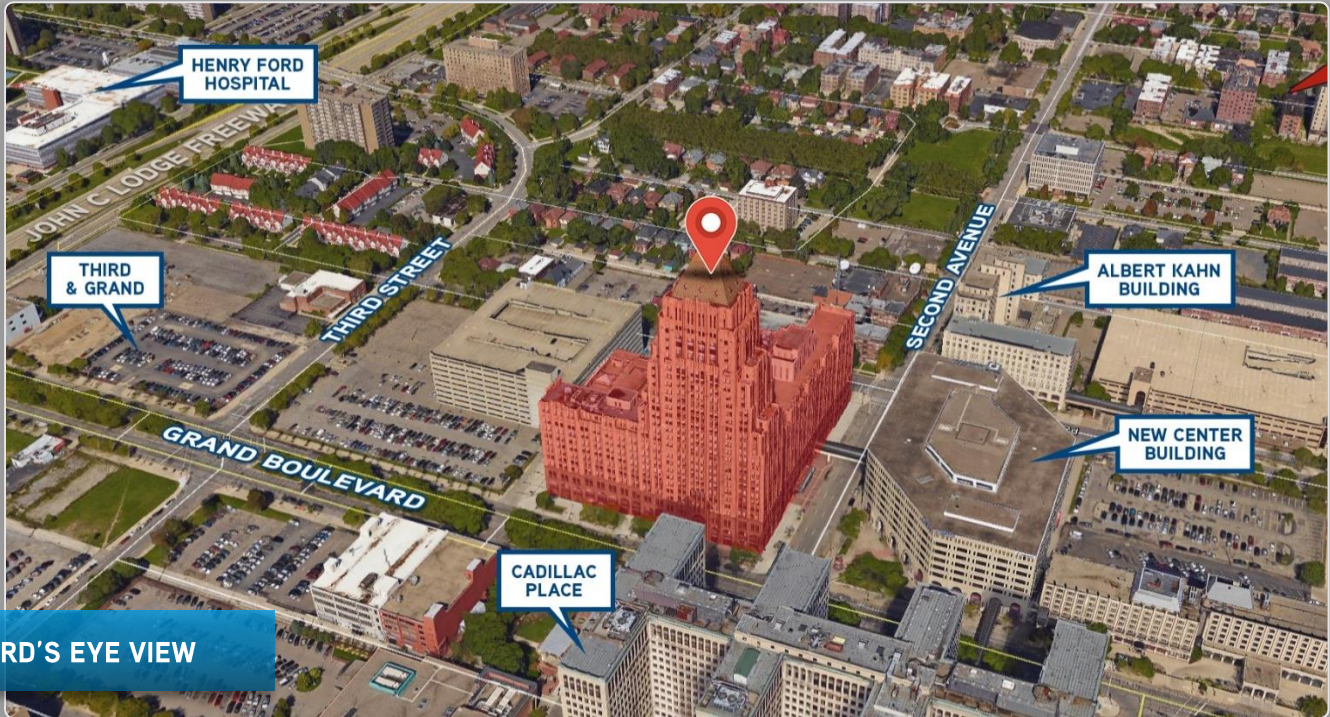

BIRD'S EYE VIEW



QLINE MAP

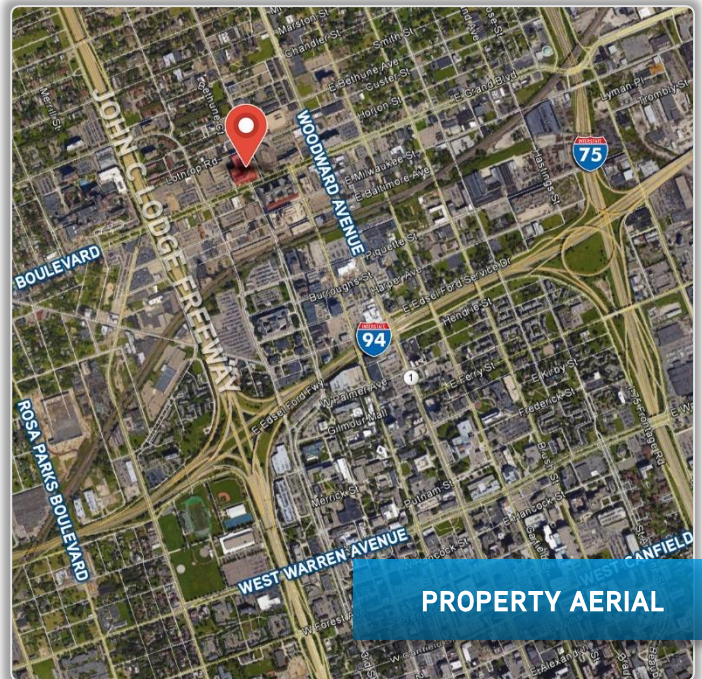

PROPERTY AERIAL





# AVAILABLE SPACES

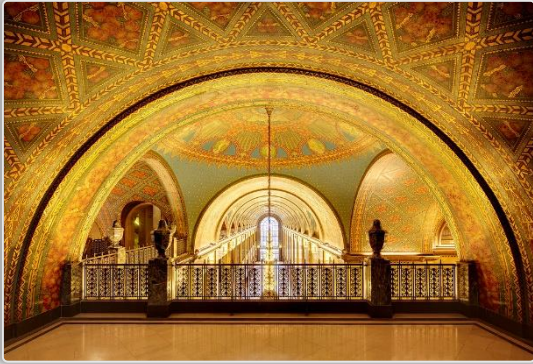

SUITE	AVAILABLE SF	AVAILABILITY
C8	1,237 SF	Immediate
C10	1,354 SF	Immediate
C30	1,048 SF	Immediate

## CONCOURSE FLOOR LAYOUT

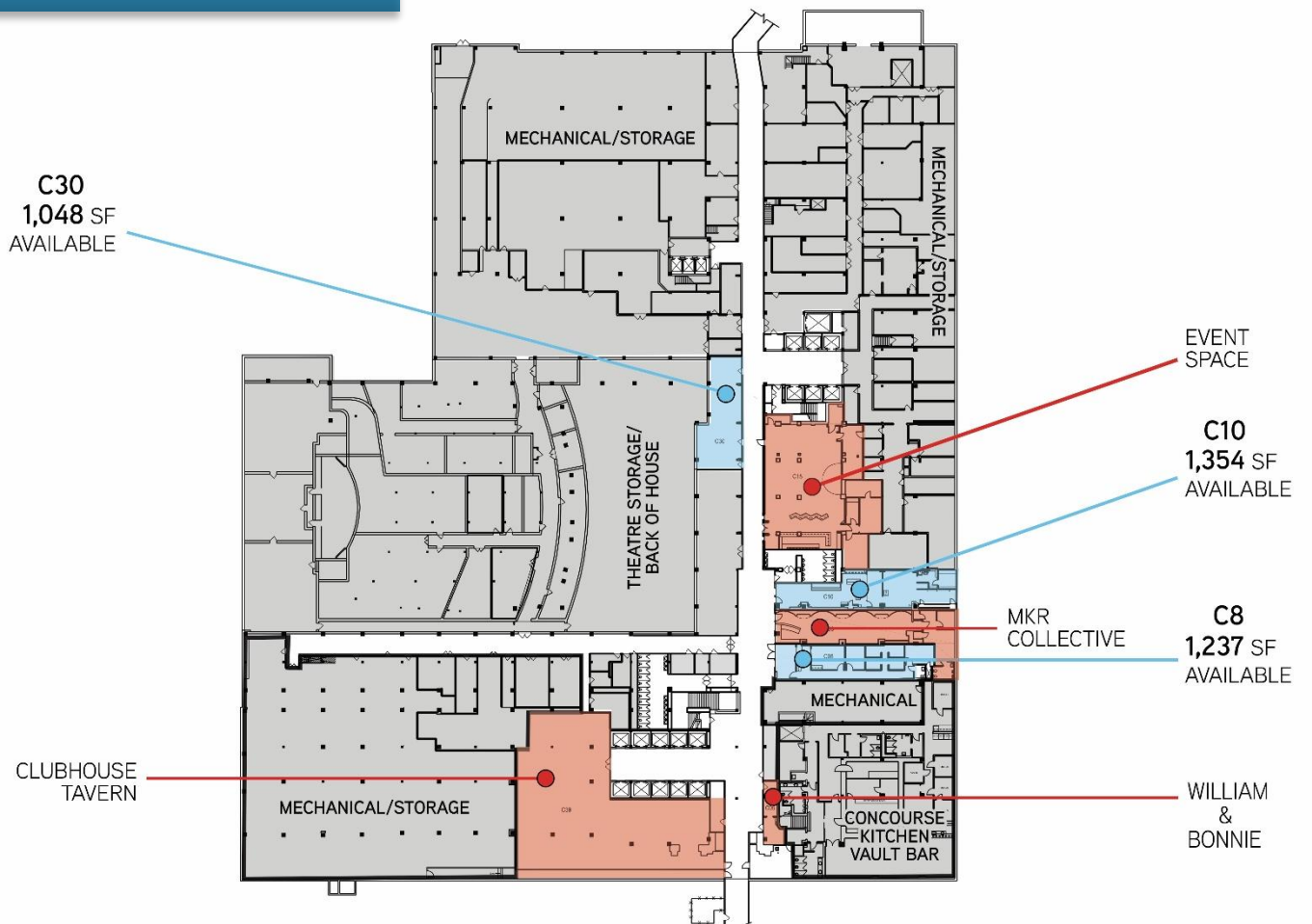



# AVAILABLE SPACES



SUITE	AVAILABLE SF	AVAILABILITY
111	8,149 SF	Immediate
114	793 SF	Immediate
116	2,661 SF	2019
122	2,792 SF	90 Days
124	746 SF	Immediate
125	1,052	Immediate

## 1st FLOOR LAYOUT

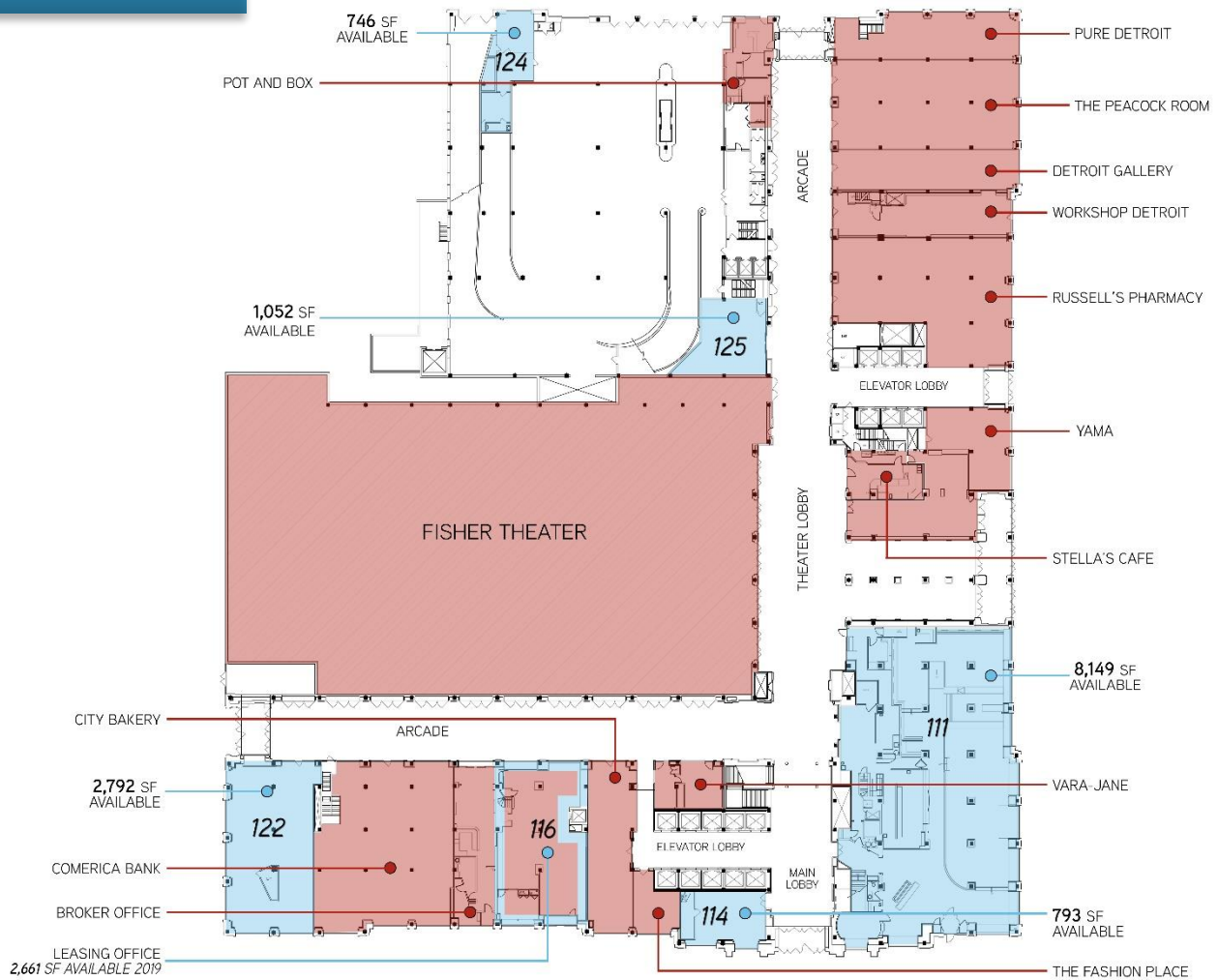



# LOCAL SURROUNDINGS

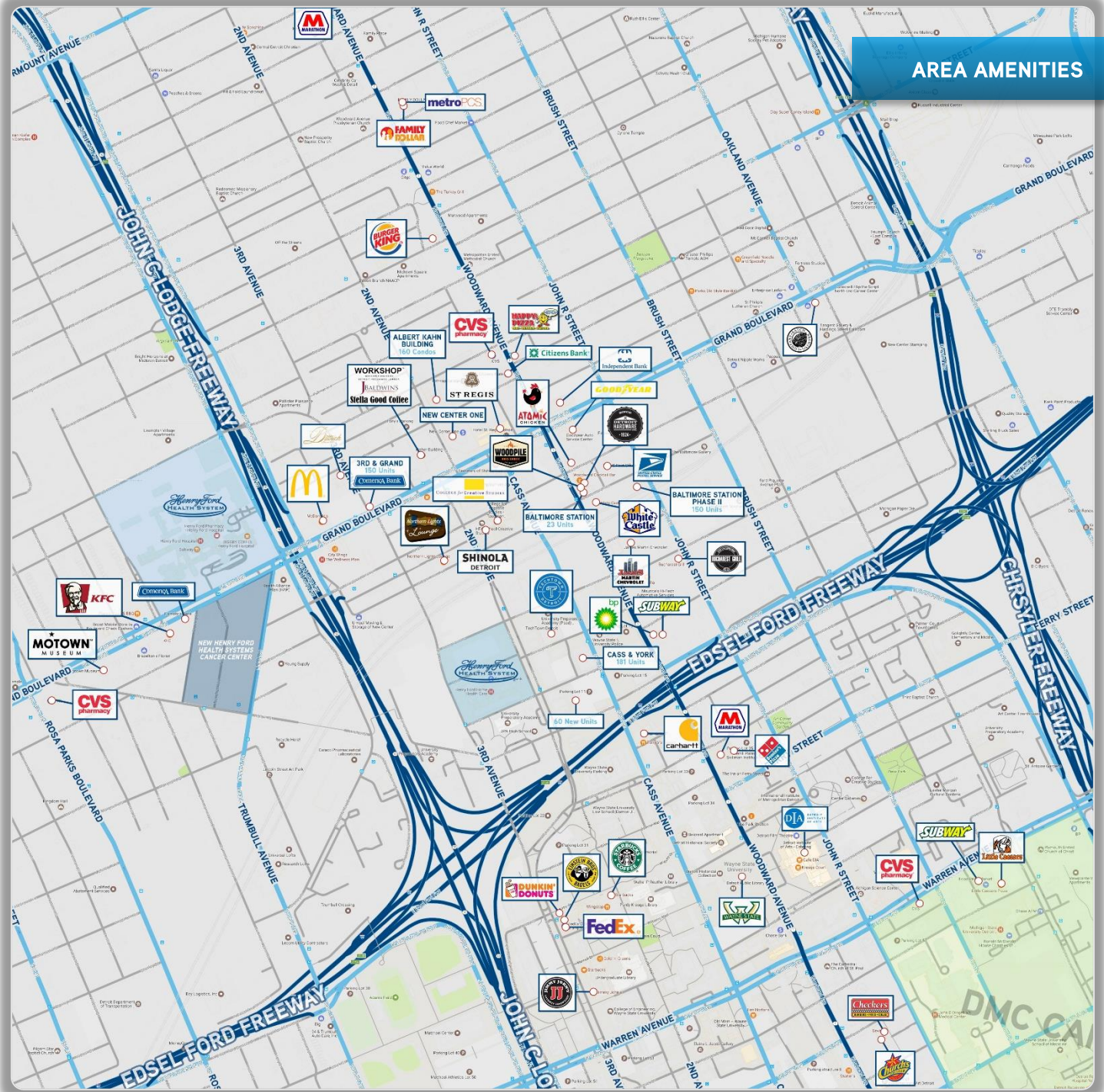

# SUMMARY PROFILE

2000-2010 Census, 2017 Estimates with 2022 Projections

Calculated using Weighted Block Centroid from Block Groups



Lat/Lon: 42.3696/-83.0772

RS1

3011 W Grand Blvd		1 mi radius	3 mi radius	5 mi radius
Detroit, MI 48202				
POPULATION	2017 Estimated Population	15,264	131,430	333,094
	2022 Projected Population	16,731	143,105	356,344
	2010 Census Population	15,488	137,942	353,575
	2000 Census Population	20,716	182,122	474,715
	Projected Annual Growth 2017 to 2022	1.9%	1.8%	1.4%
	Historical Annual Growth 2000 to 2017	-1.5%	-1.6%	-1.8%
	2017 Median Age	35.4	36.2	36.1
HOUSEHOLDS	2017 Estimated Households	7,254	56,464	134,273
	2022 Projected Households	8,149	63,217	147,706
	2010 Census Households	7,046	56,870	136,758
	2000 Census Households	8,614	70,214	172,715
	Projected Annual Growth 2017 to 2022	2.5%	2.4%	2.0%
	Historical Annual Growth 2000 to 2017	-0.9%	-1.2%	-1.3%
RACE AND ETHNICITY	2017 Estimated White	19.6%	21.6%	22.5%
	2017 Estimated Black or African American	72.5%	66.7%	65.3%
	2017 Estimated Asian or Pacific Islander	4.0%	7.4%	3.8%
	2017 Estimated American Indian or Native Alaskan	0.3%	0.3%	0.4%
	2017 Estimated Other Races	3.7%	4.1%	8.0%
	2017 Estimated Hispanic	2.4%	2.9%	11.0%
INCOME	2017 Estimated Average Household Income	\$36,268	\$36,433	\$37,850
	2017 Estimated Median Household Income	\$23,395	\$25,159	\$28,003
	2017 Estimated Per Capita Income	\$18,183	\$16,236	\$15,698
EDUCATION (AGE 25+)	2017 Estimated Elementary (Grade Level 0 to 8)	3.9%	7.5%	8.7%
	2017 Estimated Some High School (Grade Level 9 to 11)	12.6%	14.9%	16.1%
	2017 Estimated High School Graduate	28.9%	30.5%	31.3%
	2017 Estimated Some College	24.7%	23.5%	23.0%
	2017 Estimated Associates Degree Only	5.6%	6.2%	5.9%
	2017 Estimated Bachelors Degree Only	12.2%	10.0%	8.7%
	2017 Estimated Graduate Degree	11.9%	7.5%	6.2%
BUSINESS	2017 Estimated Total Businesses	1,357	7,236	13,801
	2017 Estimated Total Employees	31,673	118,233	218,068
	2017 Estimated Employee Population per Business	23.3	16.3	15.8
	2017 Estimated Residential Population per Business	11.3	18.2	24.1

This report was produced using data from private and government sources deemed to be reliable. The information herein is provided without representation or warranty.