

PRICED TO SELL > INDUSTRIAL SPACE > ±676,548 SF



# 1 Guardian Way

WINNSBORO, SOUTH CAROLINA 29180



The subject property is a ±676,548 SF manufacturing building. The building enjoys high ceiling clear heights, heavy power and ample docking abilities in a high incentive county. The site is located in Fairfield County, SC about 20 minutes north of Columbia, SC and 60 minutes south of Charlotte, NC.

CHARLES W. SALLEY, SIOR  
803 401 4266 DIRECT  
[chuck.salley@colliers.com](mailto:chuck.salley@colliers.com)

DAVE MATHEWS, SIOR  
803 401 4293 DIRECT  
[dave.mathews@colliers.com](mailto:dave.mathews@colliers.com)

THOMAS BEARD  
803 401 4247 DIRECT  
[thomas.beard@colliers.com](mailto:thomas.beard@colliers.com)

COLLIERS INTERNATIONAL  
1301 Gervais Street, Suite 600  
Columbia, South Carolina 29201  
[www.colliers.com](http://www.colliers.com)



AVAILABLE > INDUSTRIAL SPACE > ±676,548 SF

# 1 Guardian Way

WINNSBORO, SOUTH CAROLINA 29180



## 1 Guardian Way > Industrial Space

Located 6 miles off exit 34 from I-77 N just 20 minutes north of Columbia, SC and 60 minutes south of Charlotte, NC in Fairfield County.

## Building Amenities

- > **Year Built:** 1987 (Renovations in 2015/16)
- > **Condition:** Good
- > **Former Use:** Truck Assembly & Insulation Manufacturing
- > **Parking:** ±1250 available spaces
- > **Sprinkler:** 100% sprinklered
- > **Clear Height:** 25'-56'
- > **Rail Siding:** Served by Norfolk Southern Rail Spur
- > **Ports:** Port of Charleston, 140 Miles
- > **Interstate Access:** I-77, 6 Miles  
I-20, 20 Miles
- > **Commercial Airport:** Columbia Metropolitan Airport, 40 Miles  
Charlotte International Airport, 60 Miles
- > **Doors:** 33 Dock High Doors  
6 Drive-In Doors
- > **Site:** 150.48 Acres
- > **Utilities:** *Electricity:* SCE&G (dedicated substation on-site)  
*Gas:* Town of Winnsboro  
*Water:* Town of Winnsboro  
*Sewer:* Town of Winnsboro
- > **REDUCED PRICE:** \$11,500,000.00

AVAILABLE > INDUSTRIAL SPACE > ±676,548 SF

# 1 Guardian Way

WINNSBORO, SOUTH CAROLINA 29180

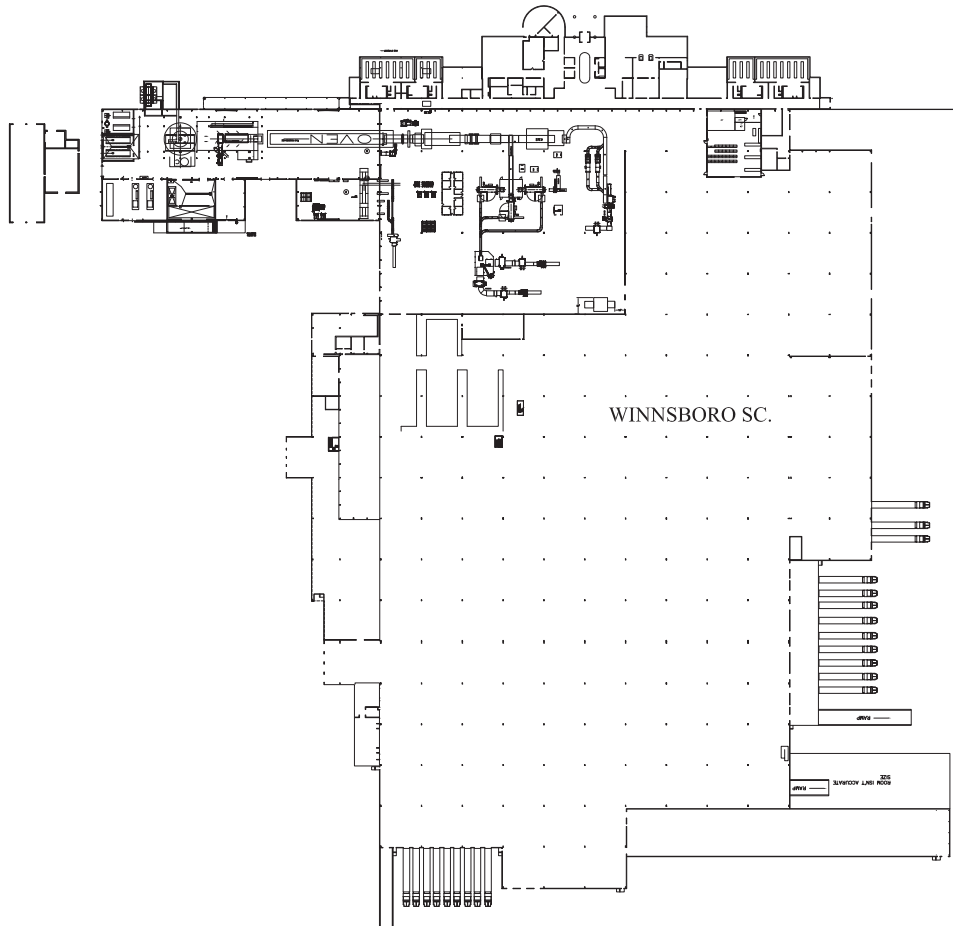

## 1 Guardian Way. > Floor Plan

### Construction:

*Floor:* 8" reinforced concrete slab  
*Walls:* Insulated Metal & Concrete Panels  
*Roof:* White TPO (installed in 2016)  
*Columns:* 50'x50'

### Building Area:

*Office Area:* ±31,809 SF  
*Mfg. / Whse. Space:* ±644,146 SF  
*Total:* ±676,548 SF

### Miscellaneous:

> 102'x102' truck service garage with drive through bays  
> Includes Lahti Precision Dry Mix Tower Plant

AVAILABLE > INDUSTRIAL SPACE > ±676,548 SF

# 1 Guardian Way

WINNSBORO, SOUTH CAROLINA 29180

## Contact Us

CHARLES W. SALLEY, SIOR  
803 401 4266 DIRECT  
[chuck.salley@colliers.com](mailto:chuck.salley@colliers.com)

DAVE MATHEWS, SIOR  
803 401 4293 DIRECT  
[dave.mathews@colliers.com](mailto:dave.mathews@colliers.com)

THOMAS BEARD  
803 401 4247 DIRECT  
[thomas.beard@colliers.com](mailto:thomas.beard@colliers.com)

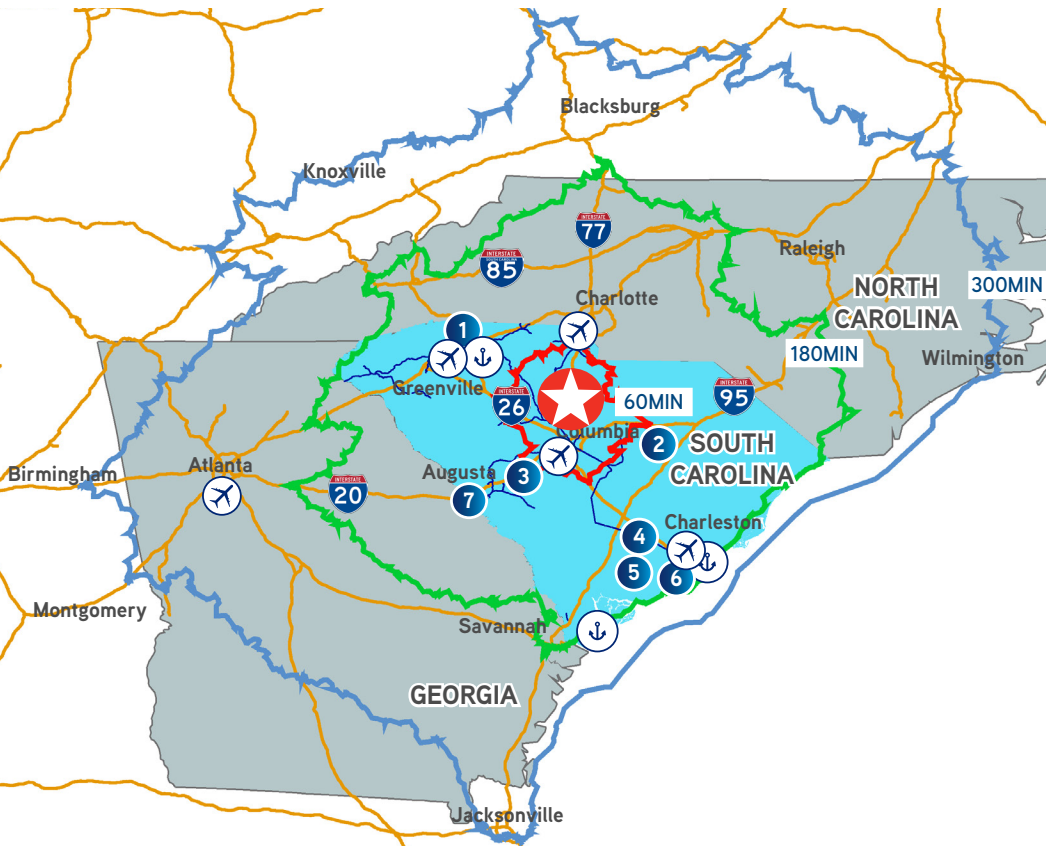

### DISTANCE from 1 GUARDIAN WAY to:

- |  |  |
|--|--|
| 1 BMW Manufacturing Co. <br>114 minutes | 5 Boeing Co. <br>125 minutes                      |
| 2 Continental Tire <br>81 minutes       | 6 Daimler Vans Manufacturing, LLC <br>122 minutes |
| 3 Michelin Tires <br>45 minutes         | 7 Bridgestone Tires <br>94 minutes                |
| 4 Volvo <br>165 minutes                 |  |

COLLIERS INTERNATIONAL  
1301 Gervais Street  
Suite 600  
Columbia, South Carolina 29201  
[www.colliers.com](http://www.colliers.com)

This document has been prepared by Colliers International for advertising and general information only. Colliers International makes no guarantees, representations or warranties of any kind, expressed or implied, regarding the information including, but not limited to, warranties of content, accuracy and reliability. Any interested party should undertake their own inquiries as to the accuracy of the information. Colliers International excludes unequivocally all inferred or implied terms, conditions and warranties arising out of this document and excludes all liability for loss and damages arising there from. This publication is the copyrighted property of Colliers International and/or its licensor(s). ©2014. All rights reserved.

