

FOR LEASE > EAST KC INDUSTRIAL PARK

1200 NW Pamela Blvd

GRAIN VALLEY, MO



Property Details

- > Building size: 26,000 SF
- > Available space:
 - > Suite B-E: 9,600 SF (can be demised to 2,400 SF)
 - > Suite H: 2,400 SF
- > Clear height: 20'
- > Loading: 10 drive-in doors (12' x 14') 1 dock-high door
- > Electrical: 200 AMP 120/208v 3-phase
- > Sprinkler: Wet system
- > Roof: metal
- > Parking: 80 surface spaces
- > \$7.00 PSF gross industrial
 - > CAM included in rate
- > Year built: 2017
- > Great visibility & access to I-70

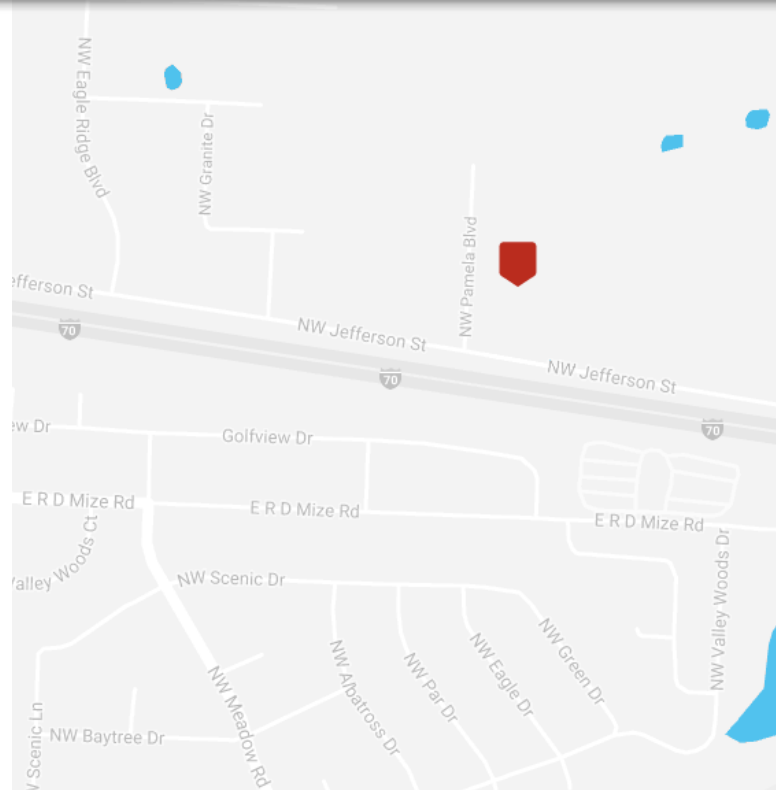

JOHN STAFFORD sior
+1 816 556 1184
KANSAS CITY, MO
john.stafford@colliers.com

TOM KENNEDY
+1 816 556 1118
KANSAS CITY, MO
tom.kennedy@colliers.com

COLLIERS INTERNATIONAL
4520 Main Street, Suite 1000
Kansas City, MO 64111
www.colliers.com

1200 NW Pamela Blvd

Floor Plan > 1200 NW Pamela

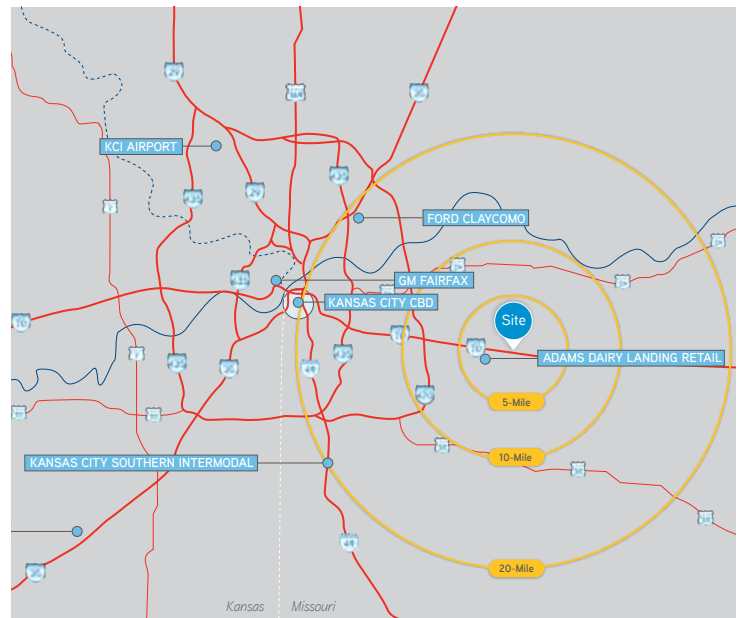

TOM KENNEDY
+1 816 556 1118
KANSAS CITY, MO
tom.kennedy@colliers.com

