



FOR SALE > CALL BROKER FOR PRICING

6.03 ACRES DEVELOPMENT OPPORTUNITY WITH CURRENT INCOME

Marina Boulevard's Premier Property

620, 680, 700, 718, 754 MARINA BOULEVARD, SAN LEANDRO, CA
2009, 2035 & 2056 MARTINEZ STREET, SAN LEANDRO, CA

FOR MORE INFORMATION CONTACT:

DAN BERGEN
+1 925 227 6227
dan.bergen@colliers.com
CA License No. 00878103

JASON ALLEN, CCIM
+1 925 227 6266
jason.allen@colliers.com
CA License No. 01438182

This document has been prepared by Colliers International for advertising and general information only. Colliers International makes no guarantees, representations or warranties of any kind, expressed or implied, regarding the information including, but not limited to, warranties of content, accuracy and reliability. Any interested party should undertake their own inquiries as to the accuracy of the information. Colliers International excludes unequivocally all inferred or implied terms, conditions and warranties arising out of this document and excludes all liability for loss and damages arising there from. This publication is the copyrighted property of Colliers International and/or its licensor(s).
©2016. All rights reserved.



Property Parcels

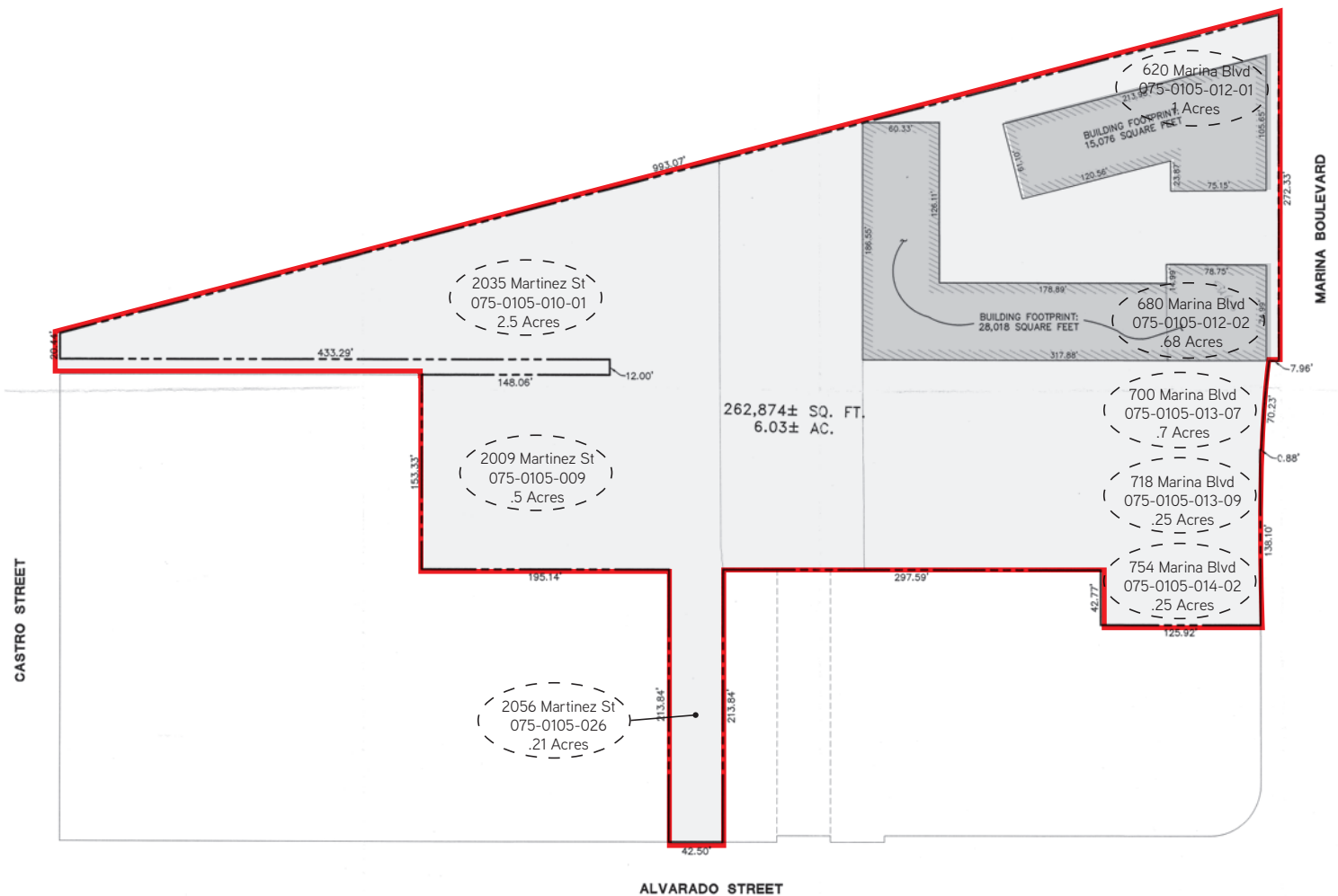

MARINA BOULEVARD LAND

- Mixed-use development
- Near Ford Motor, Honda, Nissan, Chrysler-Jeep, McKevitt Volvo
- Transit-oriented area
- Urban residential area with BART & highway I-880 immediate proximity

FEATURES:

- Two (2) Manufacturing, Light Industrial buildings near 42,200 SF
- Shorter term income from 7/8 tenants
- On "Lit San Leandro" www.litsanleandro.com

Location Aerial

