

FOR LEASE > INDUSTRIAL SPACE



Northeast Florida

Port Jax Trade Center, Bldg 400

2615 PORT INDUSTRIAL DR, JACKSONVILLE, FL 32226

BUILD-TO-SUIT & LEASING OPPORTUNITIES

Nominated
2014 NAIOP Developer of the Year!

Designated
Foreign Trade
Zone #64



- > 5,922± SF of dock high space with 1,377 sf of office area available for lease
- > Designated Foreign Trade Zone #64
- > Zoning: Industrial Heavy (IH)
- > Energy efficient buildings (LEED Conforming)
- > Quick access to I-295 and I-95 (multiple exits)

Additional Port Jax Trade Center Availabilities

- > Bldg. 700 - 15,592± SF contig. available in increments of 3,600± SF, grade level loading.
- > Bldg 300 - 11,844 SF of 1st generation dock high space
- > Stabilized and secured 3 acre parcel with utility connection available for lease \$1,800/acre/month
- > Bldg. 200 Build-To-Suit up to 81,000± SF (pad ready)

Just over 1 mile from
Jacksonville Port Authority at
Dames Point/Blount Island

- > Estimated pass through expenses \$1.58/SF
- > Lease Rate: **\$5.95/SF (NNN)**



BART HINSON
+1 904 358 1206 | EXT 1113
JACKSONVILLE, FL
bart.hinson@colliers.com

ROBERT SELTON, III
+1 904 358 1206 | EXT 1111
JACKSONVILLE, FL
robert.selton@colliers.com

COLLIERS INTERNATIONAL
NORTHEAST FLORIDA
50 N. Laura Street, Suite 1725
Jacksonville, FL
www.colliers.com/jacksonville

Space Summary Unit 404

2615 PORT INDUSTRIAL DR, BLDG 400, JACKSONVILLE, FL 32226

Available Size:	5,922± SF
Office Area Size:	1,377± SF
Office Buildout	Three private offices Large open work area, Reception area, One conference room
Parking:	Ample
Space Dimensions:	42'x 140'
Year Built:	2009
Truck Court Size	180' shared, all concrete court
Zoning:	Industrial Heavy (IH)
Clear Height:	Minimum 28'
Typical Column Space:	42'w x 48' 8"d
Doors:	2 dock high doors
Building Construction:	Tilt wall
Roof:	Metal standing seam
Floor Type:	Concrete
Utilities:	City water and city sewer via JEA
Electrical:	200amps 3 phase
Lighting:	T-5 and fluorescent
Fire Protection:	Wet system



Location Maps

2615 PORT INDUSTRIAL DR, BLDG 400, JACKSONVILLE, FL 32226

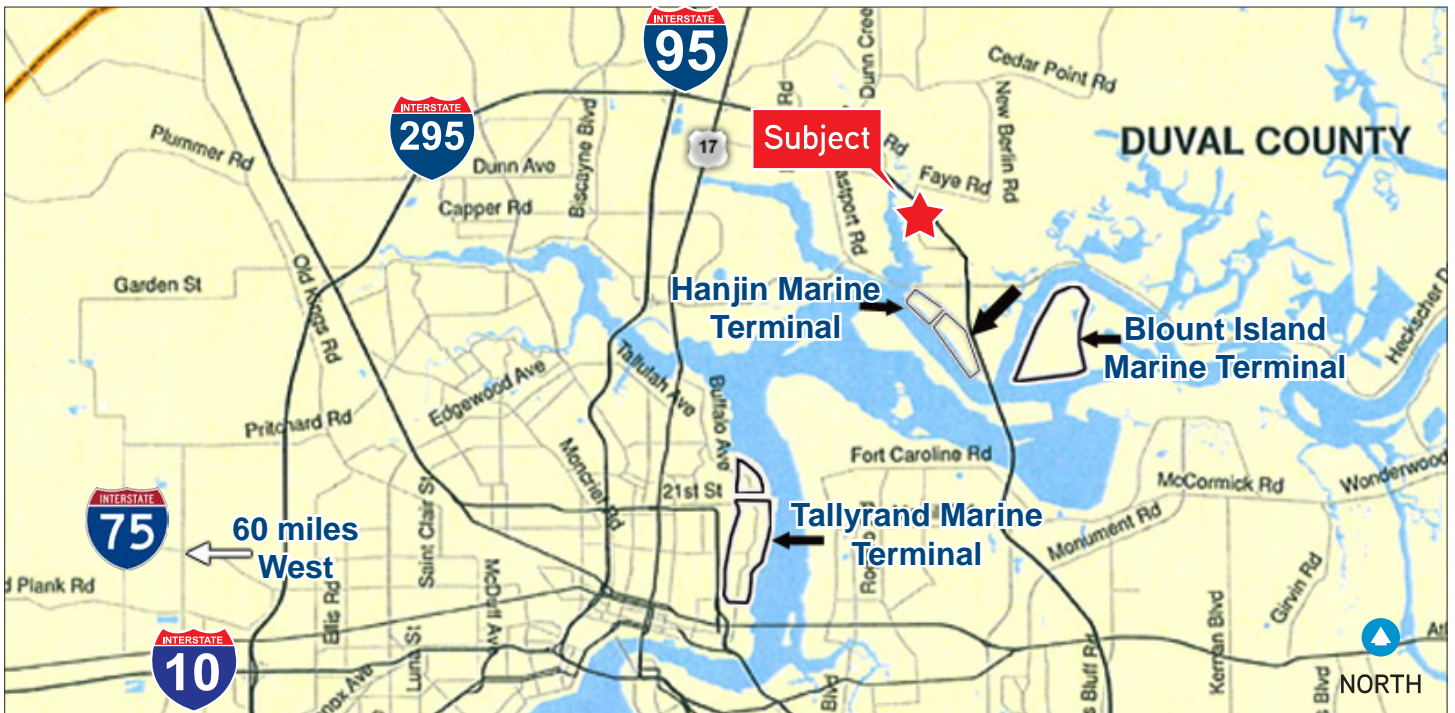
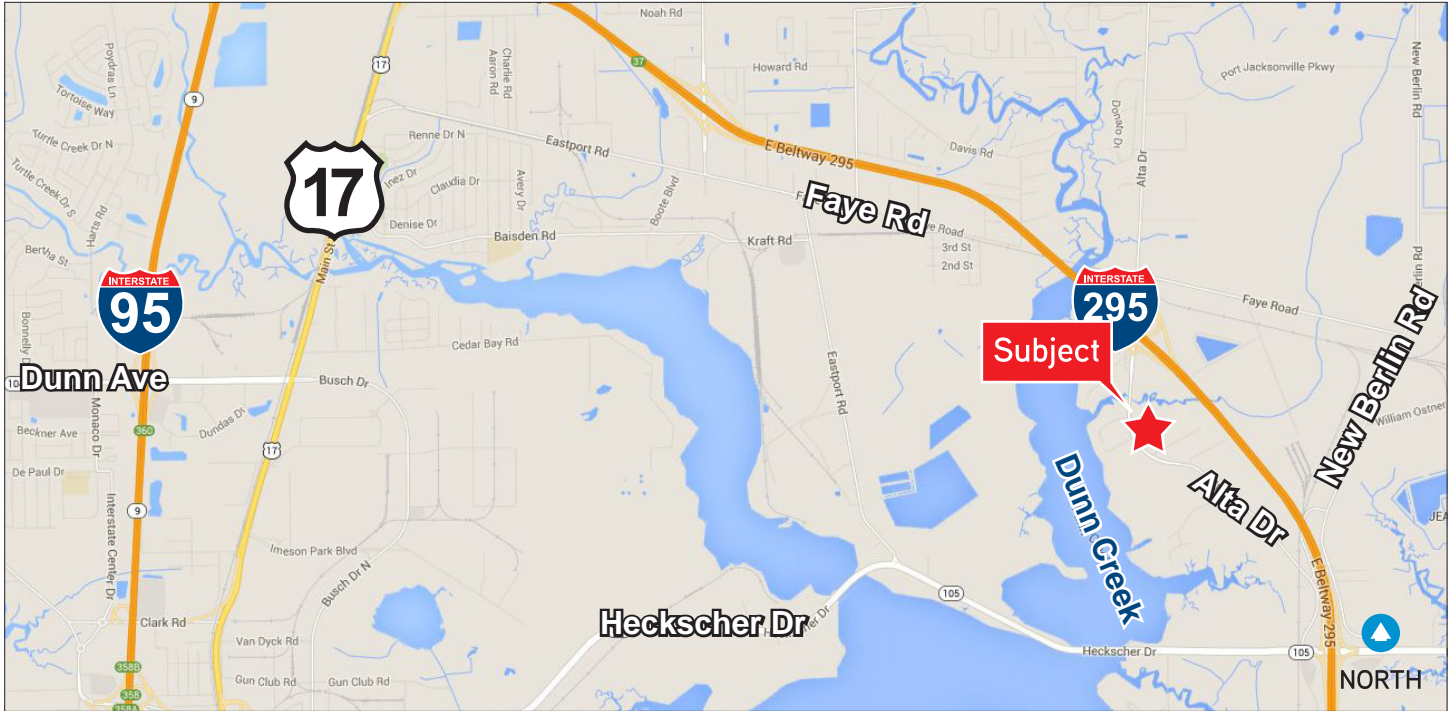

A map of Jacksonville, Florida, with 14 numbered locations marked. A red star and the word "Subject" are placed near location 1. The map includes major highways, parks, and the St. Johns River. A north arrow is in the top right corner.

1	I-295	0.6 mi	1 min	8	JAXPORT - Talleyrand Terminal	16.3 mi	17 min
2	I-95	5.7 mi	6 min	9	JAXPORT - Dames Point Terminal	3.0 mi	5 min
3	I-95 @ US 1	22.6 mi	22 min	10	JAXPORT - Blount Island Terminal	4.0 mi	6 min
4	I-10 @ I-95	16.1 mi	15 min	11	Orange Park	32.9 mi	31 min
5	I-10 @ I-295	20.0 mi	18 min	12	Town Center	14.1 mi	15 min
6	Jacksonville Int'l Airport	8.5 mi	10 min	13	Beaches	17.0 mi	22 min
7	Downtown Jacksonville	14.6 mi	18 min	14	World Golf Village	36.6 mi	33 min

3896

Strategic Location

2615 PORT INDUSTRIAL DR, BLDG 400, JACKSONVILLE, FL 32226

Strategic Location



FOR LEASE > INDUSTRIAL SPACE

Aerial of Site

2615 PORT INDUSTRIAL DR, BLDG 400, JACKSONVILLE, FL 32226



Photo taken October 2015

Building Specifications

2615 PORT INDUSTRIAL DR, BLDG 400, JACKSONVILLE, FL 32226

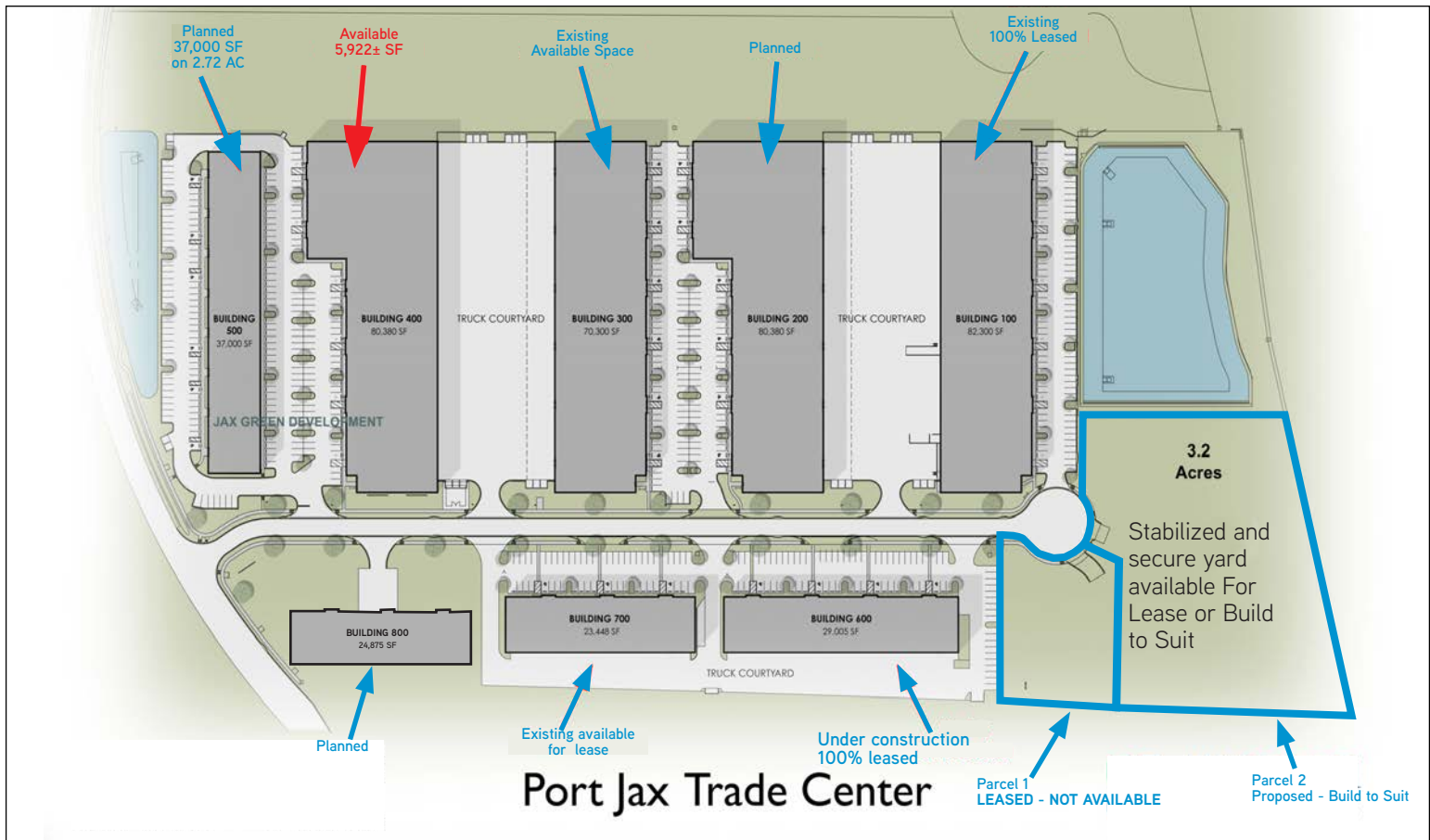

Building 100 (100% leased)*
Total Bldg Size: 82,245 SF

Building 200
Total Bldg Size: 80,380 SF
Minimum Bay Size: 5,922 SF
Maximum Contig Size: 80,380 SF
Typical Bay Dimensions: 42' x 140'
Clear Ceiling Height: 28'
Loading Doors Per Bay: 3 Dock

Building 300 (83% leased)
Total Bldg Size: 70,512 SF
Minimum Bay Size: 11,844 SF
Maximum Contig Size: 11,844 SF
Typical Bay Dimensions: 42' x 140'
Clear Ceiling Height: 28'
Loading Doors Per Bay: 3 Dock

Building 400 (93% leased)
Total Bldg Size: 80,666 SF
Contiguous SF Available: 5,922 SF
Bay Dimensions: 42' x 160'
Clear Ceiling Height: 28'
Dock Doors: 2 Dock

Building 500
Total Bldg Size: 37,000 SF
Minimum Bay Size: 3,200 SF
Typical Bay Dimensions: 40' x 80'
Clear Ceiling Height: 20'
Loading Doors Per Bay: 2 Grade

Building 600 (100% leased)
Total Bldg Size: 29,005 SF

Building 700 (34% leased)
Total Bldg Size: 23,448 SF
Minimum Bay Size: 3,600 SF
Typical Bay Dimensions: 45' x 80'
Clear Ceiling Height: 18' front & 16' rear
Loading Doors Per Bay: One 12'x12' grade

Building 800
Total Bldg Size: 24,875 SF
Minimum Bay Size: 3,600 SF
Typical Bay Dimensions: 45' x 80'
Clear Ceiling Height: 18' front & 16' rear
Loading Doors Per Bay: One 12'x12' grade

Parcel 1: (100% leased)
RBA/GLA: 0± SF
SF Avail: 0± SF
Lot Size: 1.0± acres

Parcel 2: For Lease or Proposed - Build to suit
RBA/GLA: 42,000± SF
SF Avail: 42,000± SF
Lot Size: 3.2± acres
Stabilized and secured yard

Building Plan

2615 PORT INDUSTRIAL DR, BLDG 400, JACKSONVILLE, FL 32226

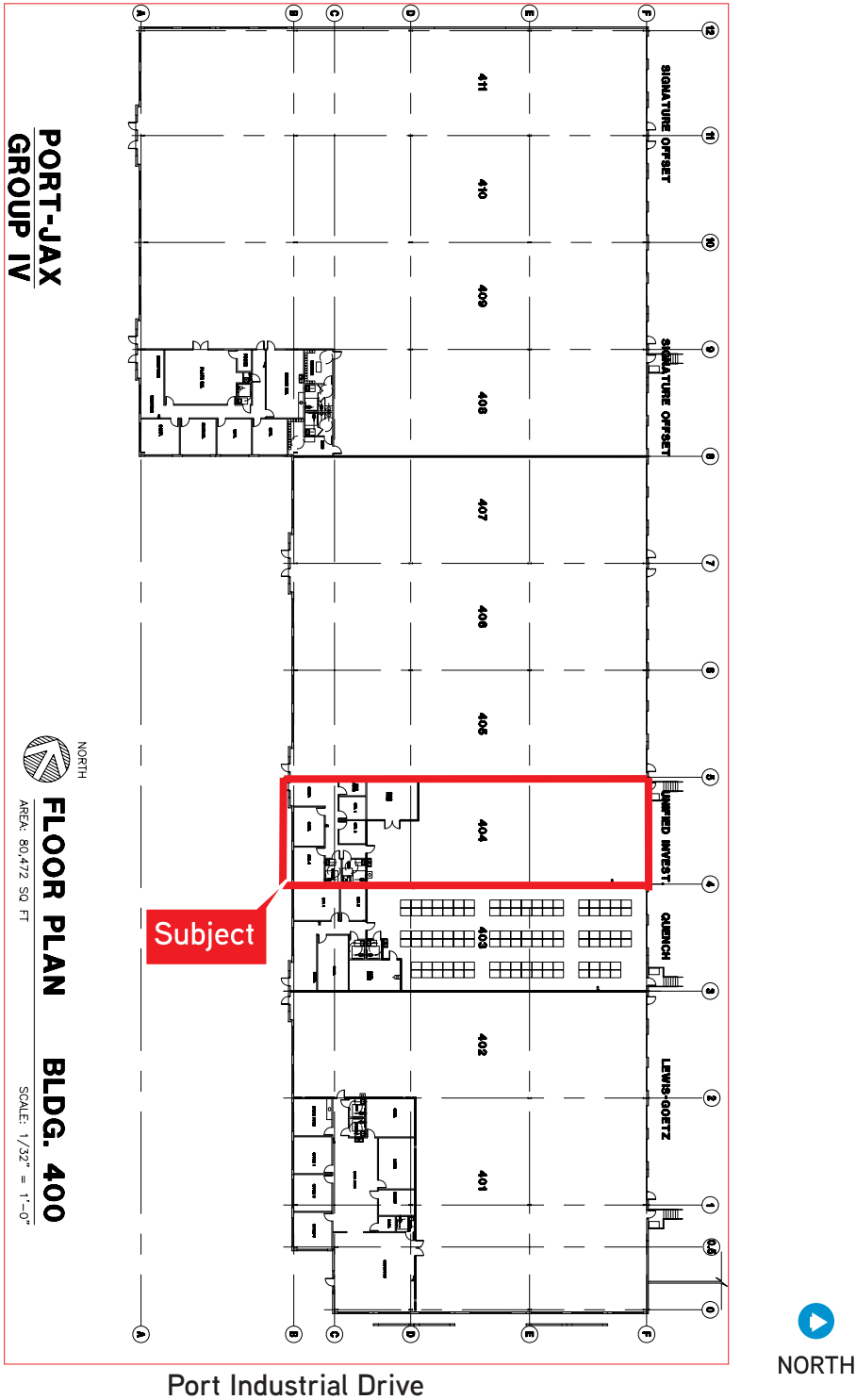

Space Plan - 404

2615 PORT INDUSTRIAL DR, BLDG 400, JACKSONVILLE, FL 32226

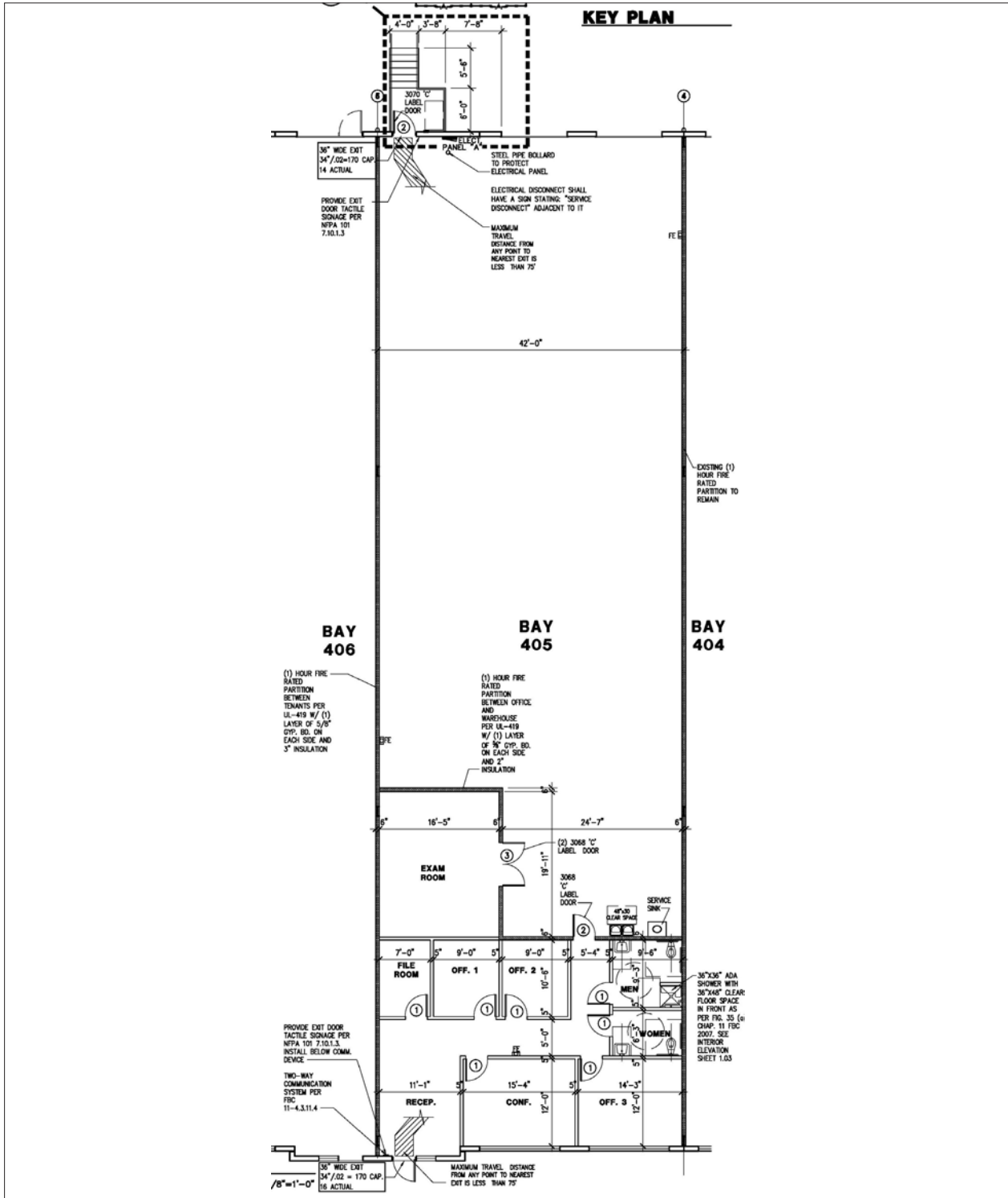

Foreign Trade Zone Benefits

2615 PORT INDUSTRIAL DR, BLDG 400, JACKSONVILLE, FL 32226

Businesses can efficiently manage cash flow and save money on international cargo shipments or manufacturing and distribution operations by using Jacksonville's Foreign Trade Zone (FTZ) #64. FDi Magazine recently ranked FTZ #64 the third best port zone in the world.

A Foreign Trade Zone, or FTZ, is a secured site within the United States, but technically considered outside of U.S. Custom's jurisdiction. By streamlining customs clearance, foreign trade zones help importers, exporters and manufacturers operate more efficiently. Locating a production or operating facility within a foreign trade zone can benefit businesses by:

- Exempting tariffs on re-exports;
- Paying U.S. Customs duties only when goods are transferred out of the FTZ and into the United States (no duties on zone-to-zone transfers);
- Managing merchandise subject to quotas; and
- Exempting duties on merchandise that becomes waste, defective or damaged while in the zone.

Foreign Trade Zone #64 comprises several locations in the city, including hundreds of acres of property at JAXPORT's three terminals and cold storage facilities at the Talleyrand Marine Terminal. FTZ #64 also covers several industrial parks and the Jacksonville Airport Authority's Jacksonville International Airport (JIA). For more information about FTZ #64, call the Zone Administrator at (800) 874-8050 or (904) 357-3072.

For More Information:

National Association of Foreign Trade Zones

naftz.org

U.S. Foreign Trade Zone Board

la.ita.doc.gov/ftzpage

U.S. Customs and Boarder Protection

cbp.gov

International trade Administration

trade.gov

* Source: JAXPORT 2011 Directory, P.23

FOR SALE OR LEASE > INDUSTRIAL PROPERTY

LEASING & BUILD-TO-SUIT OPPORTUNITIES

2615 PORT INDUSTRIAL DR, BLDG 400, JACKSONVILLE, FL 32226



Contact Us

BART HINSON
+1 904 358 1206 | EXT 1113
JACKSONVILLE, FL
bart.hinson@colliers.com

ROBERT SELTON, III
+1 904 358 1206 | EXT 1111
JACKSONVILLE, FL
robert.selton@colliers.com

Please contact us to see this property

COLLIERS INTERNATIONAL
NORTHEAST FLORIDA
50 N. Laura Street, Suite 1725
Jacksonville, FL
www.colliers.com/jacksonville