

REDUCED PRICE > \$5,800,000



FOR SALE > 406,027± SF > FORMER SOUTHWIRE BUILDING

2412 Hwy 169 > <http://www.colliers.com/2412hwy169>

COFFEYVILLE, KANSAS

AGENT: DOUG HEDRICK SIOR, CCIM
+1 816 556 1136
KANSAS CITY, MO
doug.hedrick@colliers.com

Accelerating success.





Building Features

Total Building Area:	406,027± SF <ul style="list-style-type: none">> Production: 306,350± SF> Warehouse: 91,400± SF> Office: 7,500± SF> Break Area / Locker Rooms: 5,615± SF
Acreage:	30.80 total acres
Electrical:	Coffeyville Light & Power - 12,500 Volt power stepped to 277 / 480 v, 3-phase - redundant loop system
Ceiling Height:	Production: 22' - 36'4" Warehouse: 34' - 38'5"
Column Spacing:	Production: 25' x 50' Warehouse: 36' x 50'
Loading:	Production: <ul style="list-style-type: none">> 4 dock doors 9' x 10'> 2 drive-in doors 10' x 14'> 3 rail doors Warehouse: <ul style="list-style-type: none">> 14 dock doors 8' x 10'> 1 drive-in door 10' x 14'
Dock Equipment:	Fully equipped with 25,000 lb pit levelers
Dock Locks:	Dok Lok System
Dock Lights:	Versa Light System
Rail Served:	SKOL / WATCO
Fire Suppression:	Wet sprinkler system
Floor Thickness:	Production: 5" P.T. slab Warehouse: 9" P.T. slab



Building Features CONTINUED

Water	City of Coffeyville - 6" Main at 69 psi
Gas:	ATMOS - 2" Main at 29 psi
Sewer:	City of Coffeyville
Year Built:	1995
Data/Voice/Fiber:	T3
Current Zoning:	Industrial
Car Parking:	283
Outside/Trailer Storage:	Yes
Nearest International Airport:	Tulsa International - 71 miles
Sale Price:	\$6,100,000 \$5,800,000 (\$14.28 PSF)
Real Estate Tax:	2014: \$281,784 (\$0.69 PSF)
Other:	<ul style="list-style-type: none">➤ Located in Coffeyville Industrial Park➤ Direct rail to Tulsa Port of Catoosa; Port of Catoosa is one of the largest inland river ports in the United States➤ Montgomery County is the industrial hub of Southeast Kansas➤ Possible Foreign Trade Zone (FTZ) status

Economic Development Incentive Contacts:

State:	Kansas Department of Commerce Steve Kelly, Deputy Secretary Email: skelly@kansascommerce.com Phone: +1 785 296 5298
Regional:	Montgomery County Action Council Aaron Heckman, Executive Director Email: aheckman@actioncouncil.com Phone: +1 620 331 3830
Local:	City of Coffeyville Trisha Purdon, Assistant to the City Manager Email: tpurdon@coffeyville.com Phone: +1 620 252 6171



Aerial ▾

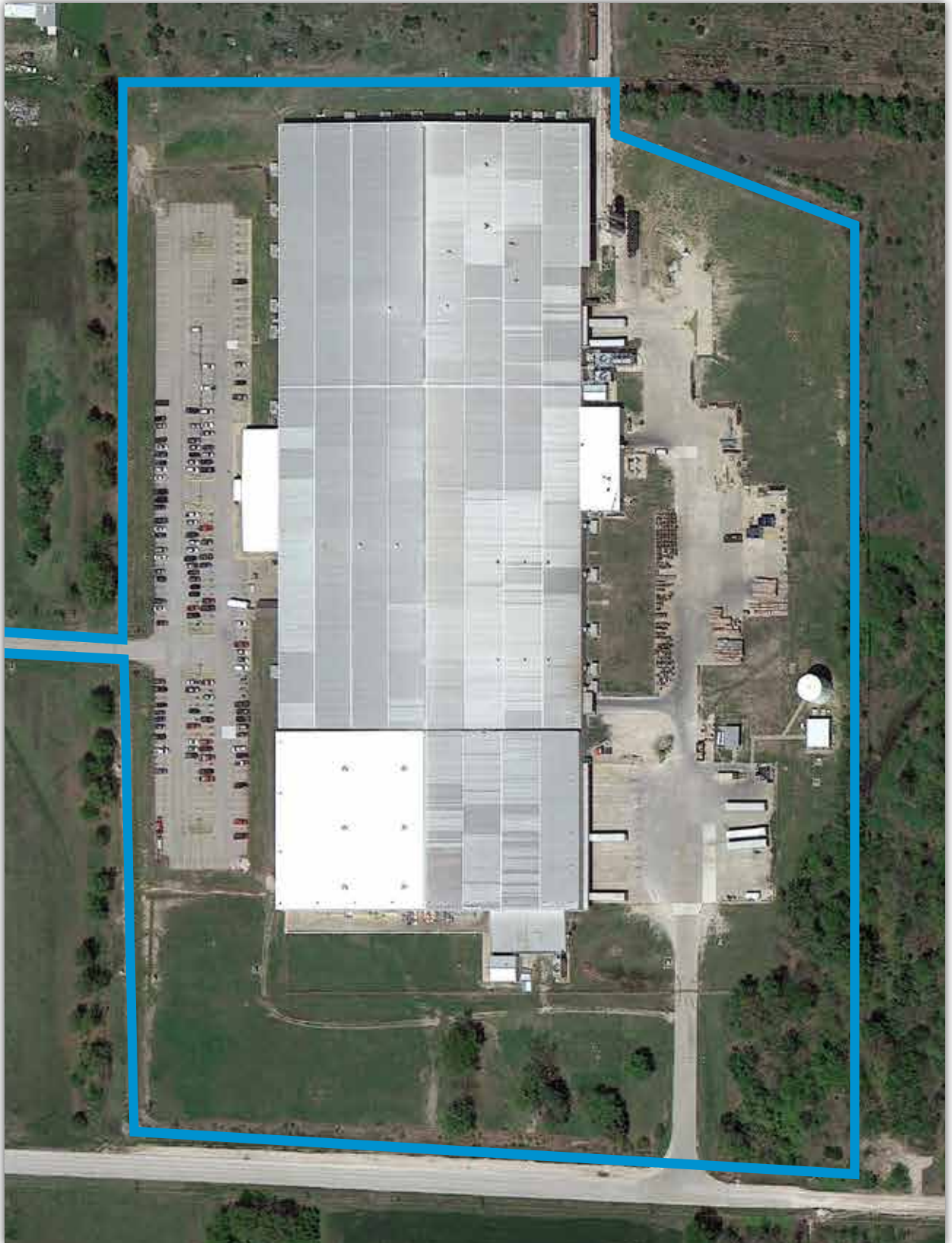

Floor Plan

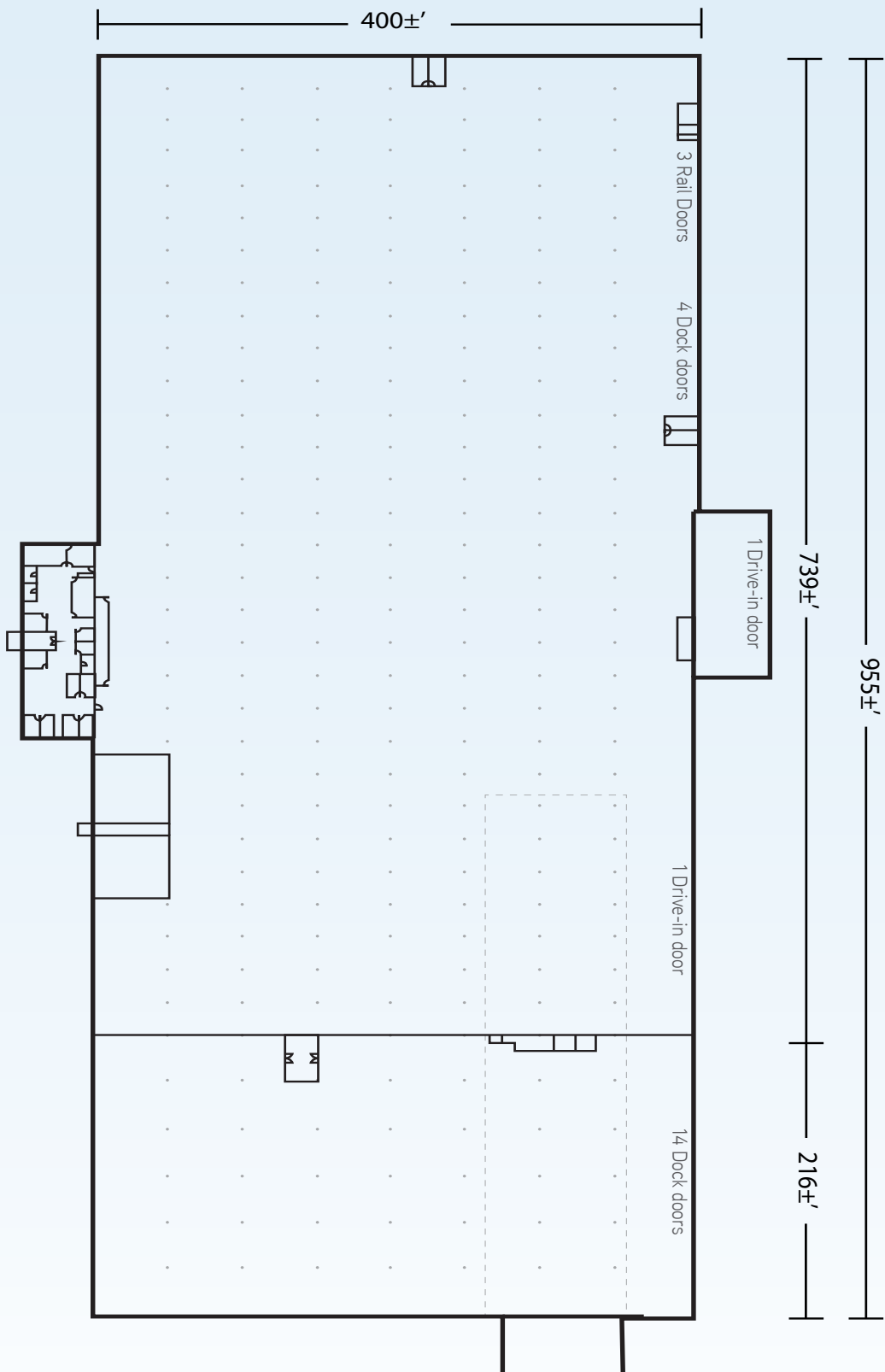



BUSINESS CLIMATE:

Corporate Income Tax: 7% - Kansas has no income tax for LLC's, Subchapter-S Corporations, Partnerships, LLP's and Sole Proprietorships

State Sales Tax: 6.15%

Local Sales Tax: 3%

Inventory or Franchise Tax: None

Local Income Tax: None

Property Tax on Machinery and Equipment: None

LOCAL WORKFORCE:

- > Over 1,000 workers available due to recent industrial closures in the community
- > 4,455 registered jobseekers in Montgomery County and the five adjoining counties
 - > 1,416 identify with manufacturing experience
 - > 304 with transportation and distribution
 - > 357 with construction trades

- > Per the 2012 Economic Census, Montgomery County had manufacturing output of \$6.1 billion dollars, ranking 4th highest in the state
- > The manufacturing sector employs 3,468 individuals with an annual payroll of \$196 million dollars

DEMOGRAPHICS / WORKFORCE:

Population: City of Coffeyville: 10,295
Montgomery County: 35,471

Annual per Capita Income: \$21,332 (Montgomery County)

Average Annual Manufacturing Worker Wage: \$51,336 (2012 Census)

Unemployment Rate: 4.9%

Cost of Living Index: 91.3 (6th lowest in the U.S.)

Labor Shed: 1 Hour Population - 78,000

Right to Work State: Yes

Training Programs Available: Yes. Several programs offered by local community colleges

Community Colleges in County: Two (2); Coffeyville Community College and Independence Community College



United States Location Map



Regional Location Map

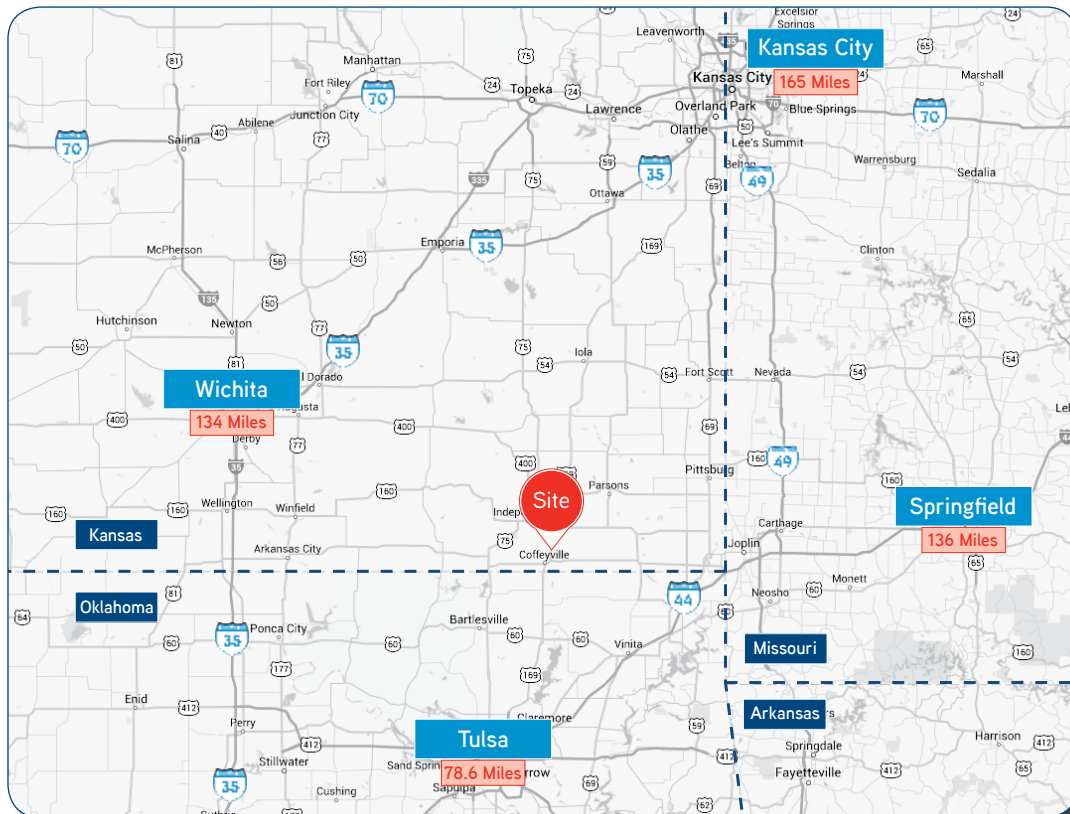

CONTACT DETAILS

DOUG HEDRICK SIOR, CCIM
doug.hedrick@colliers.com
DIR +1 816 556 1136
FAX +1 816 531 5409

Colliers International
4520 Main Street
Suite 1000
Kansas City, MO 64111

www.colliers.com

This document has been prepared by Colliers International for advertising and general information only. Colliers International makes no guarantees, representations or warranties of any kind, expressed or implied, regarding the information including, but not limited to, warranties of content, accuracy and reliability. Any interested party should undertake their own inquiries as to the accuracy of the information. Colliers International excludes unequivocally all inferred or implied terms, conditions and warranties arising out of this document and excludes all liability for loss and damages arising there from. This publication is the copyrighted property of Colliers International and/or its licensor(s). © 2017. All rights reserved.

