

FOR LEASE > OFFICE > WAREHOUSE > SHOWROOM

4300, 4400, 4600 ASHE ROAD, BAKERSFIELD, CA 93313

ASHE ROAD BUSINESS CENTER



WESLEY MCDONALD  
661 631 3828  
LICENSE NUMBER 01511739  
wesley.mcdonald@colliers.com

CAMERON MAHONEY  
661 631 3814  
LICENSE NUMBER 01937802  
cameron.mahoney@colliers.com

COLLIERS INTERNATIONAL  
10000 Stockdale Highway, Suite 102  
Bakersfield, CA 93311  
www.colliers.com/bakersfield





# OFFICE > WAREHOUSE > SHOWROOM

## PROPERTY INFORMATION

4300, 4400, 4600 Ashe Road, Bakersfield, CA 93301

### LOCATION

The subject property is located on the northeast corner of Ashe Road and District Boulevard in the heart of the Stockdale Industrial Park in Southwest Bakersfield, California. This location provides easy access to Freeway 99, linking Los Angeles to the south and Fresno to the north.

### DESCRIPTION

- > Stockdale Industrial Park is a Multi-Tenant Business/Industrial Park
- > M-2 City of Bakersfield Zoning
- > 4.90 Acre Lot
- > APN #384-381-02
- > Concrete Tilt-Up Construction
- > High Visibility and Frontage on both Ashe Road and District Boulevard.
- > 12' x 14' Roll-Up Doors - Available in Most Units
- > Separate Utilities
- > Professional Property Management

### UTILITIES

- > Water: California Water Company
- > Electric: Pacific Gas & Electric
- > Power: 120/208 Volt / 100 Amp / 3 Phase
- > Gas: Pacific Gas & Electric



4400, 4

WESLEY MCDONALD  
661 631 3828  
LICENSE NUMBER 01511739  
[wesley.mcdonald@colliers.com](mailto:wesley.mcdonald@colliers.com)

CAMERON MAHONEY  
661 631 3814  
LICENSE NUMBER 01937802  
[cameron.mahoney@colliers.com](mailto:cameron.mahoney@colliers.com)

COLLIERS INTERNATIONAL  
10000 Stockdale Highway, Suite 102  
Bakersfield, CA 93311  
[www.colliers.com/bakersfield](http://www.colliers.com/bakersfield)



# OFFICE > WAREHOUSE > SHOWROOM FLOOR PLANS OF AVAILABLE SUITES

4300, 4400, 4600 Ashe Road, Bakersfield, CA 93301

WAREHOUSE SPACE  
SUITE 113 - 1,164 s.f

RR

RECEPTION

FLOOR PLANS  
NOT TO SCALE



WESLEY MCDONALD  
661 631 3828  
LICENSE NUMBER 01511739  
[wesley.mcdonald@colliers.com](mailto:wesley.mcdonald@colliers.com)

CAMERON MAHONEY  
661 631 3814  
LICENSE NUMBER 01937802  
[cameron.mahoney@colliers.com](mailto:cameron.mahoney@colliers.com)

COLLIERS INTERNATIONAL  
10000 Stockdale Highway, Suite 102  
Bakersfield, CA 93311  
[www.colliers.com/bakersfield](http://www.colliers.com/bakersfield)



# OFFICE > WAREHOUSE > SHOWROOM SITE PLAN > AVAILABLE SUITES > LEASE RATES

4300, 4400, 4600 Ashe Road, Bakersfield, CA 93301

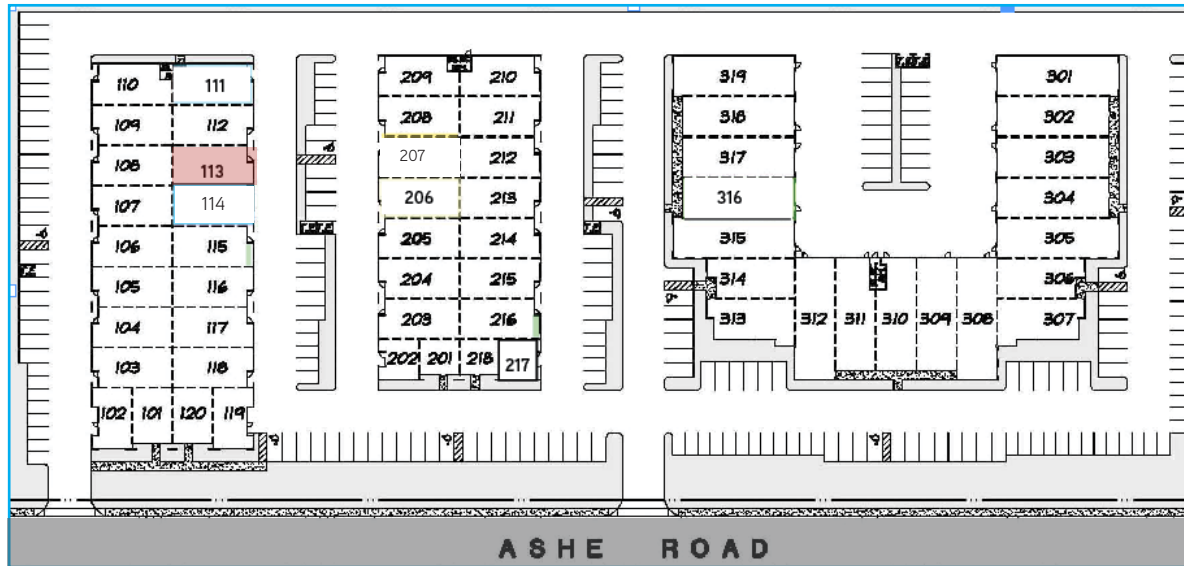

## AVAILABLE

SUITE 113 (1)

## SQ. FT.

1,164 s.f.

## LEASE RATES

\$ 850.00/month

(1) This warehouse does not have HVAC

WESLEY MCDONALD

661 631 3828

LICENSE NUMBER 01511739

[wesley.mcdonald@colliers.com](mailto:wesley.mcdonald@colliers.com)

CAMERON MAHONEY

661 631 3814

LICENSE NUMBER 01937802

[cameron.mahoney@colliers.com](mailto:cameron.mahoney@colliers.com)

COLLIERS INTERNATIONAL  
10000 Stockdale Highway, Suite 102  
Bakersfield, CA 93311  
[www.colliers.com/bakersfield](http://www.colliers.com/bakersfield)





# OFFICE > WAREHOUSE > SHOWROOM

## AERIAL MAP / LOCATION MAP

4300, 4400, 4600 Ashe Road, Bakersfield, CA 93301

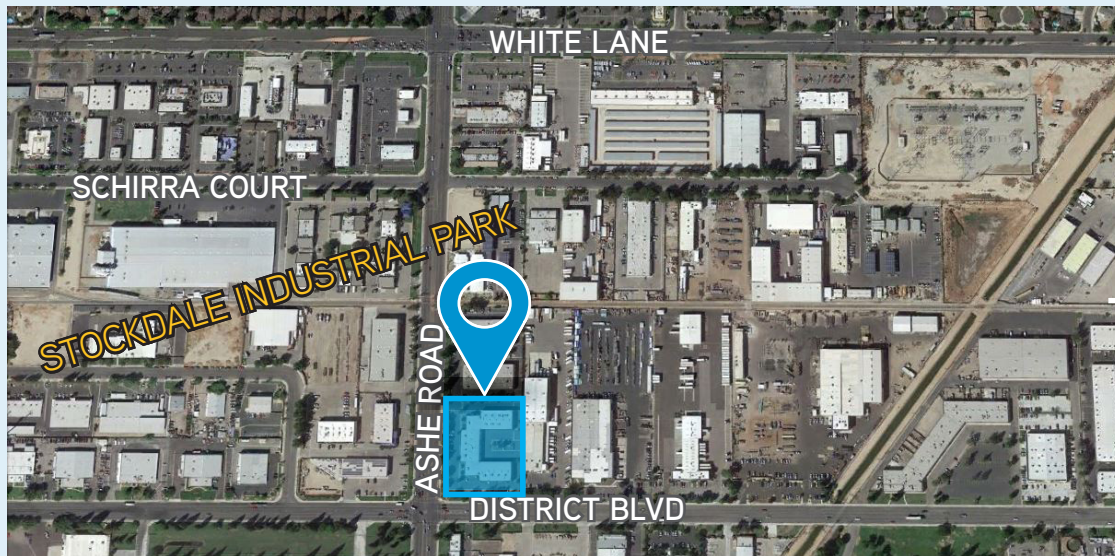

### CONTACT US:

WESLEY M. MCDONALD  
SENIOR VICE PRESIDENT | PRINCIPAL  
CENTRAL CALIFORNIA  
661 631 3828  
LICENSE NUMBER: 01511739  
[wesley.mcdonald@colliers.com](mailto:wesley.mcdonald@colliers.com)

CAMERON MAHONEY  
ASSOCIATE  
CENTRAL CALIFORNIA  
661 631 3814  
LICENSE NUMBER: 01937802  
[cameron.mahoney@colliers.com](mailto:cameron.mahoney@colliers.com)

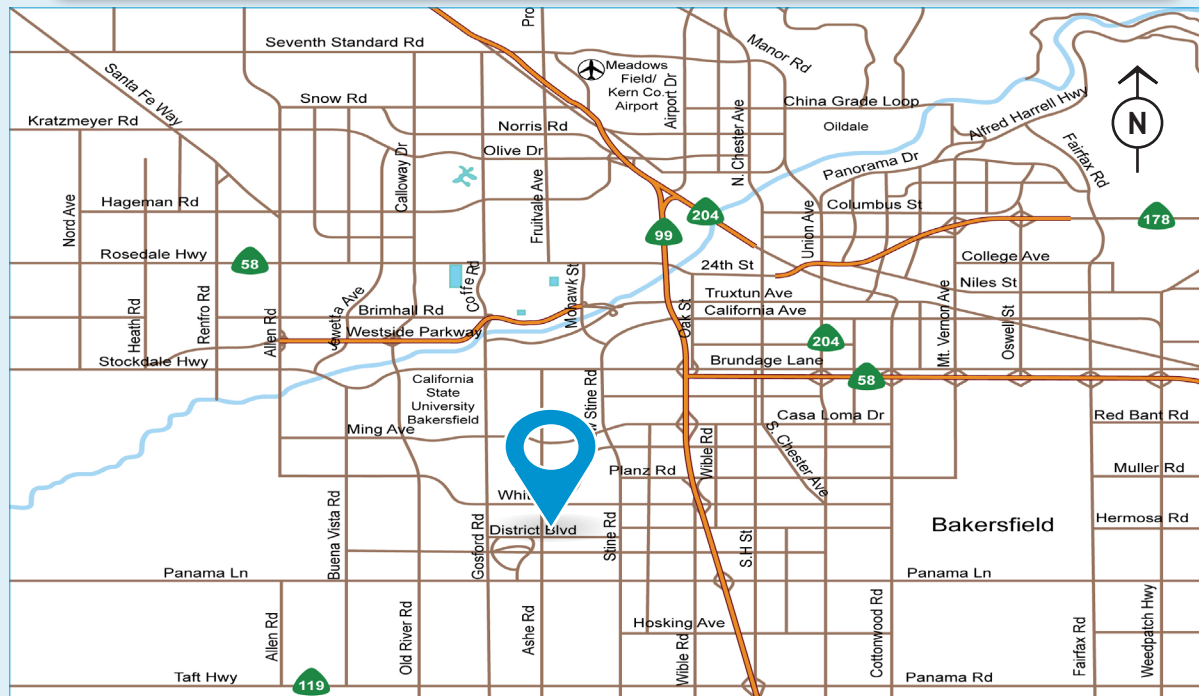

COLLIERS INTERNATIONAL  
10000 Stockdale Highway, Suite 102  
Bakersfield, CA 93311  
[www.colliers.com/bakersfield](http://www.colliers.com/bakersfield)



This document has been prepared by Colliers International for advertising and general information only. Colliers International makes no guarantees, representations or warranties of any kind, expressed or implied, regarding the information including, but not limited to, warranties of content, accuracy and reliability. Any interested party should undertake their own inquiries as to the accuracy of the information. Colliers International excludes unequivocally all inferred or implied terms, conditions and warranties arising out of this document and excludes all liability for loss and damages arising there from. This publication is the copyrighted property of Colliers International and/or its licensor(s). ©2017. All rights reserved.