

LEASING > CORNER RETAIL BUILDING

# 6001 ROSEMEAD BLVD

SWC ROSEMEAD BLVD & MINES AVE | PICO RIVERA, CA



RETAIL FORESIGHT



## Availability

**BLDG SIZE:** ±1,334 SF

**RATE:** Negotiable

## Traffic Counts

**ROSEMEAD & MINES:** ±39,500 CPD (CoStar 2012)



## Highlights

- > Freestanding retail building located within established center
- > Excellent visibility on signalized corner location
- > Located on major north / south thoroughfare: Rosemead Boulevard
- > Abundant on-site parking
- > Prominent building signage
- > Strong demographics with over 197,771 residents within 3 miles, average income over \$60,000, and over 56,000 households
- > Center tenants include: dd's Discounts & Chuck E. Cheese's

FOR FURTHER INFORMATION PLEASE CALL: +1 323 609 3172

### JAMES RODRIGUEZ

SR. VICE PRES. | LIC. NO. 01164377  
james.rodriquez@colliers.com

### MICHAEL BOHORQUEZ

VICE PRESIDENT | LIC. NO. 01870842  
michael.bohorquez@colliers.com

COLLIERS INTERNATIONAL | DOWNTOWN LA

865 S. Figueroa St., Suite 3500 | Los Angeles, CA 90017  
[www.Retail-Foresight.com](http://www.Retail-Foresight.com)

Colliers International makes no guarantees, representations or warranties of any kind, expressed or implied, regarding the information including, but not limited to, warranties of content, accuracy and reliability. This publication is the copyrighted property of Colliers International and /or its licensor(s). 2015. All rights reserved.

# 6001 ROSEMEAD BLVD

SWC ROSEMEAD BLVD & MINES AVE | PICO RIVERA, CA



RETAIL FORESIGHT

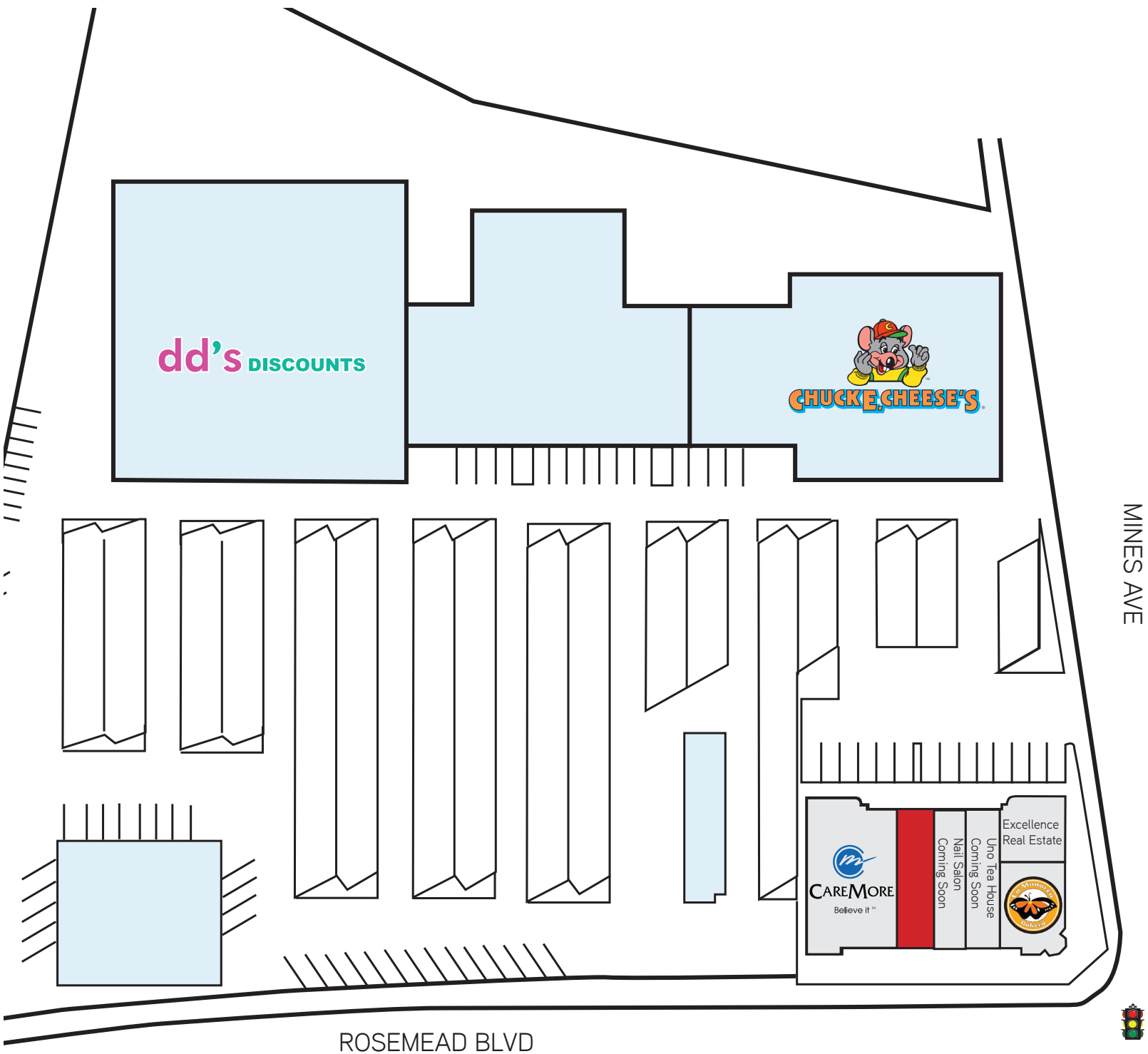

MINES AVE

ROSEMEAD BLVD



FOR FURTHER INFORMATION PLEASE CALL: +1 323 609 3172

## JAMES RODRIGUEZ

SR. VICE PRES. | LIC. NO. 01164377  
james.rodriguez@colliers.com

## MICHAEL BOHORQUEZ

VICE PRESIDENT | LIC. NO. 01870842  
michael.bohorquez@colliers.com

COLLIERS INTERNATIONAL | DOWNTOWN LA

865 S. Figueroa St., Suite 3500 | Los Angeles, CA 90017  
[www.Retail-Foresight.com](http://www.Retail-Foresight.com)

# 6001 ROSEMEAD BLVD

SWC ROSEMEAD BLVD & MINES AVE | PICO RIVERA, CA



RETAIL FORESIGHT

## FLOOR PLAN

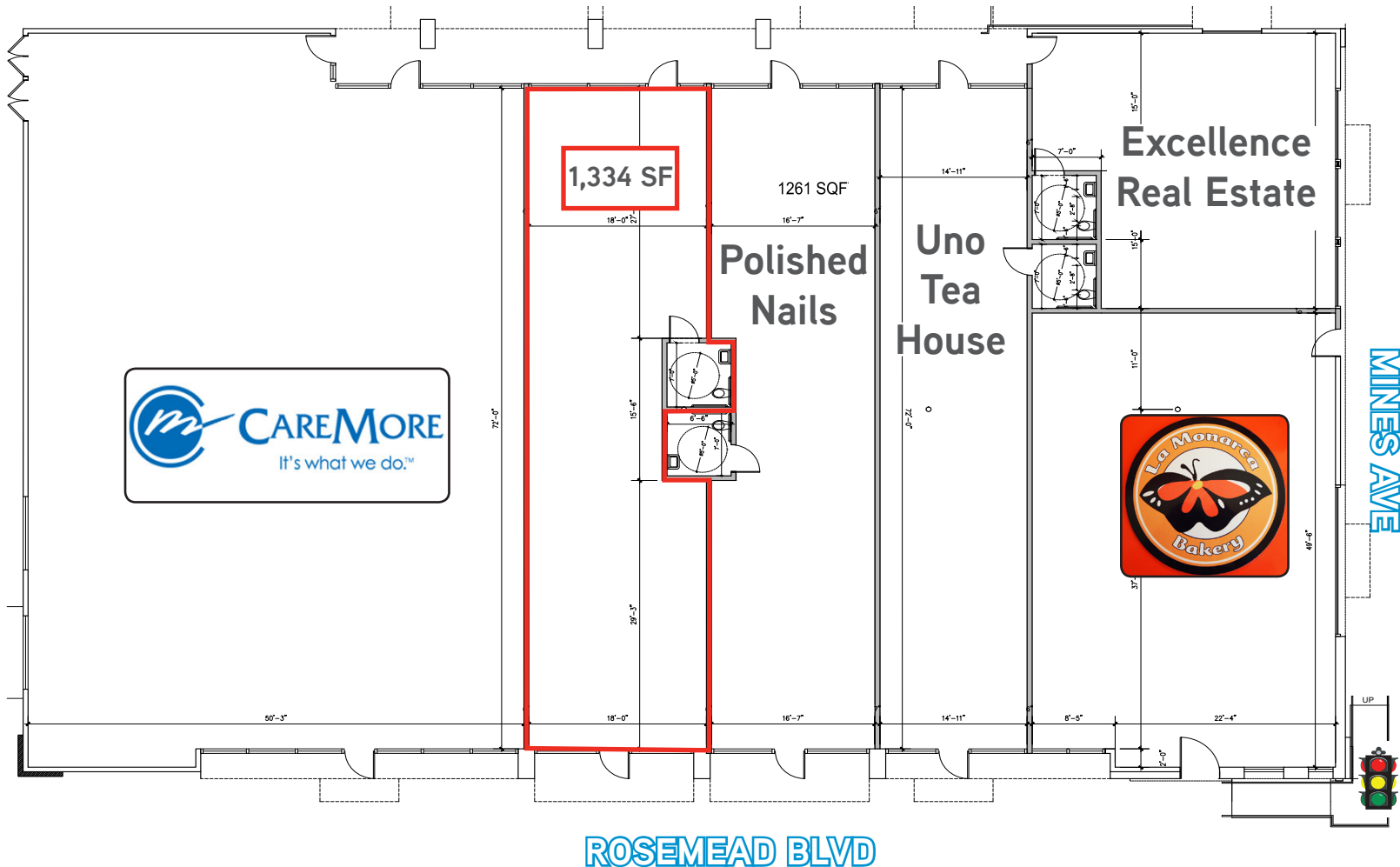

FOR FURTHER INFORMATION PLEASE CALL: +1 323 609 3172

### JAMES RODRIGUEZ

SR. VICE PRES. | LIC. NO. 01164377  
james.rodriquez@colliers.com

### MICHAEL BOHORQUEZ

VICE PRESIDENT | LIC. NO. 01870842  
michael.bohorquez@colliers.com

COLLIERS INTERNATIONAL | DOWNTOWN LA

865 S. Figueroa St., Suite 3500 | Los Angeles, CA 90017  
[www.Retail-Foresight.com](http://www.Retail-Foresight.com)



# 6001 ROSEMEAD BLVD

SWC ROSEMEAD BLVD &amp; MINES AVE | PICO RIVERA, CA



RETAIL FORESIGHT

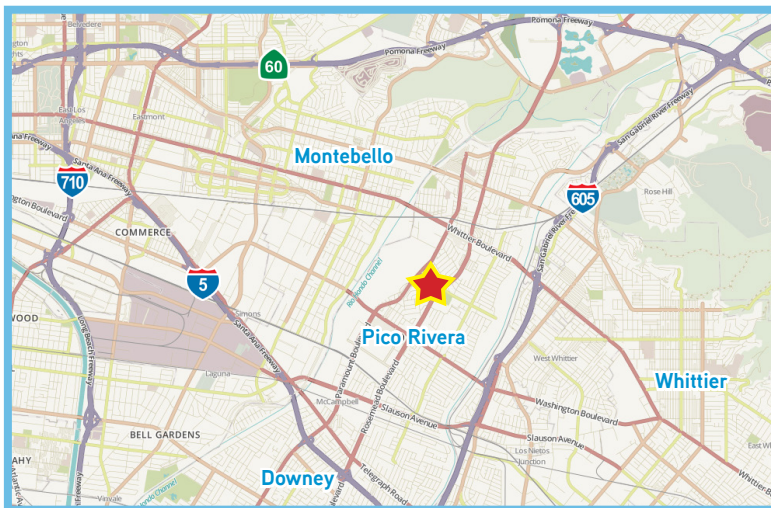
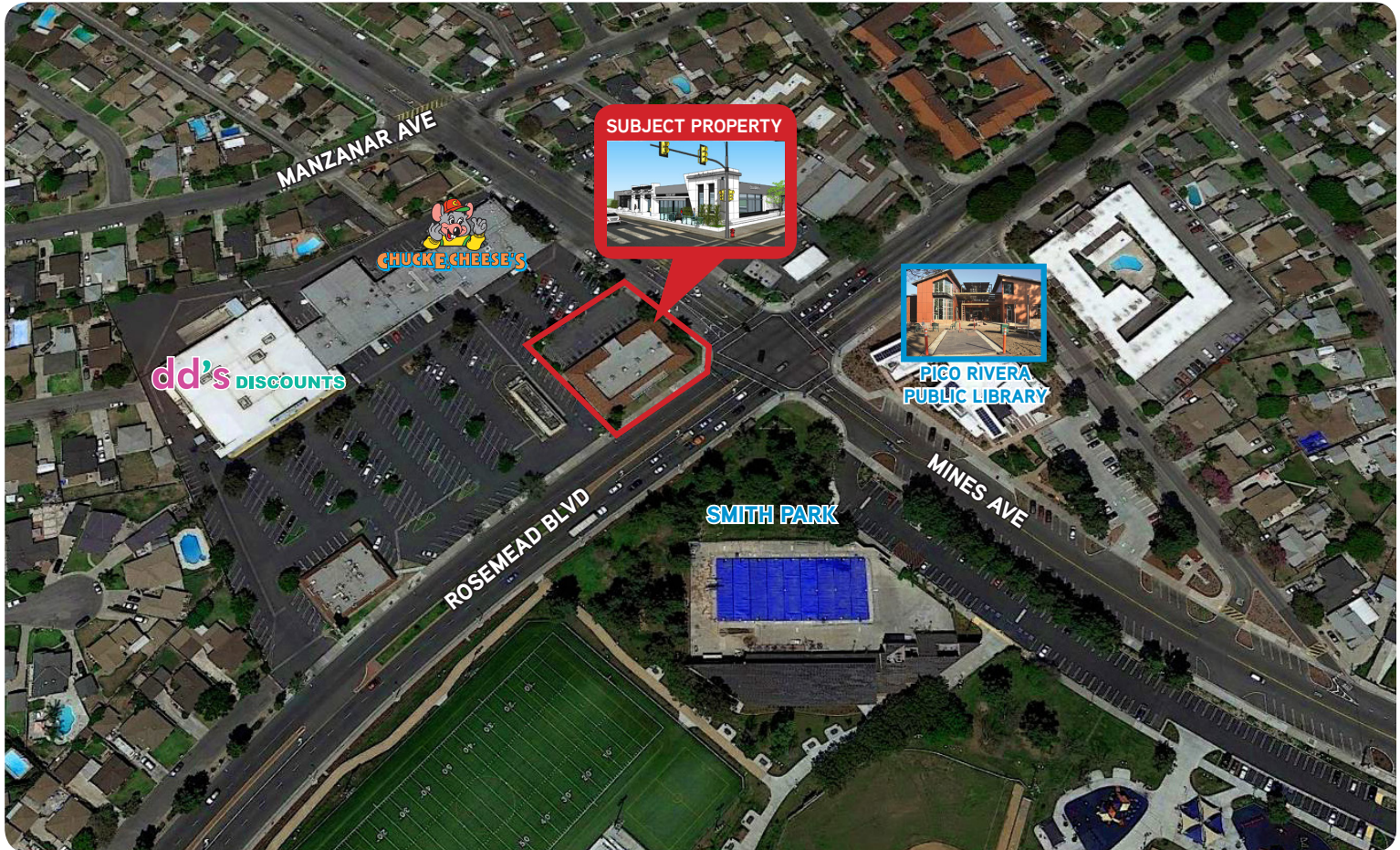

2014 DEMOGRAPHICS	1 Mile	3 Mile	5 Mile
Population:	22,578	197,771	534,107
Households:	6,021	56,039	151,117
Hispanic Population:	92.2%	85.9%	79.2%
Avg. HH Income:	\$61,041	\$65,733	64,975
Daytime Population:	6,073	89,032	242,796

Source: Claritas

**FOR FURTHER INFORMATION PLEASE CALL: +1 323 609 3172****JAMES RODRIGUEZ**SR. VICE PRES. | LIC. NO. 01164377  
james.rodriquez@colliers.com**MICHAEL BOHORQUEZ**VICE PRESIDENT | LIC. NO. 01870842  
michael.bohorquez@colliers.com

COLLIERS INTERNATIONAL | DOWNTOWN LA

865 S. Figueroa St., Suite 3500 | Los Angeles, CA 90017  
[www.Retail-Foresight.com](http://www.Retail-Foresight.com)