

Site Map

9400 W Broadway, BP 55445
 9248 W Broadway Ave, Brooklyn Park, Minnesota, 55445
 Rings: 1, 3, 5 mile radii

Colliers International
 Latitude: 45.1233
 Longitude: -93.3767

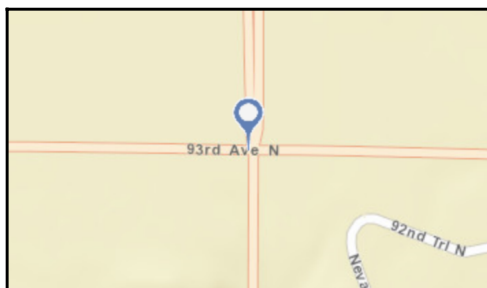
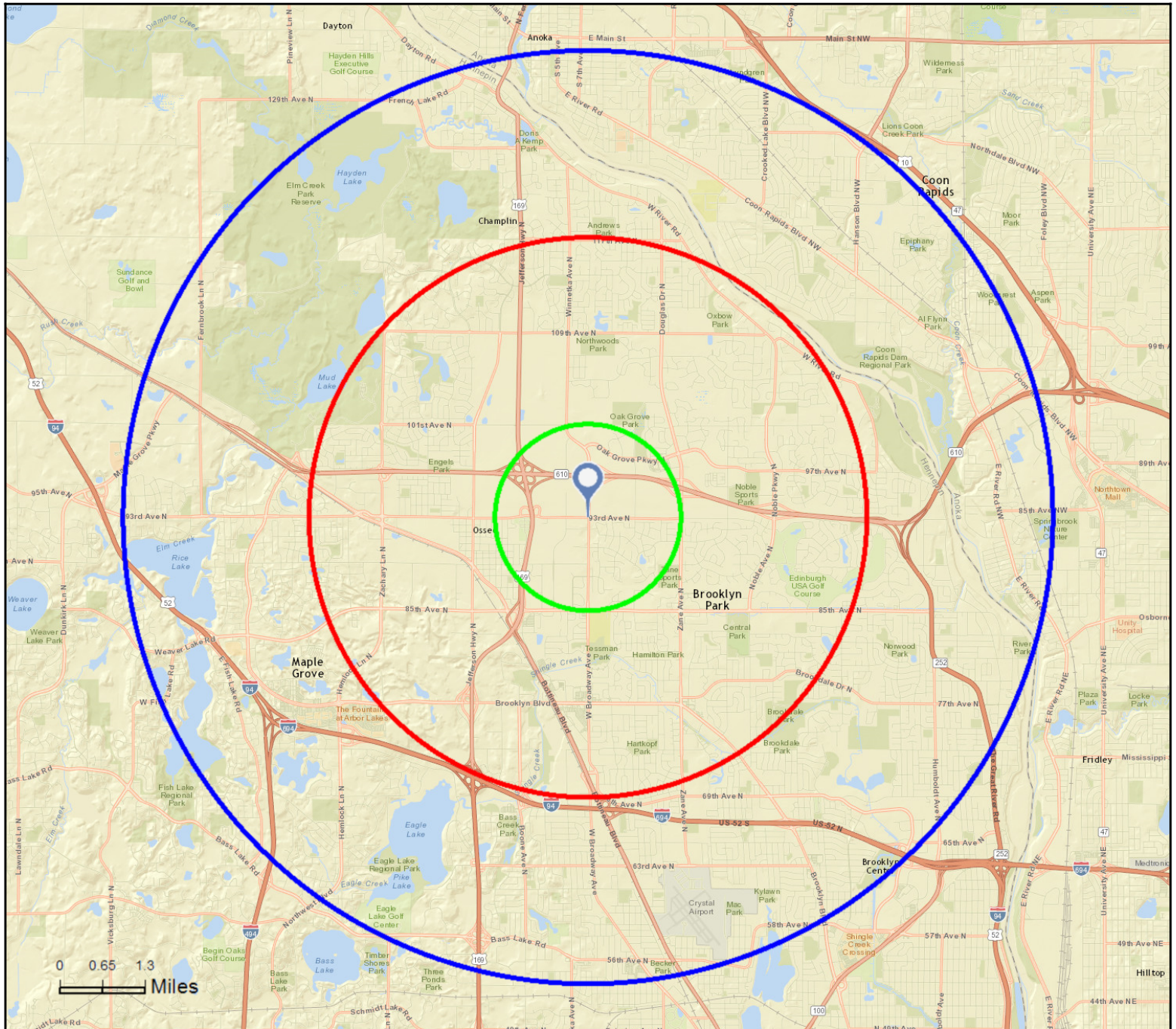

Executive Summary

9400 W Broadway, BP 55445
9248 W Broadway Ave, Brooklyn Park, Minnesota, 55445
Rings: 1, 3, 5 mile radii

Colliers International
Latitude: 45.12330
Longitude: -93.37670

	1 mile	3 miles	5 miles
Population			
2000 Population	4,096	63,579	189,820
2010 Population	4,912	71,111	197,251
2016 Population	5,577	76,600	208,928
2021 Population	6,151	81,255	219,284
2000-2010 Annual Rate	1.83%	1.13%	0.38%
2010-2016 Annual Rate	2.05%	1.20%	0.92%
2016-2021 Annual Rate	1.98%	1.19%	0.97%
2016 Male Population	49.1%	49.0%	48.6%
2016 Female Population	50.9%	51.0%	51.4%
2016 Median Age	35.4	35.0	36.4

In the identified area, the current year population is 208,928. In 2010, the Census count in the area was 197,251. The rate of change since 2010 was 0.92% annually. The five-year projection for the population in the area is 219,284 representing a change of 0.97% annually from 2016 to 2021. Currently, the population is 48.6% male and 51.4% female.

Median Age

The median age in this area is 35.4, compared to U.S. median age of 38.0.

Race and Ethnicity

2016 White Alone	55.0%	61.0%	66.1%
2016 Black Alone	15.2%	19.1%	16.4%
2016 American Indian/Alaska Native Alone	0.3%	0.4%	0.5%
2016 Asian Alone	25.1%	13.9%	10.7%
2016 Pacific Islander Alone	0.0%	0.1%	0.0%
2016 Other Race	1.6%	2.2%	2.6%
2016 Two or More Races	2.9%	3.4%	3.6%
2016 Hispanic Origin (Any Race)	3.1%	4.3%	5.3%

Persons of Hispanic origin represent 5.3% of the population in the identified area compared to 17.9% of the U.S. population. Persons of Hispanic Origin may be of any race. The Diversity Index, which measures the probability that two people from the same area will be from different race/ethnic groups, is 57.2 in the identified area, compared to 63.5 for the U.S. as a whole.

Households

2000 Households	1,511	22,642	69,773
2010 Households	1,741	25,040	72,905
2016 Total Households	1,956	26,789	76,828
2021 Total Households	2,155	28,334	80,480
2000-2010 Annual Rate	1.43%	1.01%	0.44%
2010-2016 Annual Rate	1.88%	1.09%	0.84%
2016-2021 Annual Rate	1.96%	1.13%	0.93%
2016 Average Household Size	2.82	2.85	2.70

The household count in this area has changed from 72,905 in 2010 to 76,828 in the current year, a change of 0.84% annually. The five-year projection of households is 80,480, a change of 0.93% annually from the current year total. Average household size is currently 2.70, compared to 2.69 in the year 2010. The number of families in the current year is 52,851 in the specified area.

Data Note: Income is expressed in current dollars

Source: U.S. Census Bureau, Census 2010 Summary File 1. Esri forecasts for 2016 and 2021. Esri converted Census 2000 data into 2010 geography.

September 02, 2016



Executive Summary

9400 W Broadway, BP 55445
9248 W Broadway Ave, Brooklyn Park, Minnesota, 55445
Rings: 1, 3, 5 mile radii

Colliers International
Latitude: 45.12330
Longitude: -93.37670

	1 mile	3 miles	5 miles
Median Household Income			
2016 Median Household Income	\$72,364	\$74,150	\$66,654
2021 Median Household Income	\$76,841	\$82,628	\$76,647
2016-2021 Annual Rate	1.21%	2.19%	2.83%
Average Household Income			
2016 Average Household Income	\$91,703	\$89,899	\$83,837
2021 Average Household Income	\$97,148	\$97,986	\$91,390
2016-2021 Annual Rate	1.16%	1.74%	1.74%
Per Capita Income			
2016 Per Capita Income	\$31,787	\$31,714	\$31,102
2021 Per Capita Income	\$33,451	\$34,453	\$33,820
2016-2021 Annual Rate	1.03%	1.67%	1.69%

Households by Income

Current median household income is \$66,654 in the area, compared to \$54,149 for all U.S. households. Median household income is projected to be \$76,647 in five years, compared to \$59,476 for all U.S. households

Current average household income is \$83,837 in this area, compared to \$77,008 for all U.S. households. Average household income is projected to be \$91,390 in five years, compared to \$84,021 for all U.S. households

Current per capita income is \$31,102 in the area, compared to the U.S. per capita income of \$29,472. The per capita income is projected to be \$33,820 in five years, compared to \$32,025 for all U.S. households

Housing			
2000 Total Housing Units	1,533	22,952	70,596
2000 Owner Occupied Housing Units	1,335	18,031	53,431
2000 Renter Occupied Housing Units	177	4,611	16,342
2000 Vacant Housing Units	21	310	823
2010 Total Housing Units	1,927	26,332	76,619
2010 Owner Occupied Housing Units	1,440	19,549	54,197
2010 Renter Occupied Housing Units	301	5,491	18,708
2010 Vacant Housing Units	186	1,292	3,714
2016 Total Housing Units	2,160	28,075	80,669
2016 Owner Occupied Housing Units	1,612	20,761	56,377
2016 Renter Occupied Housing Units	344	6,027	20,451
2016 Vacant Housing Units	204	1,286	3,841
2021 Total Housing Units	2,382	29,691	84,543
2021 Owner Occupied Housing Units	1,784	21,962	59,096
2021 Renter Occupied Housing Units	370	6,372	21,384
2021 Vacant Housing Units	227	1,357	4,063

Currently, 69.9% of the 80,669 housing units in the area are owner occupied; 25.4%, renter occupied; and 4.8% are vacant. Currently, in the U.S., 55.4% of the housing units in the area are owner occupied; 32.9% are renter occupied; and 11.7% are vacant. In 2010, there were 76,619 housing units in the area - 70.7% owner occupied, 24.4% renter occupied, and 4.8% vacant. The annual rate of change in housing units since 2010 is 2.32%. Median home value in the area is \$199,183, compared to a median home value of \$198,891 for the U.S. In five years, median value is projected to change by 2.78% annually to \$228,471.

Data Note: Income is expressed in current dollars

Source: U.S. Census Bureau, Census 2010 Summary File 1. Esri forecasts for 2016 and 2021. Esri converted Census 2000 data into 2010 geography.

September 02, 2016