

RETAIL FOR LEASE/SALE/BTS >

# Midas Station

9400 West Broadway Avenue | Brooklyn Park, MN



Accelerating success.



## PROPERTY DETAILS

- > For lease, BTS or land for sale
- > Up to 17,300 SF available or 2.6 acres
- > Adjacent to two hotels totaling 205 rooms
- > Great highway access
- > LRT Blue Line proposed station at 93rd Ave & Broadway
- > Site delivery: rough graded PAD
- > Utilities available
- > Ground breaking Spring 2017

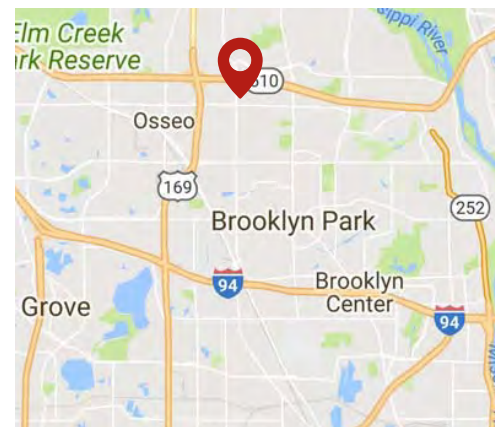

## CONTACT US >

Nate Hansen  
952 374 5856

[nate.hansen@colliers.com](mailto:nate.hansen@colliers.com)

Ted Gonsior CCIM  
952 897 7744

[ted.gonsior@colliers.com](mailto:ted.gonsior@colliers.com)

Brad Kaplan CCIM  
952 897 7730

[bradley.kaplan@colliers.com](mailto:bradley.kaplan@colliers.com)



# MIDAS STATION > FOR LEASE/SALE/BTS

## SITE INFORMATION:

- > Location: 9400 W Broadway Ave | Brooklyn Park, MN 55445
- > Description: 17,300 SF Available  
2.6 Acres Available
- > Zoning: BP - Business Park District

DEMOGRAPHICS:	1 MILE	3 MILE	5 MILE
Population	10,353	86,387	233,191
Median HH Income	\$55,022	\$56,166	\$67,579
Average HH Income	\$69,643	\$73,268	\$87,518

*\*Source: ESRI 2015 Est.*

## TRAFFIC COUNTS:

- > Highway 610: 61,000 vehicles per day
- > West Broadway Ave: 12,500 vehicles per day

*\*Source: Minnesota Department of Transportation 2011/6 Study averages are per day total cars*

## ASKING RENT:

\$25-28 PSF

## SALE PRICE:

\$10 PSF

## CONTACT US >

Nate Hansen  
952 374 5856  
[nate.hansen@colliers.com](mailto:nate.hansen@colliers.com)

Ted Gonsior CCIM  
952 897 7744  
[ted.gonsior@colliers.com](mailto:ted.gonsior@colliers.com)

Brad Kaplan CCIM  
952 897 7730  
[bradley.kaplan@colliers.com](mailto:bradley.kaplan@colliers.com)

## AERIAL



Accelerating success.

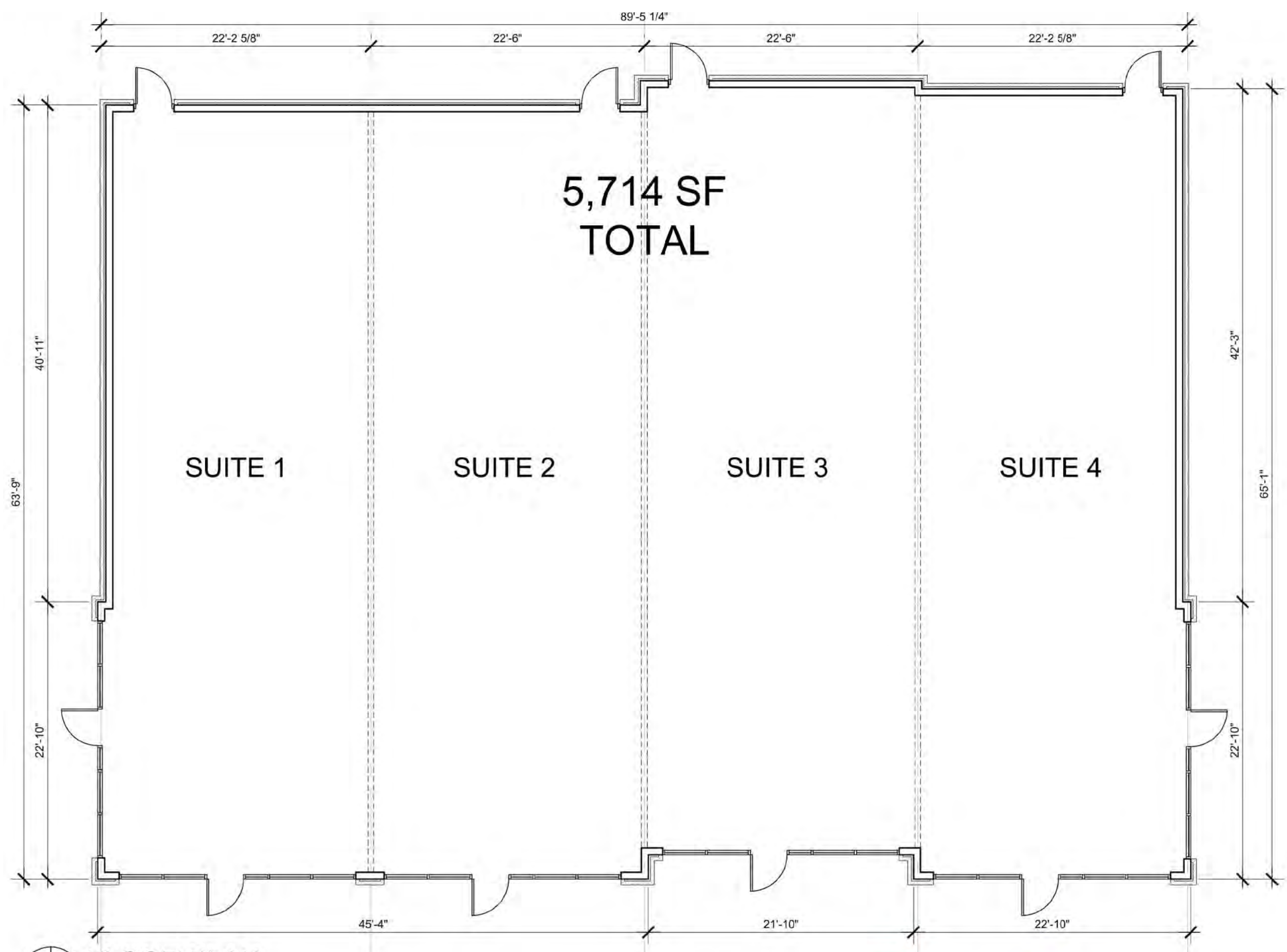

**FLOOR PLAN**

SCALE: 1/8" = 1'-0"

RETAIL C

Scale: As Noted

**MIDAS STATION**

I-610 AND WEST BROADWAY AVENUE  
BROOKLYN PARK, MINNESOTA



**gray**

16385.00  
11.01.2016



INTERSTATE 610

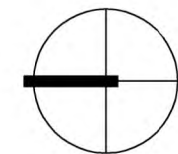

CONCEPT SITE PLAN - PHASE TWO

Scale: 1" = 70'-0"

A NEW MIXED-USE DEVELOPMENT

I-610 AND WEST BROADWAY AVENUE  
BROOKLYN PARK, MINNESOTA



15310.00  
08.16.2016





## FRONT ELEVATION

SCALE: 1/8" = 1'-0"



## SIDE ELEVATION

SCALE: 1/8" = 1'-0"





## SIDE ELEVATION

SCALE: 1/8" = 1'-0"



## BACK ELEVATION

SCALE: 1/8" = 1'-0"



