



4.57± Acres

For Sale

ROBERT W. SELTON, III
CEO
904 861 1111
robert.selton@colliers.com

MATT ENTRIKEN
Executive Vice President
904 861 1148
matt.entriken@colliers.com



COLLIERS INTERNATIONAL
50 N. Laura Street, Suite 1725
Jacksonville, FL 32202
+1 904 358 1206
www.colliers.com/jacksonville

Gene Lasserre Blvd. at SR200/A1A
Yulee, FL 32097

Key Features

- › Corner parcel at lighted intersection
- › Part of the Nassau Tradeplex
- › In the heart of the growth corridor of SR200/A1A
- › Great opportunity for an end user or developer that wants a high visibility location
- › Zoned IW, allowing for multiple type uses in Nassau County. ([Click for permitted uses and restrictions.](#))
- › Traffic Count: 37,500 cars per day on SR200/A1A

Asking Price: \$1,975,000

Address:	SR200/A1A at Gene Lasserre Blvd.
City, State, Zip:	Yulee, FL 32097
County:	Nassau
Site Area:	4.57± AC
Zoning:	Industrial
Asking Price:	\$1,975,000

Demographics	1 Mile	3 Mile	5 Mile
Pop. Est. 2016	5,014	14,233	20,886
2016 Est. Households	2,117	6,254	9,058
2021 Proj. Avg. HH Income	\$72,218	\$81,790	\$92,080

Source: Esri Business Analyst Online

PROPERTY PHOTOS

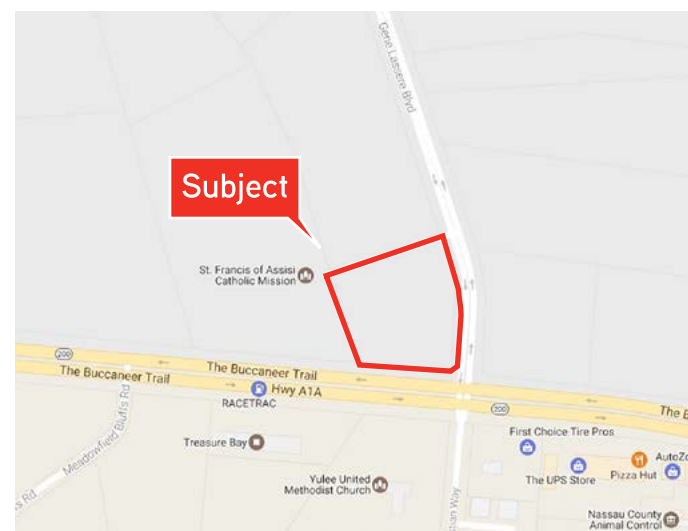
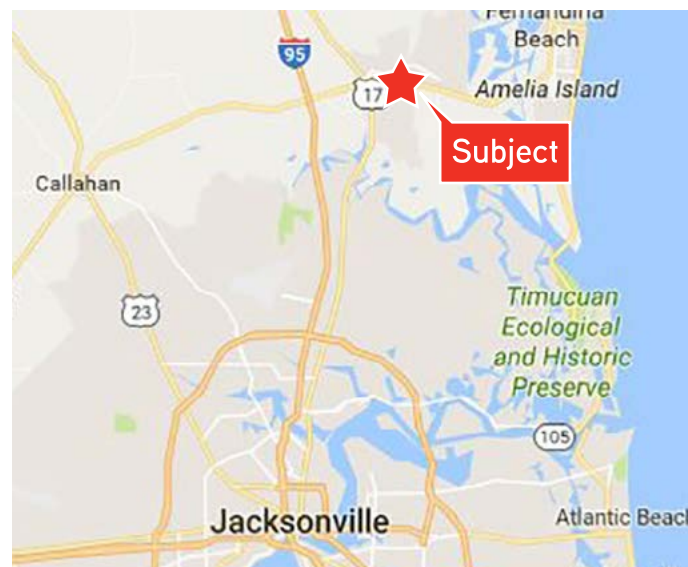

CONTACT US

ROBERT W. SELTON, III
904 861 1111
robert.selton@colliers.com

MATT ENTRIKEN
904 861 1148
matt.entriken@colliers.com



COLLIERS INTERNATIONAL
50 N. Laura Street, Suite 1725
Jacksonville, FL 32202
+1 904 358 1206
www.colliers.com/jacksonville

This document has been prepared by Colliers International for advertising and general information only. Colliers International makes no guarantees, representations or warranties of any kind, expressed or implied, regarding the information including, but not limited to, warranties of content, accuracy and reliability. Any interested party should undertake their own inquiries as to the accuracy of the information. Colliers International excludes unequivocally all inferred or implied terms, conditions and warranties arising out of this document and excludes all liability for loss and damages arising there from. This publication is the copyrighted property of Colliers International and/or its licensor(s). ©2017. All rights reserved.

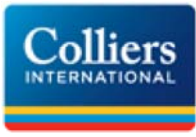

Summary (7087)



Chism/Tradeplex SR 200 & Gene Lasserre Blvd Yulee, FL 32097

County:	Nassau
Market:	Jacksonville
Sub Market:	Nassau County
Lot Dimensions (LxW):	333 x 363 x 475 x 489
Land Size (SF):	199,069 SF
Land Size (Acres):	4.57 Acres

General Listing/Transaction Information

Asking Price:	\$1,975,000.00 \$9.92 Per SF
Price/Acre:	\$432,166.30
Transaction Type:	Sale

Contacts

Listing Broker(s)	Robert Selton, III Colliers International Northeast Florida 904.861.1111 robert.selton@colliers.com
-------------------	--

Matt Entrioken
Colliers International | Northeast Florida
904.861.1148
matt.entrioken@colliers.com

Site

Parcel Number:	37-2N-27-0000-0001-0310 & 37-2N-27-0000-0001-0280
Zoning:	IL
Topography:	Generally Level
Land Condition:	Cleared

Utilities

Water:	City Water
Sewer:	City Sewer
Utilities Comments:	Water and sewer are at site

Comments

Listing Comments:

- > Corner parcel at lighted intersection
- > Part of the Nassau Tradeplex
- > In the heart of the growth corridor
- > Great opportunity for an end user or developer that wants a high visibility location
- > IL zoning allows for multiple type uses in Nassau County
- > Traffic Count: 37,000 cars per day on SR 200