

FOR LEASE

600 Canal Place

600 E. Canal Street | Richmond, VA 23219

SUSAN JONES | 804 591 2415 | susan.jones@colliers.com



600 CANAL PLACE >

FOR LEASE



The Property

Currently under construction, **600 Canal Place** will consist of a 20-story, 908,500 square foot Class A office building with street-level retail space.

Amenities

- > 1,200 employees on-site
- > 11,100 daytime workers in walkable trade area
- > Growing residential population
- > Great street-level retail exposure
- > Regular city events, including the Grand Illumination, Richmond Folk Festival ($\pm 200,000$ attendees) and Anthem Richmond Marathon ($\pm 15,000$ entries)
- > Over 1,700 public parking spaces within four city blocks

Retail Availability

SPACE I > 1,600 SF - fronting Cary Street

SPACE II > 3,237 SF - fronting Cary Street

| DEMOGRAPHIC FACTS | 1 Mile | 3 Miles | 5 Miles |
|--------------------|--------|---------|---------|
| Population | 11,479 | 118,685 | 231,866 |
| Daytime Employment | 78,622 | 126,137 | 187,925 |

Price/Lease Rate

CALL AGENT FOR DETAILS



Contact:

SUSAN JONES
804 591 2415
susan.jones@colliers.com



COLLIERS INTERNATIONAL
7200 Glen Forest Drive | Suite 200
Richmond, VA 23226
804 788 1000
www.colliers.com/richmond

600 CANAL PLACE > Retail floor plans

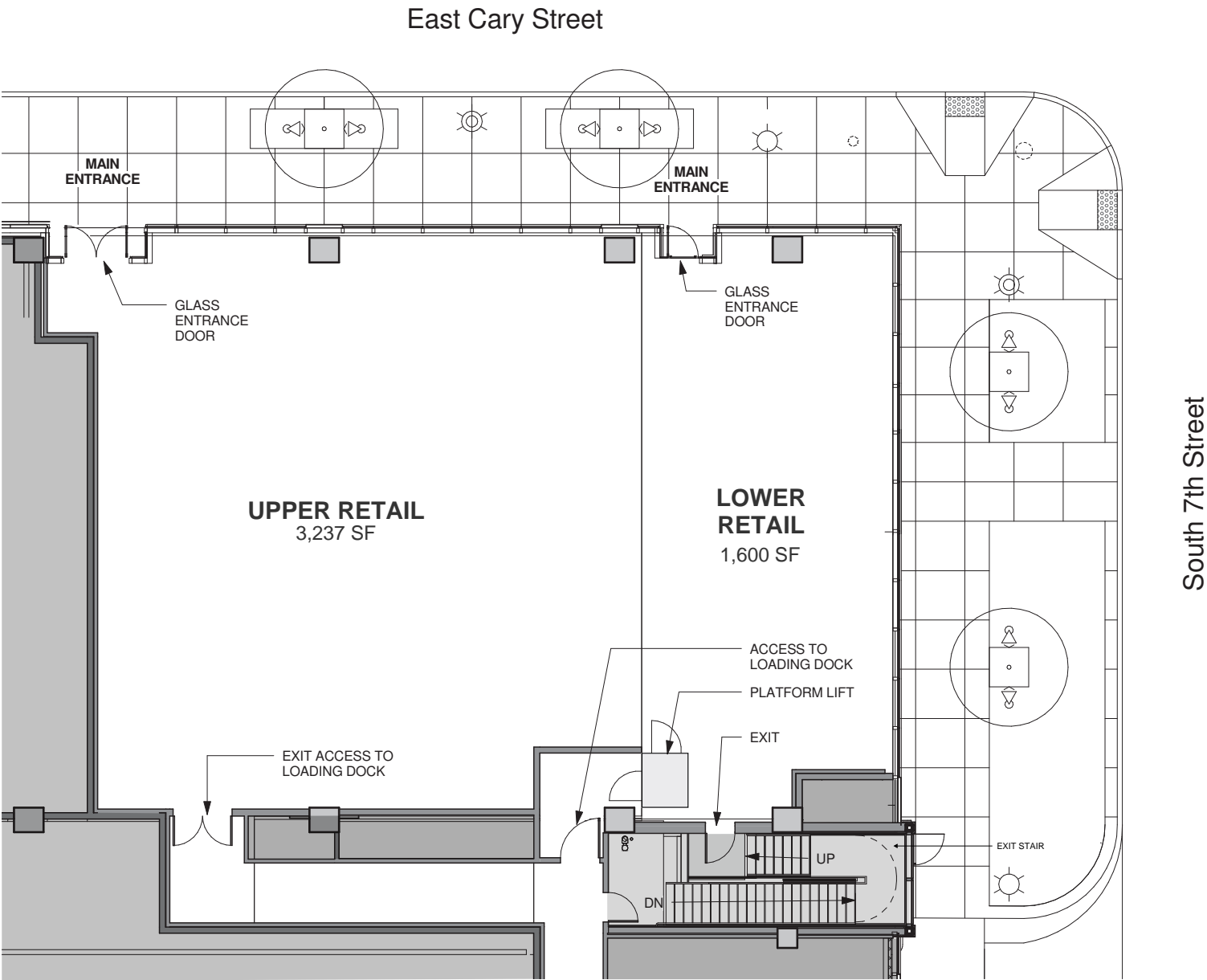

LANDMARKS > RESTAURANTS > CLASS A OFFICE



LANDMARKS

- 1 The Jefferson Hotel
- 2 Richmond Convention Center
- 3 Richmond Coliseum
- 4 Marriott
- 5 National Theatre
(Coda Restaurant)
- 6 Library of Virginia
- 7 City Hall
- 8 Miller & Rhoads - Hilton Hotel
- 9 Center Stage
- 10 Federal Courts 4th District
- 11 Old City Hall
- 12 Residences at the John Marshall
- 13 VA State Capitol
- 14 Tredegar Iron Works

RESTAURANTS

- 1 Comfort
- 2 Bistro 27
- 3 Tarrants
- 4 Capital Ale House
- 5 Wong Gonzales
- 6 Trevi's Restaurant, Arby's, Nathan's & Starbucks
- 7 Berkley Hotel Dining Room
- 8 Sam Miller's
- 9 The Tobacco Company
- 10 LaGrotta
- 11 Peking
- 12 Kobe
- 13 Urban Farmhouse Market
- 14 Sine' Irish Pub
- 15 Morton's Steakhouse
- 16 Casa Del Barco
- 17 Potbelly Sandwich Shop
- 18 Secret Sandwich Society
- 19 Quizno's
- 20 Subway
- 21 Cafe' Ole
- 22 Cafe' Rustica
- 23 Cafe' Le Ville
- 24 Penny Lane Pub
- 25 Saison
- 26 Triple Crossing Brewery
- 27 Pasture
- 28 Rappahanock Oyster Bar
- 29 Pork Chops & Grits
- 30 Mama J's
- 31 Chez Foushee
- 32 Julep's
- 33 Bistro 27
- 34 Graffiatto

- 35 Comfort
- 36 Max's

CLASS A OFFICE

- 1 James Center I
- 2 James Center II & III
- 3 Williams Mullen
- 4 MeadWestvaco
- 5 Riverfront Plaza
- 6 Riverside on the James
- 7 Federal Reserve
- 8 Gateway Plaza
- 9 **Dominion Resources HQ**

Contact:

SUSAN JONES
804 591 2415
susan.jones@colliers.com

COLLIERS INTERNATIONAL
7200 Glen Forest Drive | Suite 200
Richmond, VA 23226
804 788 1000
www.colliers.com/richmond



This document/email has been prepared by Colliers International for advertising and general information only. Colliers International makes no guarantees, representations or warranties of any kind, expressed or implied, regarding the information including, but not limited to, warranties of content, accuracy and reliability. Any interested party should undertake their own inquiries as to the accuracy of the information. Colliers International excludes unequivocally all inferred or implied terms, conditions and warranties arising out of this document and excludes all liability for loss and damages arising there from. This publication is the copyrighted property of Colliers International and /or its licensor(s). © 2017. All rights reserved. This communication is not intended to cause or induce breach of an existing listing agreement. CanalPlace600_Lease 10-2-17