

FOR LEASE > RETAIL



# New Century Plaza

933 E LINCOLN LANE, GARDNER, KS



## Property Description

- > 3,942 SF and 1,488 SF available
- > End-cap location
- > Located off 56 Highway
- > Asking \$16.50 PSF, NNN

COLEBY HENZLIK  
+1 816 556 1180  
KANSAS CITY, MO  
[coleby.henzlik@colliers.com](mailto:coleby.henzlik@colliers.com)

COLLIERS INTERNATIONAL  
4520 Main Street, Suite 1000  
Kansas City, MO 64111  
[www.colliers.com](http://www.colliers.com)

## New Century Plaza > Aerial

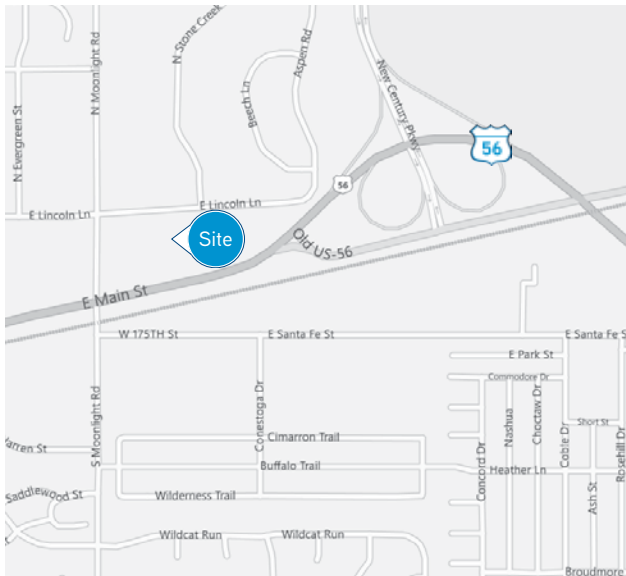

## Contact Us

COLEBY HENZLIK  
+1 816 556 1180  
KANSAS CITY, MO  
[coleby.henzlik@colliers.com](mailto:coleby.henzlik@colliers.com)

COLLIERS INTERNATIONAL  
4520 Main Street, Suite 1000  
Kansas City, MO 64111  
[www.colliers.com](http://www.colliers.com)

This document has been prepared by Colliers International for advertising and general information only. Colliers International makes no guarantees, representations or warranties of any kind, expressed or implied, regarding the information including, but not limited to, warranties of content, accuracy and reliability. Any interested party should undertake their own inquiries as to the accuracy of the information. Colliers International excludes unequivocally all inferred or implied terms, conditions and warranties arising out of this document and excludes all liability for loss and damages arising there from. This publication is the copyrighted property of Colliers International and/or its licensor(s). © 2016. All rights reserved.

