

# SITE PLAN >

Hy-Vee Rochester | NWQ 41st St NW and Circle Dr NW | Rochester, MN

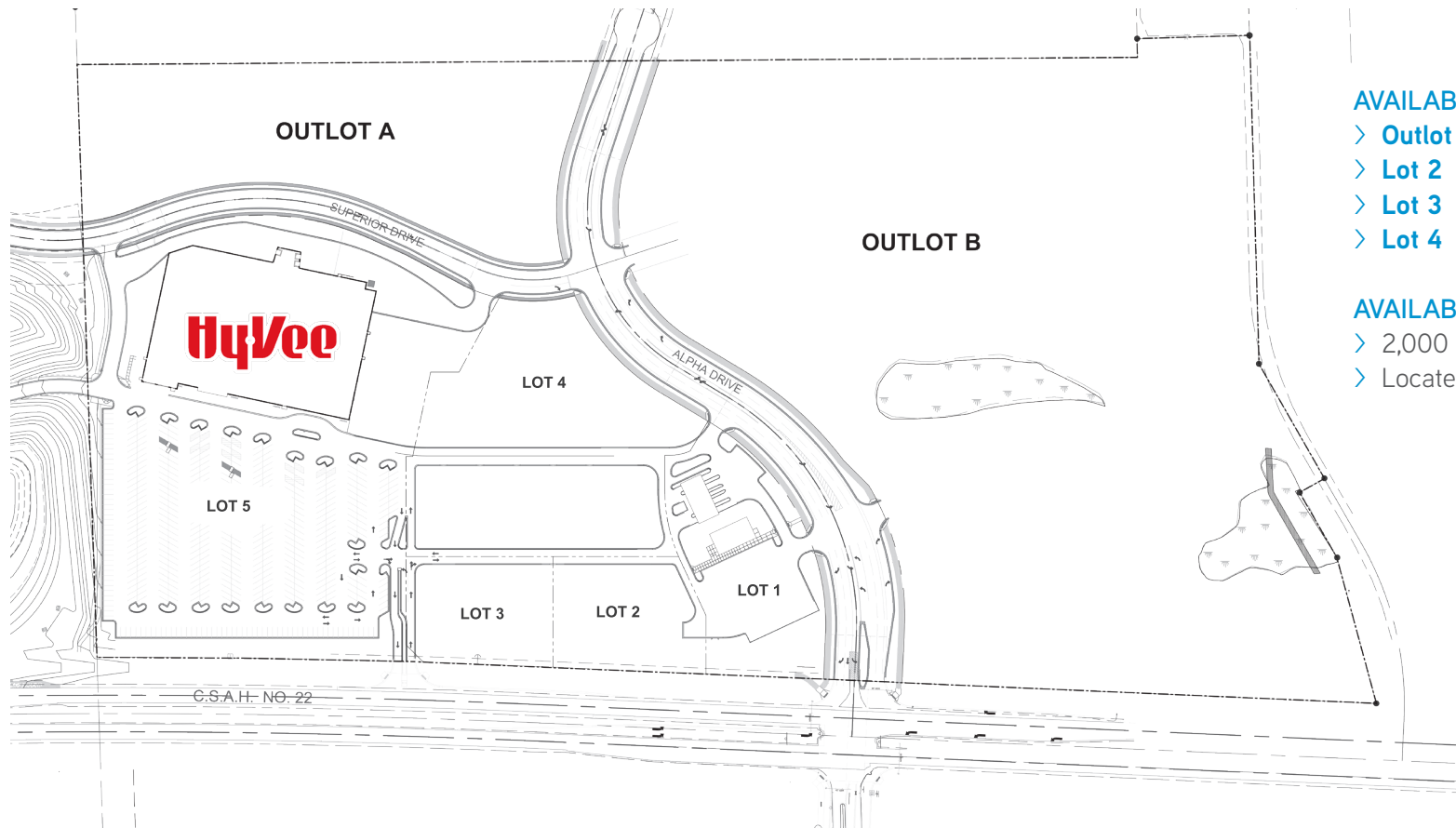

Accelerating success.



## AVAILABLE FOR SALE:

- > **Outlot B** 24.7 Acres
- > **Lot 2** 1.21 Acres
- > **Lot 3** 1.15 Acres
- > **Lot 4** 4.19 Acres

## AVAILABLE FOR LEASE:

- > 2,000 - 20,900 SF
- > Located on Lot 4

## CONTACT US >

Tom Palmquist  
952 897 7739  
[tom.palmquist@colliers.com](mailto:tom.palmquist@colliers.com)