

Colliers

Industrial/Flex For Lease



9411 N Crescent Boulevard
Pennsauken, New Jersey

Crescent Logistics Center

9,942 SF Available / Divisible

Contact:

Ross Abramsohn

Vice President
+1 856 316 4139
ross.abramsohn@colliers.com

Ian Richman

Senior Managing Director
+1 856 414 1257
ian.richman@colliers.com

Owned by:



VELOCITY VENTURES

Accelerating success.

9411 N Crescent Boulevard | For Lease

Property Profile



Building Specifications

Units Size	9419 5,022 SF; 9421 4,920 SF	Power	Separately metered, size of service varies
Office	Will build to suit	Clear Height	Approximately 13'
Zoning	Light Industrial	Fire Suppression	None
Construction	Brick & block	Loading	9419 Two (2) drive-in doors; 9421 One (1) drive-in door

Floor Plan

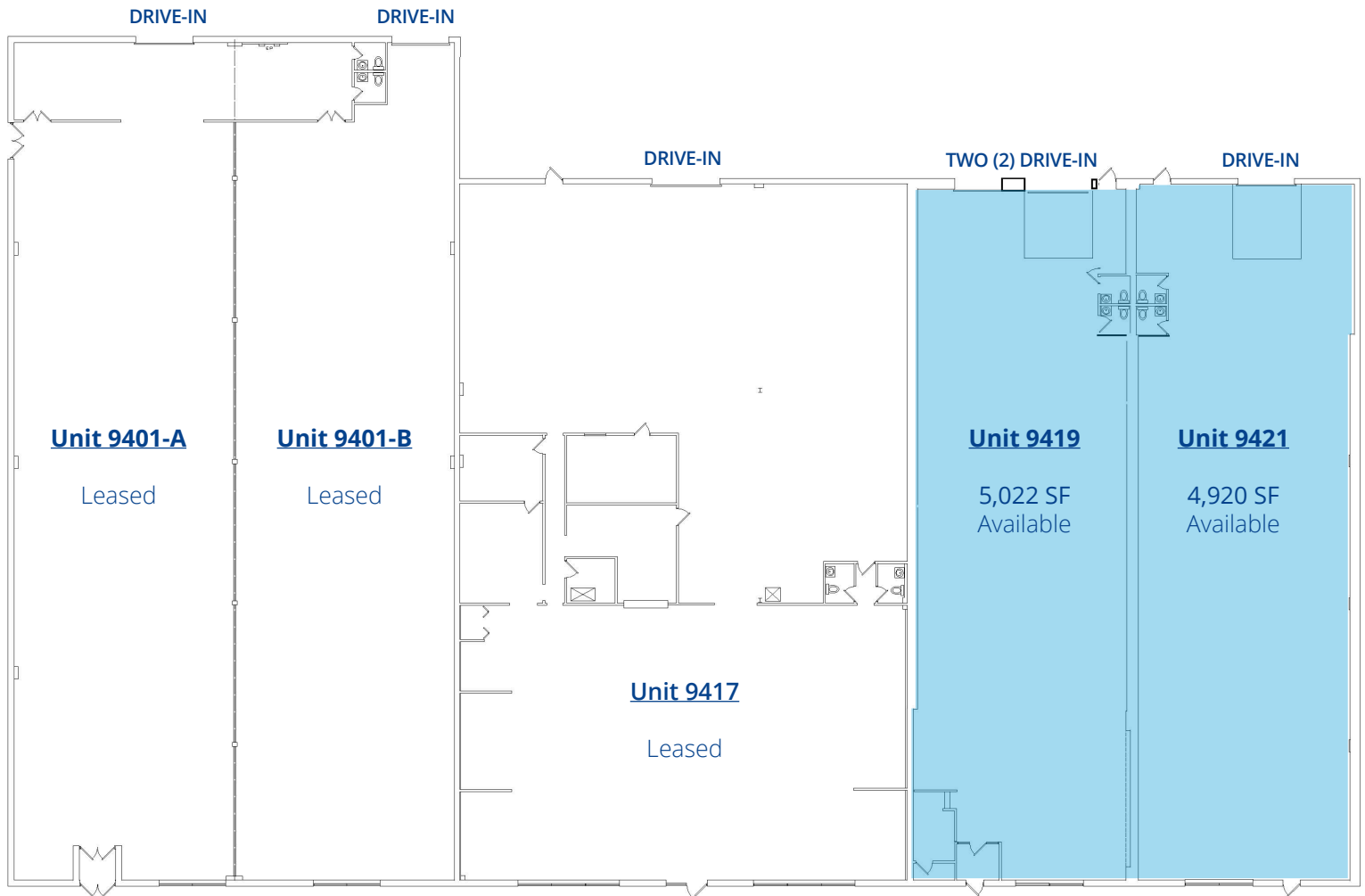

N Crescent Boulevard (44,259 AADT)

For Lease

Location & Access

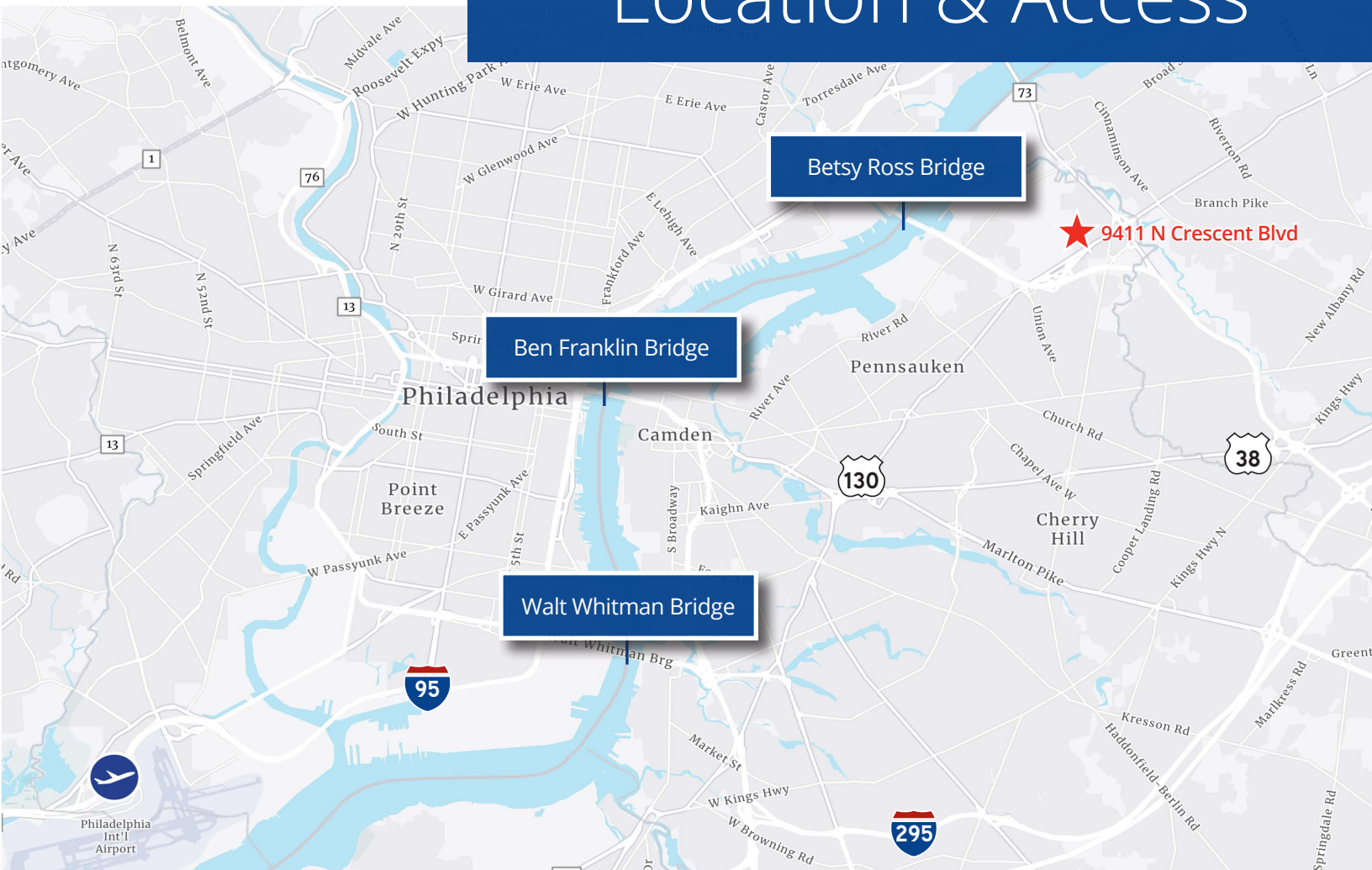

Drive Times

Interstates



I-295
12 minutes (4.4 miles)

NJ Turnpike
14 minutes (5.12 miles)

Bridges



Betsy Ross
6 minutes (2.3 miles)

Benjamin Franklin
16 minutes (6.3 miles)

Airports



Philadelphia (PHL)
33 minutes (14 miles)

Atlantic City (ATL)
64 minutes (43.7 miles)

Ross Abramsohn

Vice President
+1 856 316 4139
ross.abramsohn@colliers.com

Ian Richman

Senior Managing Director
+1 856 414 1257
ian.richman@colliers.com



1317 Route 73, Suite 109
Mt. Laurel, NJ 08054
P: +1 856 234 9300
F: +1 856 222 1115

This document has been prepared by Colliers International for advertising and general information only. Colliers International makes no guarantees, representations or warranties of any kind, expressed or implied, regarding the information including, but not limited to, warranties of content, accuracy and reliability. Any interested party should undertake their own inquiries as to the accuracy of the information. Colliers International excludes unequivocally all inferred or implied terms, conditions and warranties arising out of this document and excludes all liability for loss and damages arising there from. This publication is the copyrighted property of Colliers International and/or its licensor(s). ©2021. All rights reserved.