

FOR SALE > PROFESSIONAL OFFICE SPACE



610 Signal Hill Drive

610 SIGNAL HILL DRIVE, SUITE 300, STATESVILLE, NC



Property Summary >

±4,000 square feet available for sale located in Statesville, NC. Ideal location providing convenient access to Interstate 77 and 40. Functional floorplan with seven private offices, four work stations, two conference rooms, break room as well as a separate IT Room. Design is conducive for multiple uses including medical, insurance, general office, law offices, and several other types.

Building Amenities >

- > ±4,000 SF
- > ±12 Parking Spaces
- > 1.5 Miles to I-77
- > 2.6 Miles to I-40
- > 2.0 Miles to Iredell Health System Hospital
- > 1.9 Miles to Davis Regional Medical Center
- > 7 Private Offices
- > 4 Work Stations
- > 2 Conference Rooms, Break Room, IT Room
- > 1 Drive In Door
- > Asking Price: \$750,000



GRANT MILLER, SIOR
704 409 2364
CHARLOTTE, NC
grant.miller@colliers.com

ADAM FARBER
704 409 2369
CHARLOTTE, NC
adam.farber@colliers.com

COLLIERS INTERNATIONAL
301 S. College Street, Suite 3350
Charlotte, NC 28202
www.colliers.com

610 Signal Hill >

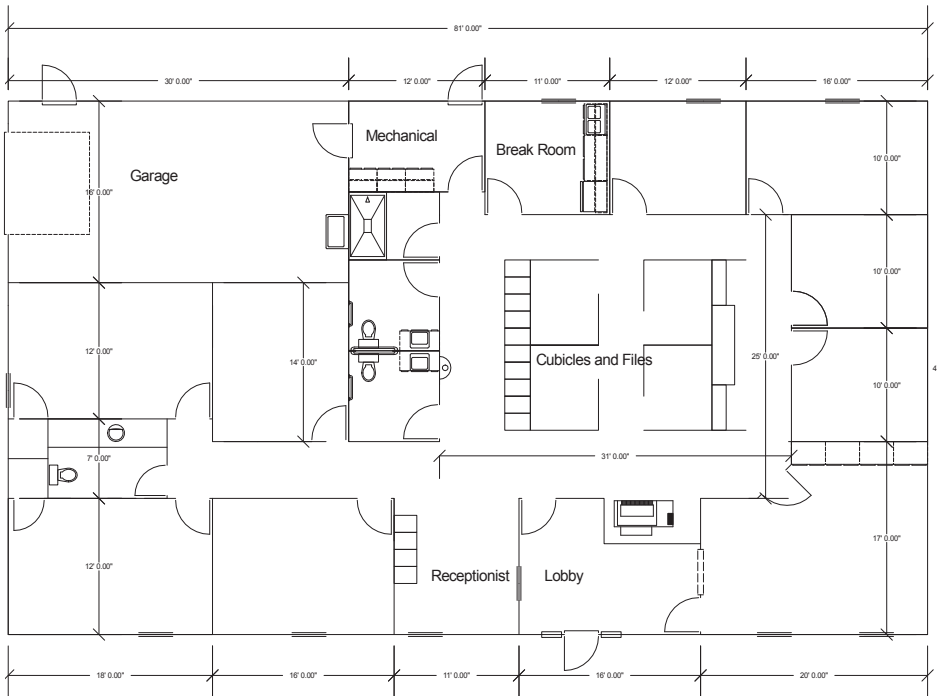
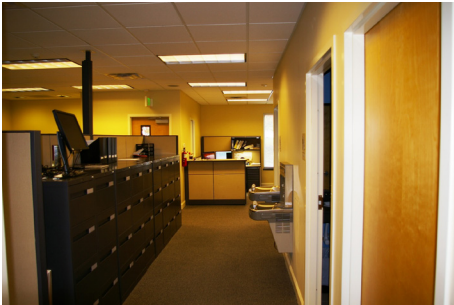
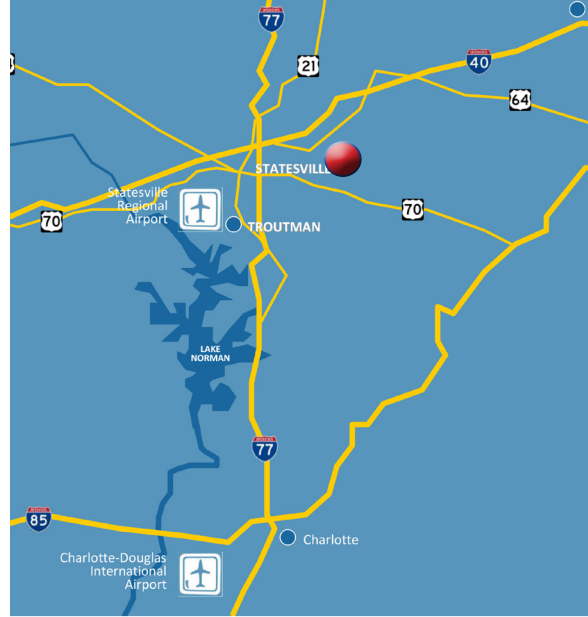

Contact Us

GRANT MILLER, SIOR
704 409 2364
CHARLOTTE, NC
grant.miller@colliers.com

ADAM FARBER
704 409 2369
CHARLOTTE, NC
adam.farber@colliers.com

COLLIERS INTERNATIONAL
301 S. College Street, Suite 3350
Charlotte, NC 28202
www.colliers.com

The information contained herein has either been given to us by the owner of the property or has been obtained from sources that we deem reliable. We have no reason to doubt its accuracy, but we do not guarantee it. This property is subject to prior sale, lease, price change or withdrawal without notice. Note: Broker participation is welcomed. Compensation is offered to buyer/tenant representative.

