



CX2 CLOUD

THE MEGASUITE

160,000 SF
AVAILABLE NOW

1

CX2 CLOUD



- Turnkey data center space with minimal deployment requirements
- Wholesale Pricing for Turn-Key entry
- No cross-connect fees for connectivity between Cloud Service Providers, their colocation customers, or to carriers
- Direct access to the world's richest interconnection building, including infrastructure, fiber vaults and conduits

2

MEGASUITE

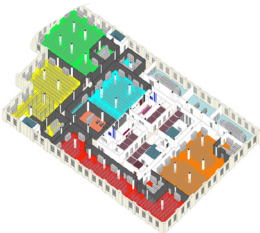

- 1000 KW (7 x 24/365) | Ups and Battery Backup: N+1
- Wholesale Pricing for turn-key entry to NYC Market
- Raised Floor or on Slab Construction, turn-key built to suit (options to customize available)
- Microgryrd of Utility Grade Power: Delivered in any voltage from 48 volts DC to 13,200 volts AC
- Full Mission Critical back up

3

160,000 SF AVAILABLE NOW



- 12 MW Available | Dry Pipe Pre-action sprinkler
- Raised Floor built to suit
- Wholesale Offering: Tenant controls its IT environment
- Microgryrd of Utility Grade Power: Delivered in any voltage from 48 volts DC to 13,200 volts AC
- Full Mission Critical Back N+1 Back Up Cooling and Power
- Direct Fiber Optic conduits built to suit with no cross connect fees, POE's from street
- Over 300 Telecommunications and data Network providers available
- 26,000 Gallon Onsite Diesel Fuel Storage

MONA WEISBERG

REAL ESTATE SALESPERSON | DIRECTOR

DIRECT: +1 212 716 3894 | CELL: +1 917 494 4230

mona.weisberg@colliers.com

DATAGRYDTM
DATA CENTERS | SIXTY HUDSON

60 HUDSON STREET NY, NY 10013

MAIN: +1 646 383 4666 | www.datagryd.com

VERTICAL INFRASTRUCTURE - CONCEPTUAL RISER DIAGRAM

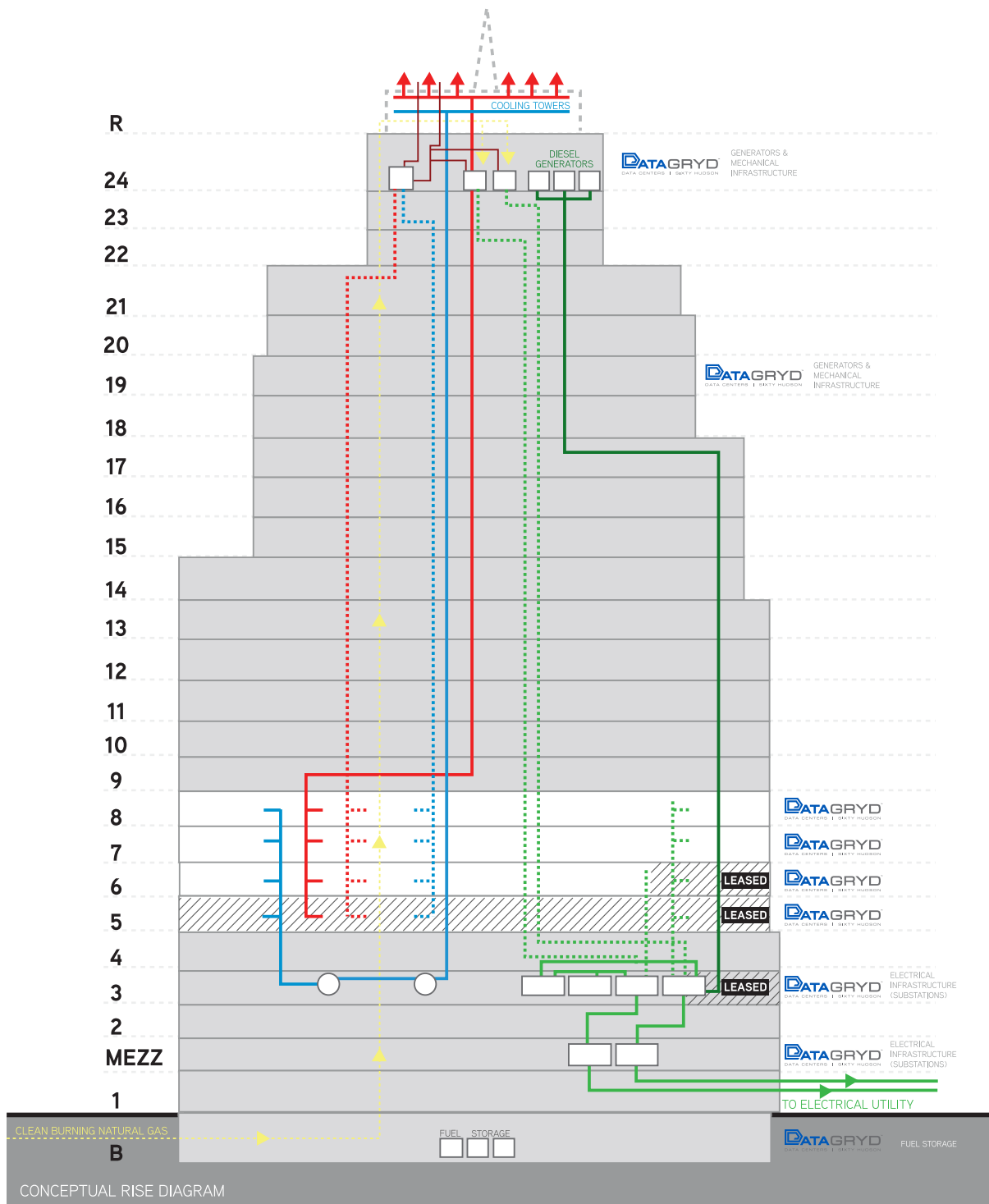

- Datagryd owns risers, cooling systems, and fiber-optic backbone for controls
- Datagryd has rights to construct riser systems and lateral conduits to suites within building, enabling the construction of a fiber optic distribution system without the need to pass through any existing Meet Me Room or Meet Me Area
- Vertical infrastructure has been designed with pre-set modularity minimizing expansion costs

MONA WEISBERG

REAL ESTATE SALESPERSON | DIRECTOR

DIRECT: +1 212 716 3894 | CELL: +1 917 494 4230

mona.weisberg@colliers.com

DATAGRYD
DATA CENTERS | SIXTY HUDSON

60 HUDSON STREET NY, NY 10013

MAIN: +1 646 383 4666 | www.datagryd.com

DATAGRYD IS AFFILIATED WITH:

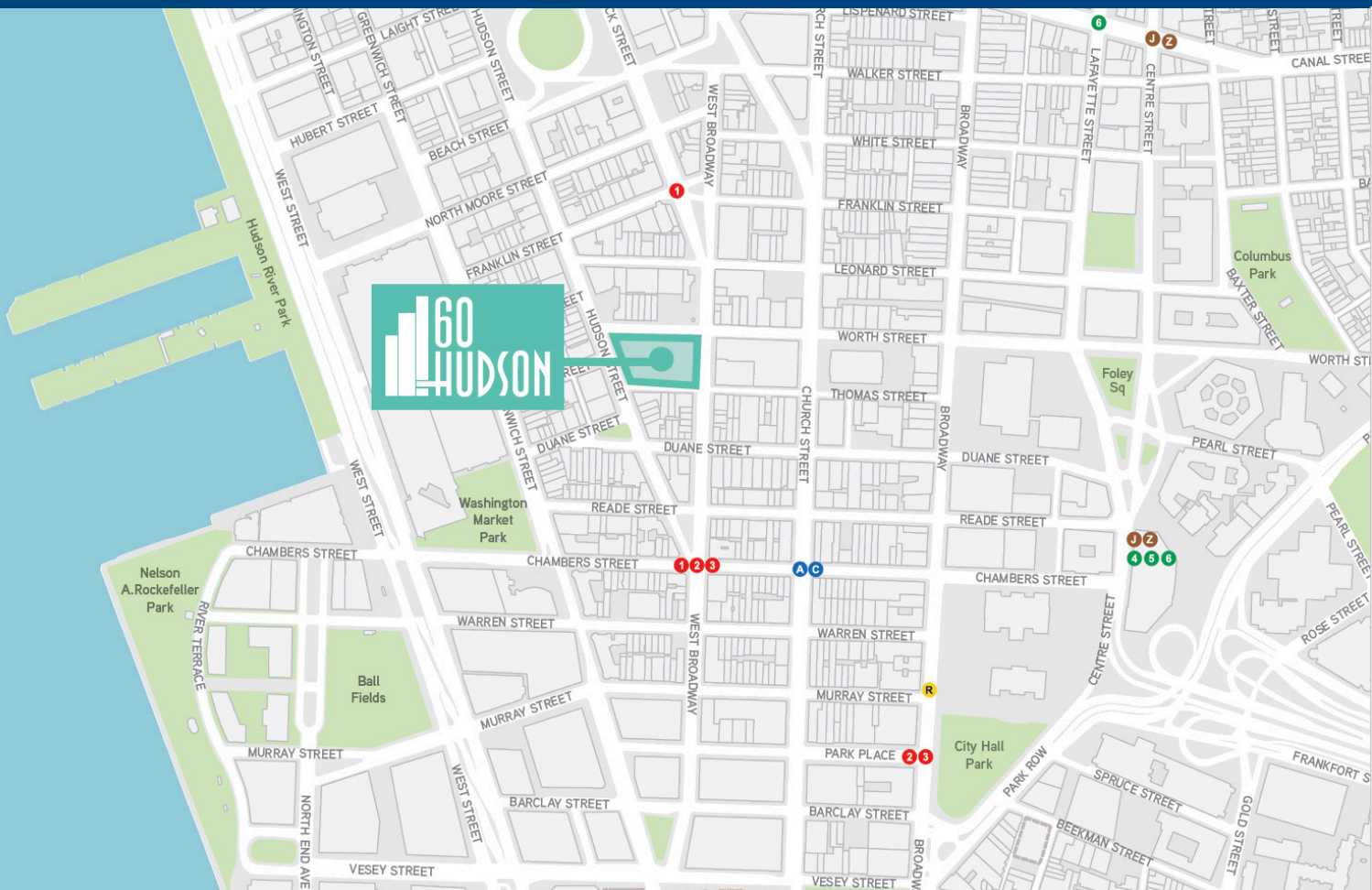

MONA WEISBERG

REAL ESTATE SALESPERSON | DIRECTOR

DIRECT: +1 212 716 3894 | CELL: +1 917 494 4230

mona.weisberg@colliers.com



60 HUDSON STREET NY, NY 10013

MAIN: +1 646 383 4666 | www.datagryd.com

No representation is made as to the accuracy of the information furnished herein and same is submitted subject to errors, omissions, change of prices, rental, or other conditions, prior sale, lease, sublease, and/or withdrawal without notice. The furnishing of this information shall not be deemed a hiring. A commission in accordance with our principal's schedule of rates and conditions will be paid to the procuring Broker who executes our or our principal's brokerage agreement, subject to a fully consummated transaction upon terms and conditions acceptable to our principal.