

THE MERITEX[®] CO.

ESTD 1916

Meritex Lenexa Executive Park
17501 West 98th Street, Lenexa, Kansas

FOR LEASE

LIGHT MANUFACTURING | WAREHOUSING | DISTRIBUTION

JOHNSON COUNTY'S MOST AFFORDABLE INDUSTRIAL SPACE



Space Available

6,000 SF	1 DI/Shared Docks	\$6.10 PSF, FS
8,000 SF	1 DI/Shared Docks	\$6.10 PSF, FS
12,000 SF	1 DI/Shared Docks	\$5.90 PSF, FS
16,000 SF	1 DI/Shared Docks	\$5.90 PSF, FS
26,000 SF	4 DH/1 DI	\$3.90 PSF, FS
40,000 SF (1,400 SF Office)	2 DH/1 DI	\$3.95 PSF (taxes/CAM included)

4.5% Tenant Rep Broker Fee

PROPERTY FEATURES:

- Low lease rates
- Build-to-suit office
- Low utility costs
- On-site management
- Flexible for expansion
- Enclosed interior truck docks

Tom Haverty
Executive Vice President
+1 816 556 1105
tom.haverty@colliers.com

John Stafford SIOR
Senior Vice President
+1 816 556 1184
john.stafford@colliers.com

THE MERITEX[®] CO.
www.meritex.com

Colliers
INTERNATIONAL
www.colliers.com

THE MERITEX[®] CO.

ESTD 1916

Meritex Lenexa Executive Park
17501 West 98th Street, Lenexa, Kansas

NEW SMALL USER SECTION

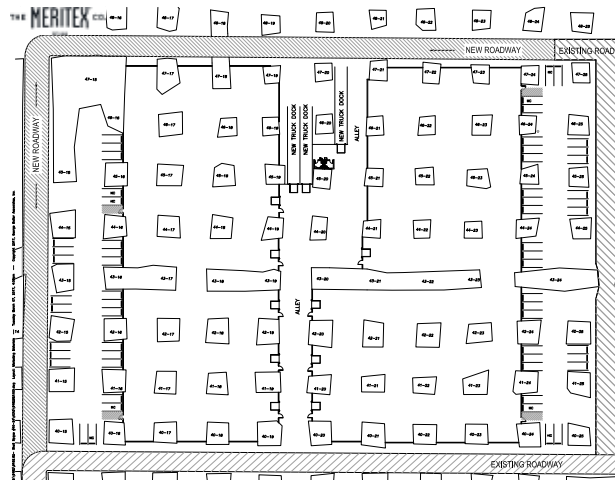

UP TO 40,000 SF

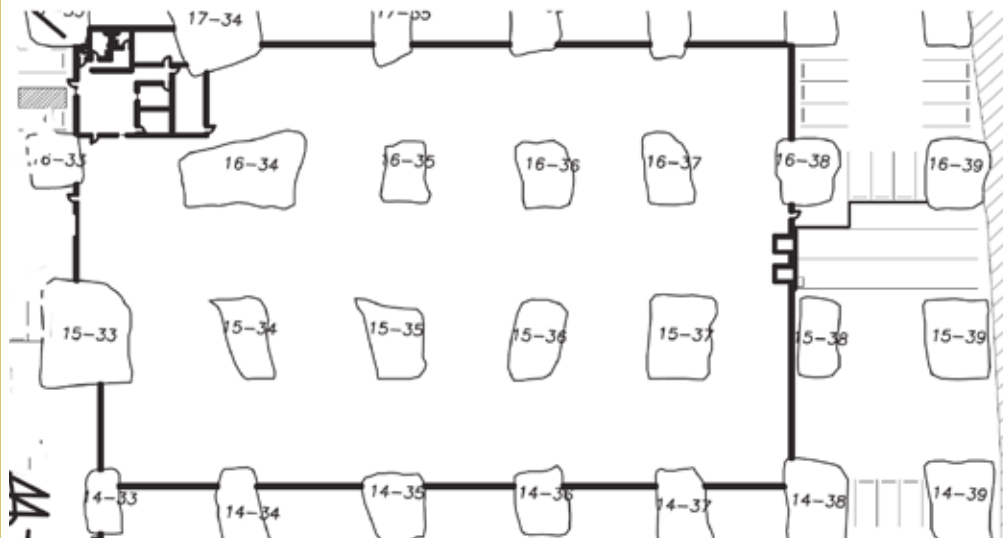

Tom Haverty
Executive Vice President
+1 816 556 1105
tom.haverty@colliers.com

John Stafford SIOR
Senior Vice President
+1 816 556 1184
john.stafford@colliers.com

THE MERITEX[®] CO.
www.meritex.com

Colliers
INTERNATIONAL
www.colliers.com