

.41 ACRES WITH 1,600± SF RETAIL BUILDING > FOR SALE OR LEASE

298 S. Pleasantburg Drive

GREENVILLE, SC 29607



Land and Building for Sale or Lease >

- > Signalized corner
- > 0.41 Acres
- > ±1,600 SF Building
- > Ice machine lease in place with income of \$3,600/year
- > ±125' frontage on S. Pleasantburg Drive
- > Zoned C-3, City of Greenville
- > Tax Map #0266000101106
- > **SALE PRICE: \$339,000**
- > **Lease Rate: \$2,000/month NNN**

***DISCLOSURE: Property is an Agent owned listing.**



26,900 S. Pleasantburg Drive

Demographics⁽²⁰¹⁶⁾

	1-MILE	3-MILE	5-MILE
2016 POPULATION	8,140	66,096	161,660
HOUSEHOLDS	3,561	28,666	67,286
AVERAGE HH INCOME	\$67,029	\$67,574	\$60,414

FRANK HAMMOND, CCIM, CPM

864 527 5451 DIRECT

864 297 4950 MAIN

frank.hammond@colliers.com

COLLIERS INTERNATIONAL
55 E. Camperdown Way, Suite 200
Greenville, South Carolina 29601
www.colliers.com/southcarolina

.41 ACRES WITH 1,600± SF RETAIL BUILDING > FOR SALE OR LEASE

298 S. Pleasantburg Drive

GREENVILLE, SC 29607



FLOOR PLAN

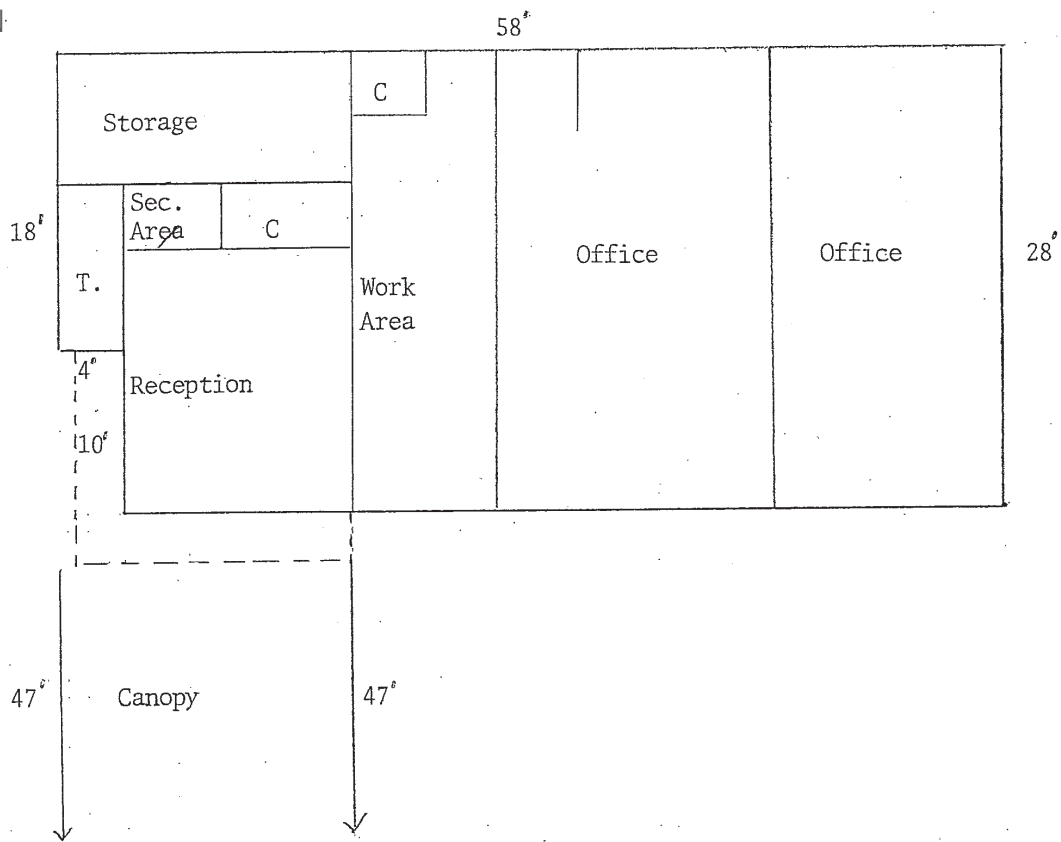

This document has been prepared by Colliers International for advertising and general information only. Colliers International makes no guarantees, representations or warranties of any kind, expressed or implied, regarding the information including, but not limited to, warranties of content, accuracy and reliability. Any interested party should undertake their own inquiries as to the accuracy of the information. Colliers International excludes unequivocally all inferred or implied terms, conditions and warranties arising out of this document and excludes all liability for loss and damages arising there from. This publication is the copyrighted property of Colliers International and/or its licensor(s). ©2016. All rights reserved.