

FOR LEASE

# 75,000 SF Industrial Building



6901  
MARLIN CIRCLE  
LA PALMA, CA 90623

JEFF SMART

*Executive Vice President*

License No. 00918873

+1 310 321 1812

jeffrey.smart@colliers.com

GRACE YI

*Senior Associate*

License No. 01837630

+1 310 321 1830

grace.yi@colliers.com

©2017 Colliers International. Information herein has been obtained from sources deemed reliable, however its accuracy cannot be guaranteed. The user is required to conduct their own due diligence and verification.

Colliers International  
2121 Rosecrans Avenue | Suite 3301  
El Segundo, CA 90245  
P: +1 310 787 1000



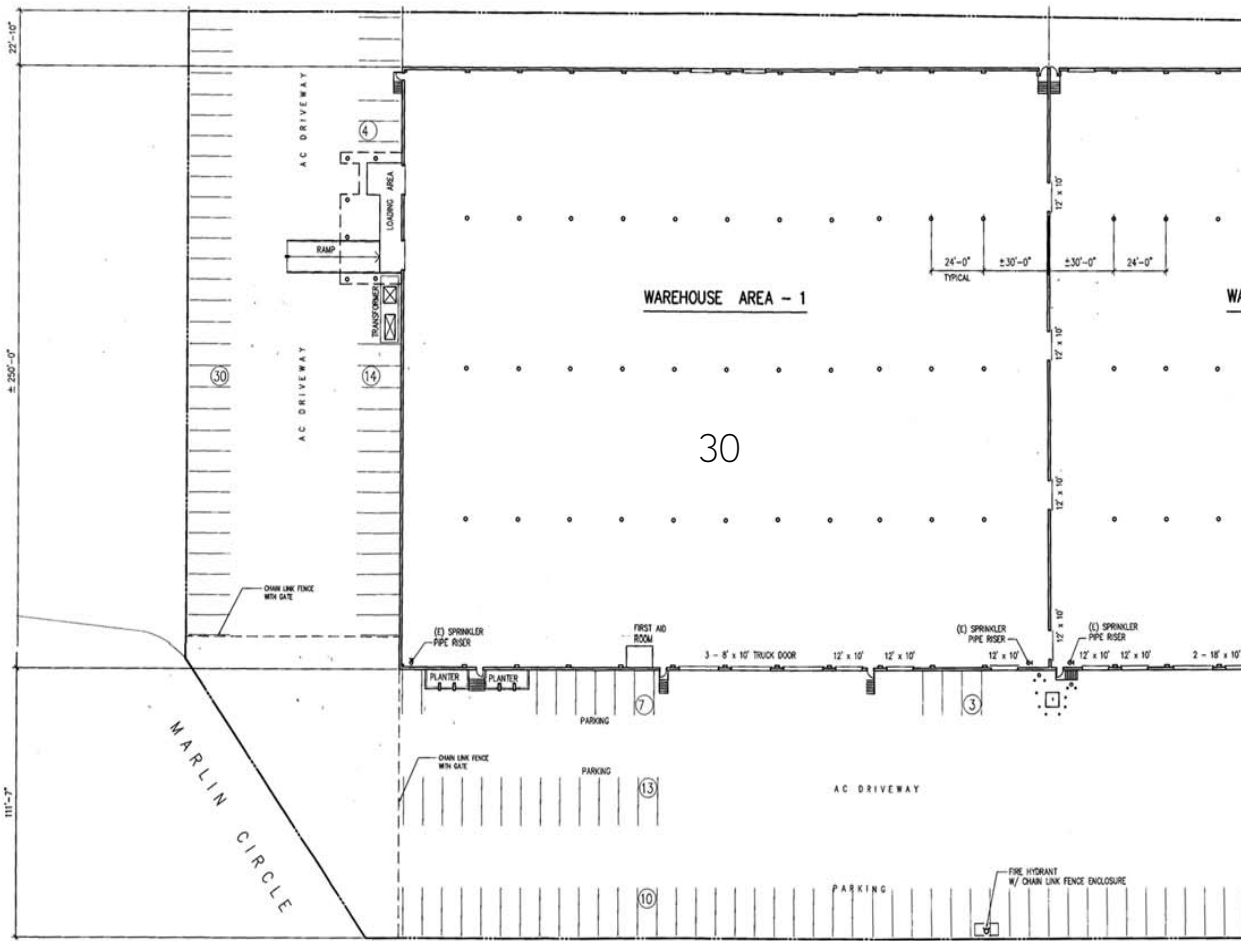

- Total SF: 75,000 SF
- Available 08/01/2018
- (91) Freeway Frontage
- 10 Dock High Positions with Load Levelers
- Large Yard
- Up to 80 Car Parking Spaces
- Clear Height: 22'

**JEFF SMART**

*Executive Vice President*

License No. 00918873

+1 310 321 1812

jeffrey.smart@colliers.com

**GRACE YI**

*Senior Associate*

License No. 01837630

+1 310 321 1830

grace.yi@colliers.com