

FOR LEASE >



INDUSTRIAL BUILDING WITH YARD

833 1ST AVE S | KENT, WASHINGTON



AVAILABILITY AND FEATURES

- » 19,000 SF
- » ±2,500 SF of nice two story office
- » Approximately 1 AC asphalt laydown yard
- » 2 oversized grade-level door
- » 3 dock high doors
- » 800 amp, 230/480 volt, 3 phase
- » Minutes from SR-167
- » Concrete tilt up
- » Drive thru capability
- » \$17,000/month + NNN Blended - Office - Yard

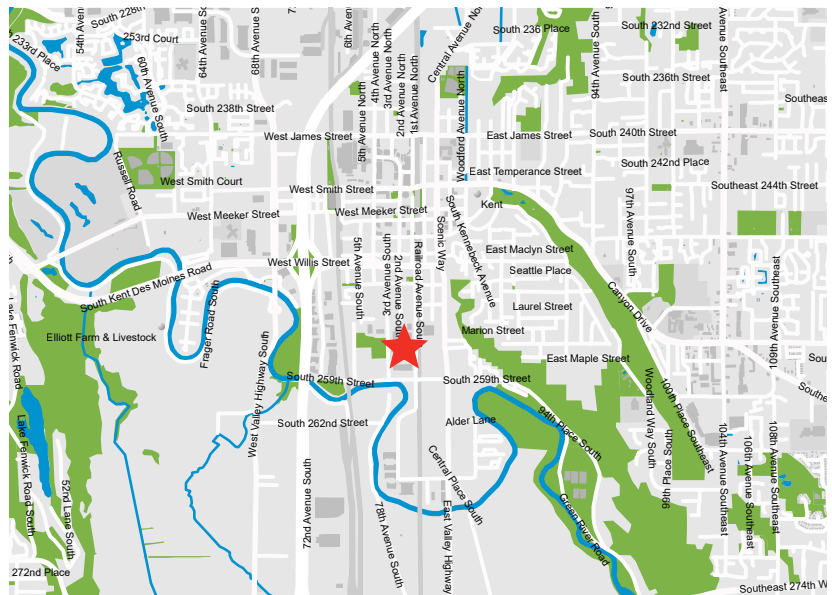

SCOTT ALAN, SIOR
Senior Vice President
dir + 1 206 515 4490
scott.alan@colliers.com

ARVIN VANDER VEEN, SIOR
Senior Vice President
dir + 1 206 654 0521
arvin.vanderveen@colliers.com

COLLIERS INTERNATIONAL
601 Union Street, Suite 5300
Seattle, WA 98101
www.colliers.com

FOR LEASE >



INDUSTRIAL BUILDING WITH YARD

833 1ST AVE S | KENT, WASHINGTON

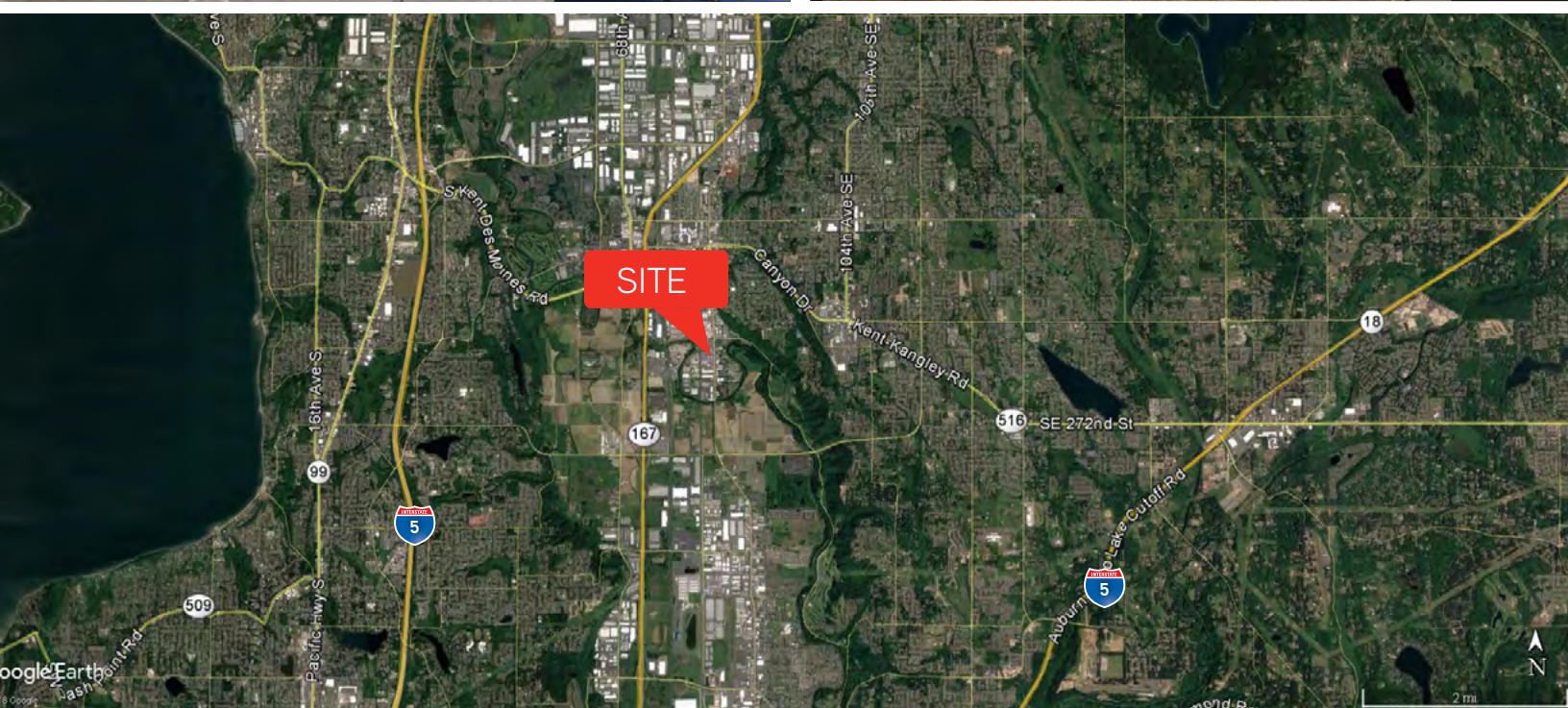

This document has been prepared by Colliers International for advertising and general information only. Colliers International makes no guarantees, representations or warranties of any kind, express or implied, regarding the information including, but not limited to, warranties of content, accuracy and reliability. Any interested party should undertake their own inquiries as to the accuracy of the information. Colliers International excludes unequivocally all inferred or implied terms, conditions and warranties arising out of this document and excludes all liability for loss and damages arising there from. Colliers International is a worldwide affiliation of independently owned and operated companies. This publication is the copyrighted property of Colliers International and /or its licensors(s). © 2018. All rights reserved.

SCOTT ALAN, SIOR
Senior Vice President
dir + 1 206 515 4490
scott.alan@colliers.com

ARVIN VANDER VEEN, SIOR
Senior Vice President
dir + 1 206 654 0521
arvin.vanderveen@colliers.com

COLLIERS INTERNATIONAL
601 Union Street, Suite 5300
Seattle, WA 98101
www.colliers.com