

REDEVELOPMENT OPPORTUNITY

colliers.com/greaterphoenix

Premier Hard Corner For Sale in Tempe

SEC University Drive & Roosevelt Street
527 W University Drive & 815 S Roosevelt Street | Tempe, Arizona 85281

HIGHLIGHTS

- Hard corner lot on lighted intersection with frontage on University Drive
- Adjacent to Arizona State University, which boasts the 6th highest undergraduate enrollment in the country according to U.S. News and almost 52,000 students currently enrolled at the Tempe campus location
- Rare investment opportunity
- Future redevelopment site
- Located 2 blocks west of the intersection of Mill Avenue and University Drive, the epicenter of Tempe with over 53,000 vehicles per day

Contact us:

Stan Sanchez

Senior Vice President

+1 602 222 5032

stan.sanchez@colliers.com

For Sale:

Call for pricing



This document has been prepared by Colliers International for advertising and general information only. Colliers International makes no guarantees, representations or warranties of any kind, expressed or implied, regarding the information including, but not limited to, warranties of content, accuracy and reliability. Any interested party should undertake their own inquiries as to the accuracy of the information. Colliers International excludes unequivocally all inferred or implied terms, conditions and warranties arising out of this document and excludes all liability for loss and damages arising there from. This publication is the copyrighted property of Colliers International and/or its licensor(s). ©2018. All rights reserved.

Colliers International
2390 E Camelback Rd | Suite 100
Phoenix, AZ 85016
P: +1 602 222 5000
www.colliers.com/greaterphoenix

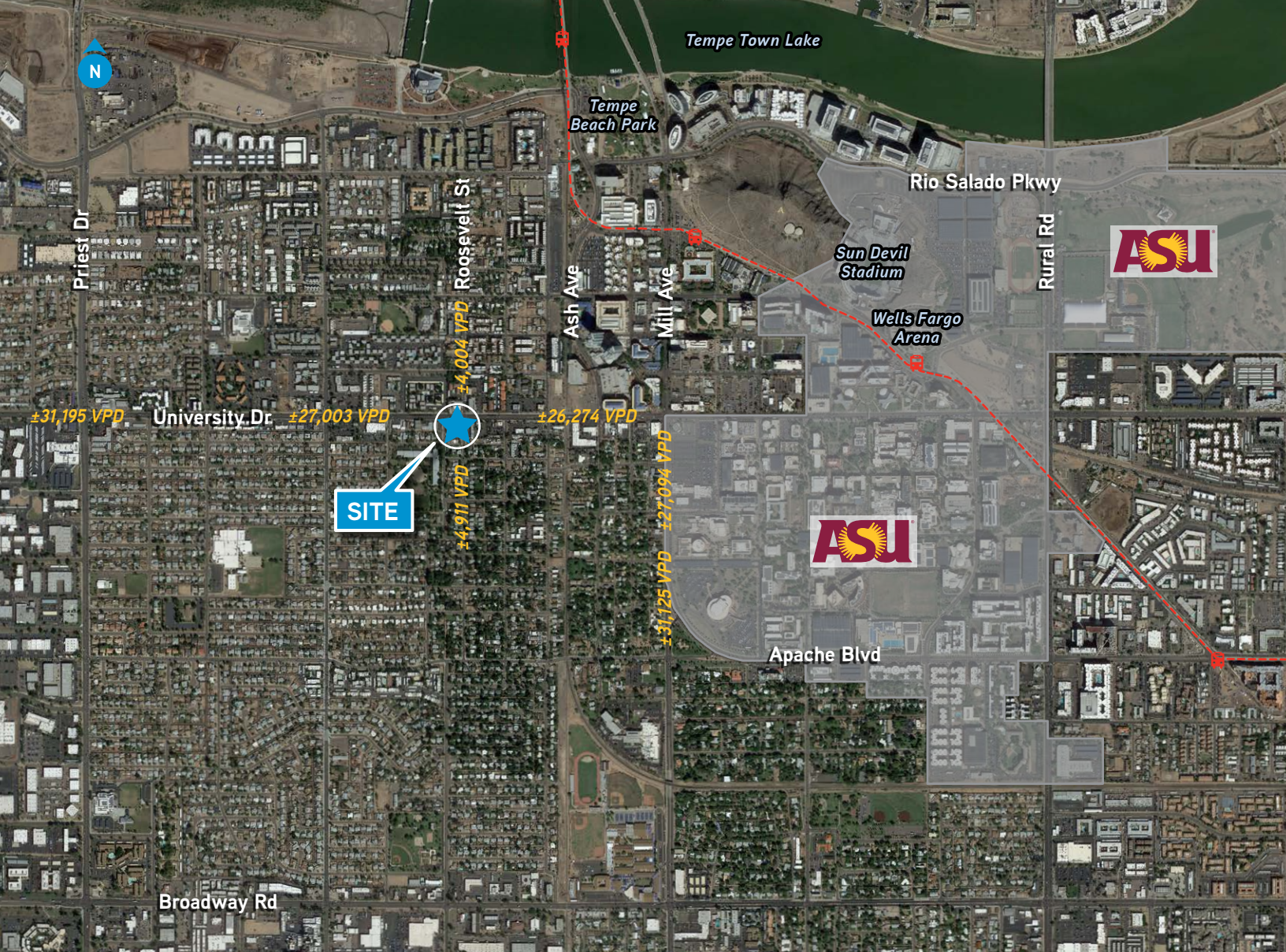

Specifications

| | |
|----------------------------|--|
| Addresses | 527 W University Dr 815 S Roosevelt St Tempe, AZ 85281 |
| Size | ±24,012 SF (±0.55 Acres) |
| Parcel Numbers & Zoning | 124-69-049 CSS 124-69-050 CSS 124-69-125 R-3 |
| Access | University Dr & Roosevelt St |
| Suggested Use | Future Mixed-Use Property |

Area Demographics

| | 1-MILE | 3-MILE | 5-MILE |
|---------------------------------|---------------|---------------|---------------|
| Total Population | 19,421 | 114,824 | 333,607 |
| Average Household Income | \$52,985 | \$53,550 | \$60,238 |
| Median Household Income | \$37,111 | \$40,119 | \$43,702 |
| Daytime Population | 37,786 | 185,366 | 453,995 |
| Median Age | 23.4 years | 26.2 years | 29.8 years |



Accelerating success.



527 W University Dr
815 S Roosevelt St



WALK SCORE



80

Very Walkable

TRANSIT SCORE



65

Good Transit

BIKE SCORE



98

Very Bikeable

*Source: Walkscore.com



colliers.com/greaterphoenix

Stan Sanchez
Senior Vice President
+1 602 222 5032
stan.sanchez@colliers.com



Colliers International
2390 E Camelback Rd | Suite 100
Phoenix, AZ 85016
P: +1 602 222 5000
www.colliers.com/greaterphoenix

Accelerating success.

This document has been prepared by Colliers International for advertising and general information only. Colliers International makes no guarantees, representations or warranties of any kind, expressed or implied, regarding the information including, but not limited to, warranties of content, accuracy and reliability. Any interested party should undertake their own inquiries as to the accuracy of the information. Colliers International excludes unequivocally all inferred or implied terms, conditions and warranties arising out of this document and excludes all liability for loss and damages arising there from. This publication is the copyrighted property of Colliers International and/or its licensor(s). ©2018. All rights reserved.