

FOR SUBLEASE > RETAIL

ANCHOR SPACE AT THE LOOP WEST

2671 W Osceola Pkwy | Kissimmee, FL 34741

Colliers
INTERNATIONAL

CONFIDENTIAL LISTING
PLEASE DO NOT DISTURB TENANT



Property Highlights

- > 95,278 SF Beall's anchor space for lease at The Loop West Shopping Center with almost 400,000 SF of retail tenants
 - > Co-tenancy includes JC Penney, TJ Maxx, Babies R Us, Books-A-Million and more
- > Term through 4/30/2022 with 5 - 5 year renewal options
- > Abutting "The Loop" shopping center with Kohl's, Ross, Michael's, Bed Bath & Beyond, Old Navy, Petco, Pier 1 and more
- > Trade area includes over 2.1 million SF of retail shops including recently opened "Crosslands" shopping center
- > Kissimmee / St. Cloud and South Orange County is one of the most robust residential markets in the U.S. with 166 active/new subdivisions (Q1 2016)
- > Traffic counts on Osceola Parkway reach nearly 20,000 vehicles per day and over 14,000 vehicles per day on Dyer Blvd. John Young Parkway traffic counts reach over 65,000 vehicles per day
- > Great monument signage and numerous directional parking lot signs.

Call For Details

Location

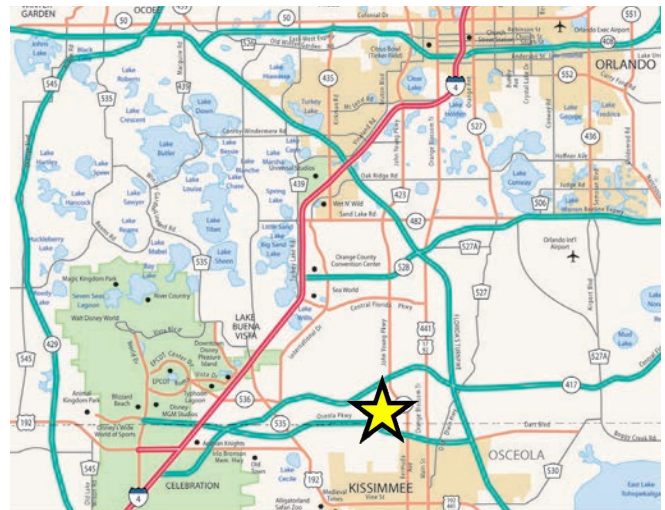

Contact Us

SCOTT CORBIN
Executive Managing Director
Retail Services
+1 407 362 6164
scott.corbin@colliers.com

COLLIERS INTERNATIONAL
255 S Orange Ave.
Suite 1300
Orlando, FL 32803
www.colliers.com

MARKET AERIAL



FOR SUBLEASE > RETAIL

ANCHOR SPACE AT THE LOOP WEST

2671 W Osceola Pkwy | Kissimmee, FL 34741

Colliers
INTERNATIONAL

Site Plan

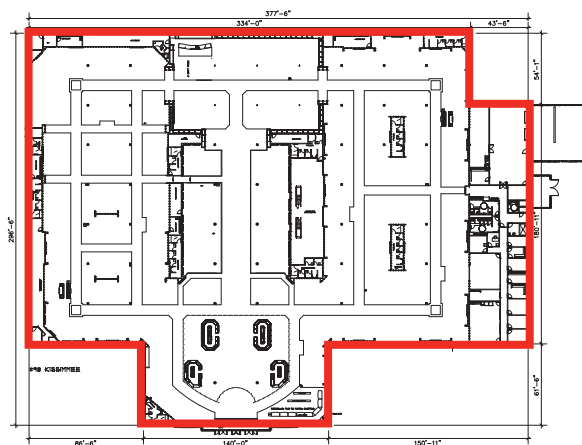

Demographics

	<u>3 Miles</u>	<u>5 Miles</u>	<u>10 Miles</u>	<u>20 Miles</u>
Total Population	77,659	196,947	415,003	1,453,108
Daytime Population	31,727	83,152	298,135	801,643
Households	27,273	65,527	138,967	523,345
Average HH Income	\$58,003	\$56,551	\$63,203	\$67,135