

Lease Rate  
\$13.00<sub>psf gross</sub>

## 12 Highwood Avenue Southington, CT 06489

±14,710 sf industrial building  
on ±1.18 acres for lease

12 Highwood Avenue a ±14,710 sf single-story industrial property on ±1.18 acres. There are spaces available ranging from 200 square feet to 14,710 square feet. Boat and vehicle space available at \$100/space.

SUITE	RSF	RATE	AVAILABLE
2	1,421	\$1500/mo.	Immediately
3 & 4	824	\$13.00	Immediately
5	Up to 6,000	Negotiable	30-Days
7	782	\$13.00	30-Days
9	867	\$13.00	Rented
11	867	\$13.00	Immediately
12	726	\$13.00	Immediately
13	203	\$13.00	45-Days
14	203	\$13.00	45-Days

### Christian Dietz

860 616 4028 direct  
860 877 5880 cell  
christian.dietz@colliers.com

864 Wethersfield Avenue  
Hartford, CT 06114  
860 249 6521 Main

[colliers.com/hartford](https://colliers.com/hartford)

Copyright © 2025 Colliers International. Information herein has been obtained from sources deemed reliable, however its accuracy cannot be guaranteed. The user is required to conduct their own due diligence and verification.

# 12 Highwood Avenue Floor Plan



1 EXISTING FLOOR PLAN  
SK.1 SCALE: 3/16"=1'-0"



## Contact:

**Christian Dietz**

860 616 4028 direct

860 877 5880 cell

[christian.dietz@colliers.com](mailto:christian.dietz@colliers.com)

864 Wethersfield Avenue

Hartford, CT 06114

860 249 6521 Main

[colliers.com/hartford](http://colliers.com/hartford)

# 12 Highwood Avenue

## Floor Plan

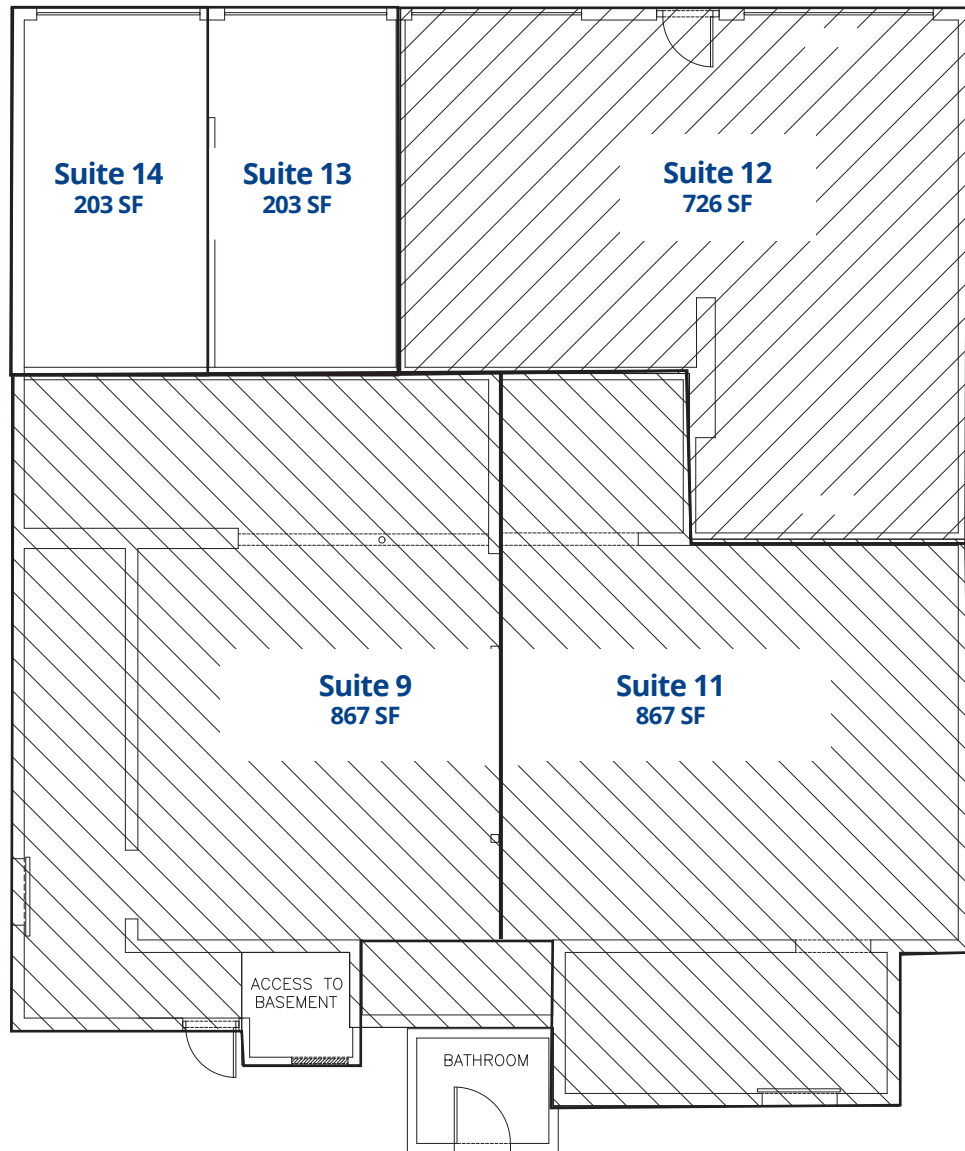

2,823 TOTAL SQUARE FEET



### Contact:

**Christian Dietz**

860 616 4028 direct

860 877 5880 cell

[christian.dietz@colliers.com](mailto:christian.dietz@colliers.com)

864 Wethersfield Avenue

Hartford, CT 06114

860 249 6521 Main

[colliers.com/hartford](http://colliers.com/hartford)