

FOR LEASE > INDUSTRIAL SPACE

# 349 Lake Road

KILLINGLY, CT 06241

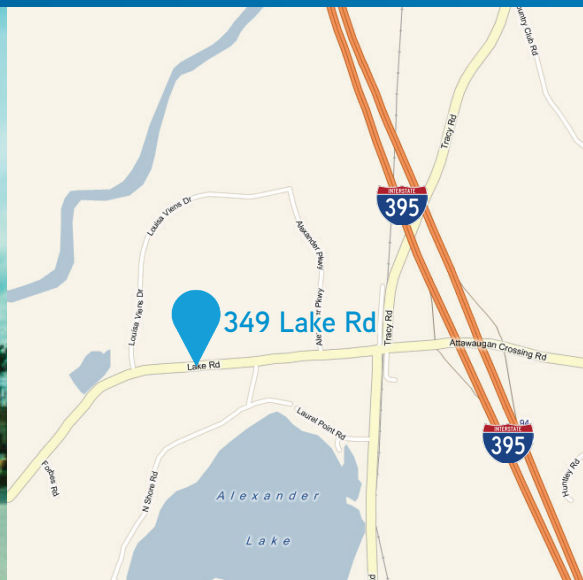

## 349 Lake Road > Industrial Space

349 Lake Road is a 210,000 SF, one-story industrial building on +/-20 acres of land in Killingly, CT with 60,000 SF available for lease including four loading docks and one drive-in-door.

## Building Amenities

- > 60,000 SF industrial space for lease
- > 8,000 SF of air-conditioned office space & fully sprinklered
- > Immediate access to I-395
- > 1,300 amp service & 17' ceiling height

**Lease Rate: \$3.95/SF NNN**

### DIRECTIONS

From Hartford, take Exit 69 off I-84 East toward Willington. Turn right on Tolland Turnpike and keep right. Turn left onto SR-32. Turn right on Tolland Turnpike. Bear left onto US\_44. Turn left on Lake Road. The property is on the left.

KEITH J. KUMNICK, SIOR  
860 616 4019  
HARTFORD, CT  
keith.kumnick@colliers.com

NICHOLAS R. MORIZIO, CRE, SIOR  
860 616 4022  
HARTFORD, CT  
nicholas.morizio@colliers.com

COLLIERS INTERNATIONAL  
864 Wethersfield Avenue  
Hartford, CT 06114  
www.colliers.com

## 349 Lake Road > Floor Plan

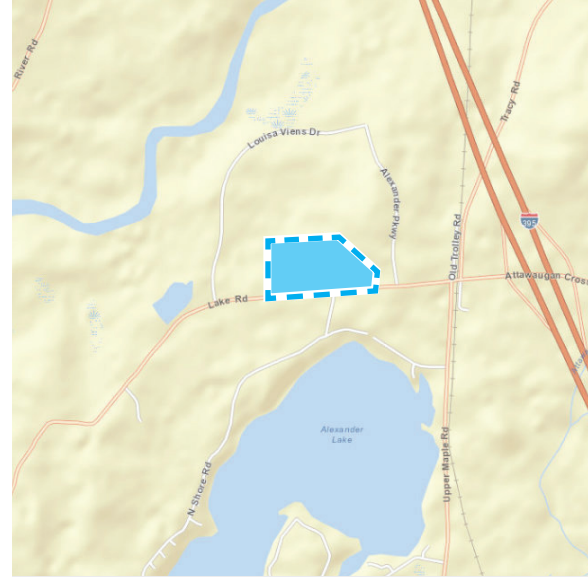
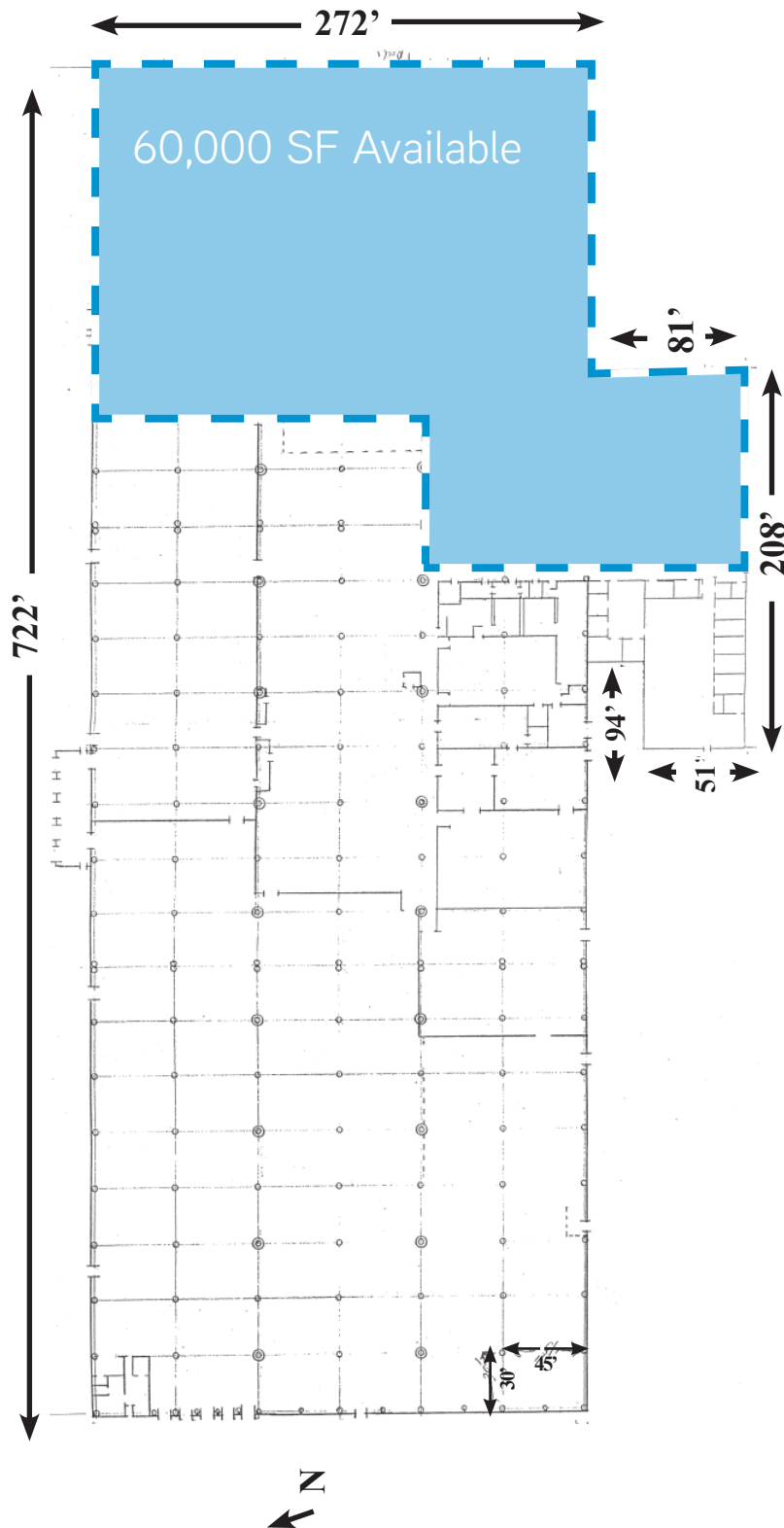

## Contact Us

KEITH J. KUMNICK, SIOR

860 616 4019

HARTFORD, CT

[keith.kumnick@colliers.com](mailto:keith.kumnick@colliers.com)

NICHOLAS R. MORIZIO, CRE, SIOR

860 616 4022

HARTFORD, CT

[nicholas.morizio@colliers.com](mailto:nicholas.morizio@colliers.com)

COLLIERS INTERNATIONAL

864 Wethersfield Avenue

Hartford, CT 06114

860 249 6521 Main

860 247 4067 Fax

[www.colliers.com/hartford](http://www.colliers.com/hartford)