

FOR LEASE > OFFICE BUILDING



The Barlow Building

SAVANNAH QUARTERS, POOLER, GA 31322

Construction Complete | Ready for tenant improvements NOW!



Listing Details

- > ±5,000 RSF on the ground floor (divisible to ±2,500 RSF) of a new two-story office building on ±1.23 acres
- > Construction is complete and the space is ready for tenant improvements NOW
- > The Barlow Building is located at the entrance of Savannah Quarters off Blue Moon Crossing
- > The site is a part of a development known as the Village at Savannah Quarters, a ±2,500 acre planned unit development that includes over 3,222 single-family homes, 1,178 multi-family units, retail, and office
- > Site is located adjacent to the new Publix Supermarket
- > Two-story class A construction with a flexible space plan available

LEASE RATE: \$25.00/SF, Full Service

ASHLEY W. SMITH SIOR CCIM
912 662 8011
SAVANNAH, GA
ashley.smith@colliers.com

COLLIERS INTERNATIONAL
545 E. York Street
Savannah, GA 31401
www.colliers.com

FOR LEASE > OFFICE BUILDING

The Barlow Building

SAVANNAH QUARTERS, POOLER, GA 31322

Floor Plans | FIRST FLOOR

Construction Complete | Ready for tenant improvements NOW!

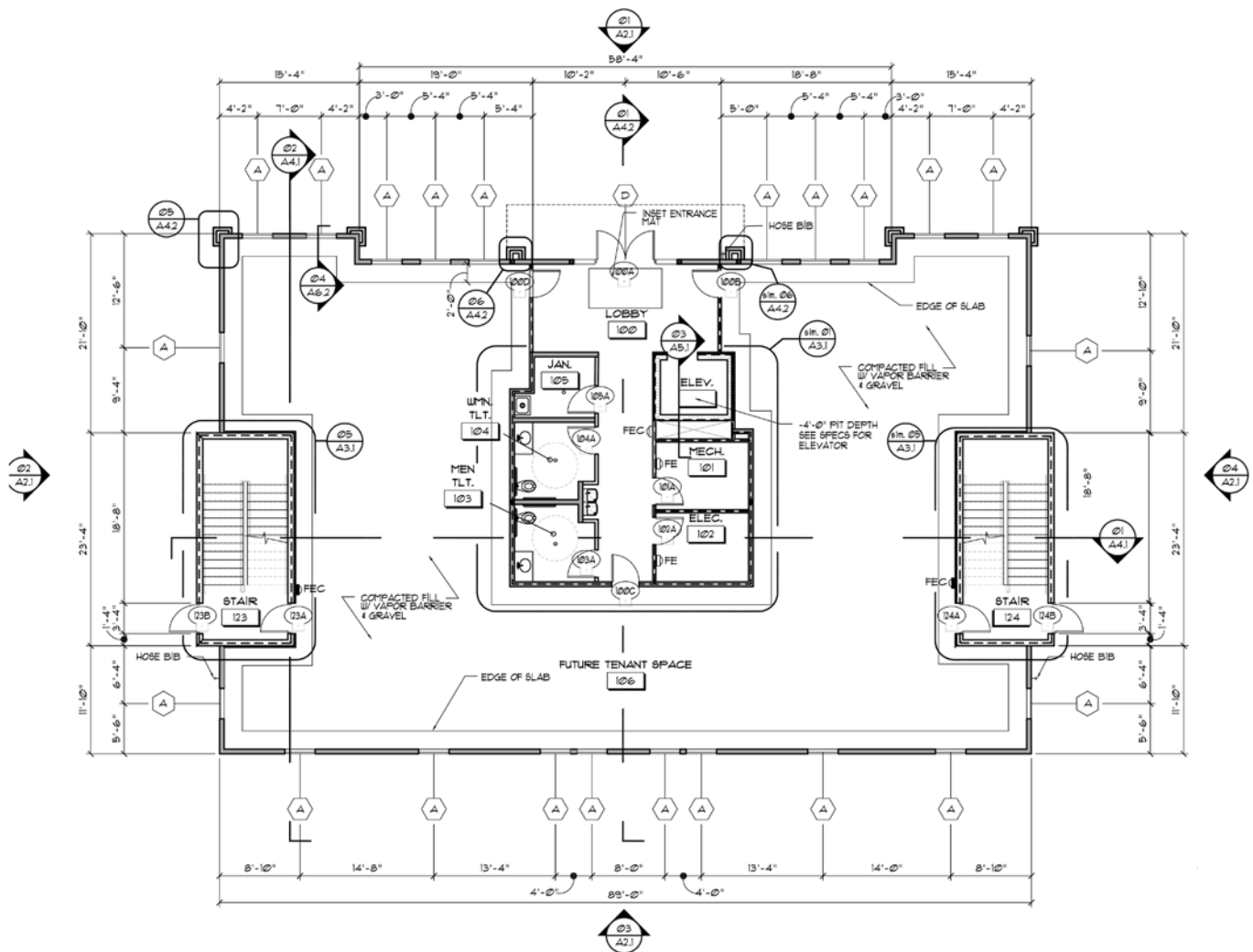

ASHLEY W. SMITH SIOR CCIM
912 662 8011
SAVANNAH, GA
ashley.smith@colliers.com

COLLIERS INTERNATIONAL
545 E. York Street
Savannah, GA 31401
www.colliers.com

FOR LEASE > OFFICE BUILDING

The Barlow Building

SAVANNAH QUARTERS, POOLER, GA 31322



ASHLEY W. SMITH SIOR CCIM
912 662 8011
SAVANNAH, GA
ashley.smith@colliers.com

COLLIERS INTERNATIONAL
545 E. York Street
Savannah, GA 31401
www.colliers.com

FOR LEASE > OFFICE BUILDING

The Barlow Building

SAVANNAH QUARTERS, POOLER, GA 31322

The Village at Savannah Quarters | A ±2,500 AC PLANNED DEVELOPMENT



Demographics*

| DRIVE TIME | 5 MIN. | 10 MIN. | 15 MIN. | TRAFFIC COUNTS** | |
|---------------------|----------|----------|----------|---------------------|-------------------------|
| Population > | 2,216 | 16,949 | 38,807 | Pooler Parkway > | 10,800 vehicles per day |
| Households > | 900 | 6,027 | 14,580 | **Source: GDOT 2016 | |
| Avg. HH Income > | \$86,882 | \$83,143 | \$81,725 | | |
| Med. HH Income > | \$65,590 | \$66,434 | \$62,676 | | |
| Total No. of Bus. > | 16 | 181 | 1,430 | | |

*Source: US Census 2016

ASHLEY W. SMITH SIOR CCIM
912 662 8011
SAVANNAH, GA
ashley.smith@colliers.com

The information contained herein has been obtained from sources deemed reliable. While every reasonable effort has been made to ensure its accuracy, we cannot guarantee it. No responsibility is assumed for any inaccuracies. Readers are encouraged to consult their professional advisers prior to acting on any of the material contained in this report.

COLLIERS INTERNATIONAL
545 E. York Street
Savannah, GA 31401
www.colliers.com

FOR LEASE > OFFICE BUILDING

The Barlow Building

SAVANNAH QUARTERS, POOLER, GA 31322

Construction Complete | Ready for tenant improvements NOW!



ASHLEY W. SMITH SIOR CCIM
912 662 8011
SAVANNAH, GA
ashley.smith@colliers.com

The information contained herein has been obtained from sources deemed reliable. While every reasonable effort has been made to ensure its accuracy, we cannot guarantee it. No responsibility is assumed for any inaccuracies. Readers are encouraged to consult their professional advisers prior to acting on any of the material contained in this report.

