

FOR LEASE > RETAIL



938 MARKET STREET

MID MARKET/UNION SQUARE | SAN FRANCISCO

- Less than one block from highly-trafficked Powell Street cable car turnaround and BART station
- Retail neighbors include Nordstrom Rack, Saks Off 5th, and Westfield San Francisco Centre
- Excellent opportunity for coffee, café, or grab-and-go food



ANN NATUNEWICZ

LIC. #01935970

415 288 7880

ann.natunewicz@colliers.com

NADINE WHISNANT

LIC. # 00966437

510 433 5858

nadine.whisnant@colliers.com

COLLIERS INTERNATIONAL
101 Second Street, 11th Floor
San Francisco, CA 94105
www.colliers.com

FOR LEASE > RETAIL

938 MARKET STREET

MID MARKET/UNION SQUARE | SAN FRANCISCO



ANN NATUNEWICZ

LIC. #01935970

415 288 7880

ann.natunewicz@colliers.com

NADINE WHISNANT

LIC. # 00966437

510 433 5858

nadine.whisnant@colliers.com

COLLIERS INTERNATIONAL
101 Second Street, 11th Floor
San Francisco, CA 94105
www.colliers.com

FOR LEASE > RETAIL

938 MARKET STREET

MID MARKET/UNION SQUARE | SAN FRANCISCO



Retail Premises

- > ±1,826 sq. ft. Ground
±262 sq. ft. Lower-level storage
- > High ceilings
- > 18' frontage

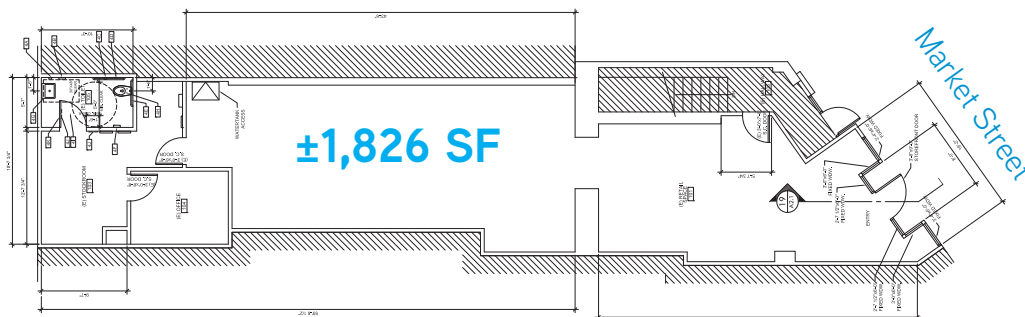

Contact

ANN NATUNEWICZ

Lic. #01935970
415 288 7880
ann.natunewicz@colliers.com

NADINE WHISNANT

Lic. #00966437
510 433 5858
nadine.whisnant@colliers.com

COLLIERS INTERNATIONAL
101 Second Street, 11th Floor
San Francisco, CA 94105

www.colliers.com

This marketing piece has been prepared by Colliers International for general information only. Information contained herein has been obtained from sources deemed reliable and no representation is made as to the accuracy thereof. Colliers International does not guarantee, warrant or represent that the information contained in this document is correct. Any interested party should undertake their own inquiries as to the accuracy of the information. Colliers International excludes unequivocally all inferred or implied terms, conditions and warranties arising out of this document and excludes all liability for loss and damages arising there from.

