

# FOR SALE

## 5.9± ACRE SITE ZONED I-L / I-G, CITY OF LATHROP



- **Acreage:** 5.9± Acres
- **Zoning:** I-L - I-G (City of Lathrop)
- **Sewer:** On site septic
- **Water:** Well
- **Storm Drain:** On site
- **Gas:** PG&E
- **Electric:** PG&E
- **General Information:**
  - 3,900± square foot residence and out buildings included and located on site.
  - Property fronts Westbound State Route 120 just East of Interstate 5 and is contiguous to the City of Lathrop, Union Pacific Railroad, Crossroads Commerce Center and proposed Lathrop Gateway Business Park.
- **Asking Price:** \$1,750,000

### 4100 Yosemite Avenue • Lathrop, CA 95330

#### Industrial Services Team - Exclusive Brokers:

**Gregory O'Leary, SIOR**  
Executive Vice President  
(209) 475-5108 Direct  
g.oleary@colliers.com  
CA License No. 00924479

**Mike Goldstein, SIOR**  
Executive Managing Director  
(209) 475-5106 Direct  
michael.goldstein@colliers.com  
CA License No. 01319234



3439 Brookside Road, Suite 108  
Stockton, CA 95219  
Tel: 209-475-5100  
Fax: 209-475-5102  
www.colliers.com



# FOR SALE

4100 YOSEMITE AVENUE • LATHROP, CA  
APPROXIMATELY 5.9± ACRE SITE



## Industrial Services Team - Exclusive Brokers:

**Gregory O'Leary, SIOR**  
Executive Vice President  
(209) 475-5108 Direct  
g.oleary@colliers.com  
CA License No. 00924479

**Mike Goldstein, SIOR**  
Executive Managing Director  
(209) 475-5106 Direct  
michael.goldstein@colliers.com  
CA License No. 01319234



3439 Brookside Road, Suite 108  
Stockton, CA 95219  
Tel: 209-475-5100  
Fax: 209-475-5102  
www.colliers.com

# CONCEPTUAL PLAN LOGISTICS & TRANSPORTATION FACILITY

4100 YOSEMITE AVENUE • LATHROP, CA  
APPROXIMATELY 5.9± ACRE SITE

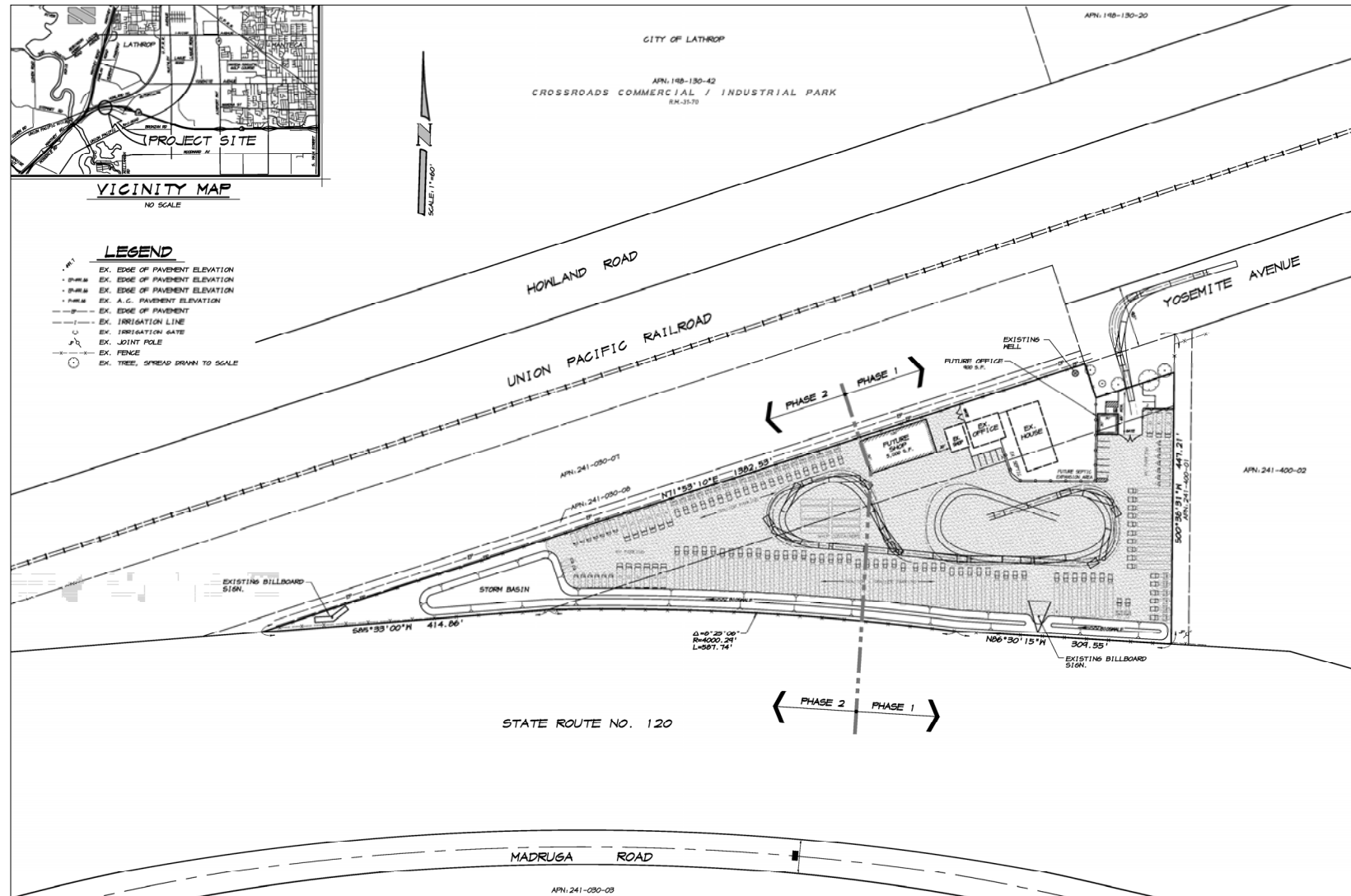

## Industrial Services Team - Exclusive Brokers:

**Gregory O'Leary, SIOR**  
Executive Vice President  
(209) 475-5108 Direct  
g.oleary@colliers.com  
CA License No. 00924479

**Mike Goldstein, SIOR**  
Executive Managing Director  
(209) 475-5106 Direct  
michael.goldstein@colliers.com  
CA License No. 01319234



3439 Brookside Road, Suite 108  
Stockton, CA 95219  
Tel: 209-475-5100  
Fax: 209-475-5102  
www.colliers.com



**4100 YOSEMITE AVENUE • LATHROP, CA**  
**APPROXIMATELY 5.9± ACRE SITE**





# FOR SALE

4100 YOSEMITE AVENUE • LATHROP, CA  
APPROXIMATELY 5.9± ACRE SITE



## Industrial Services Team - Exclusive Brokers:

**Gregory O'Leary, SIOR**  
Executive Vice President  
(209) 475-5108 Direct  
g.oleary@colliers.com  
CA License No. 00924479

**Mike Goldstein, SIOR**  
Executive Managing Director  
(209) 475-5106 Direct  
michael.goldstein@colliers.com  
CA License No. 01319234



3439 Brookside Road, Suite 108  
Stockton, CA 95219  
Tel: 209-475-5100  
Fax: 209-475-5102  
www.colliers.com



# FOR SALE

4100 YOSEMITE AVENUE • LATHROP, CA  
APPROXIMATELY 5.9± ACRE SITE

Regional Map



Location Map

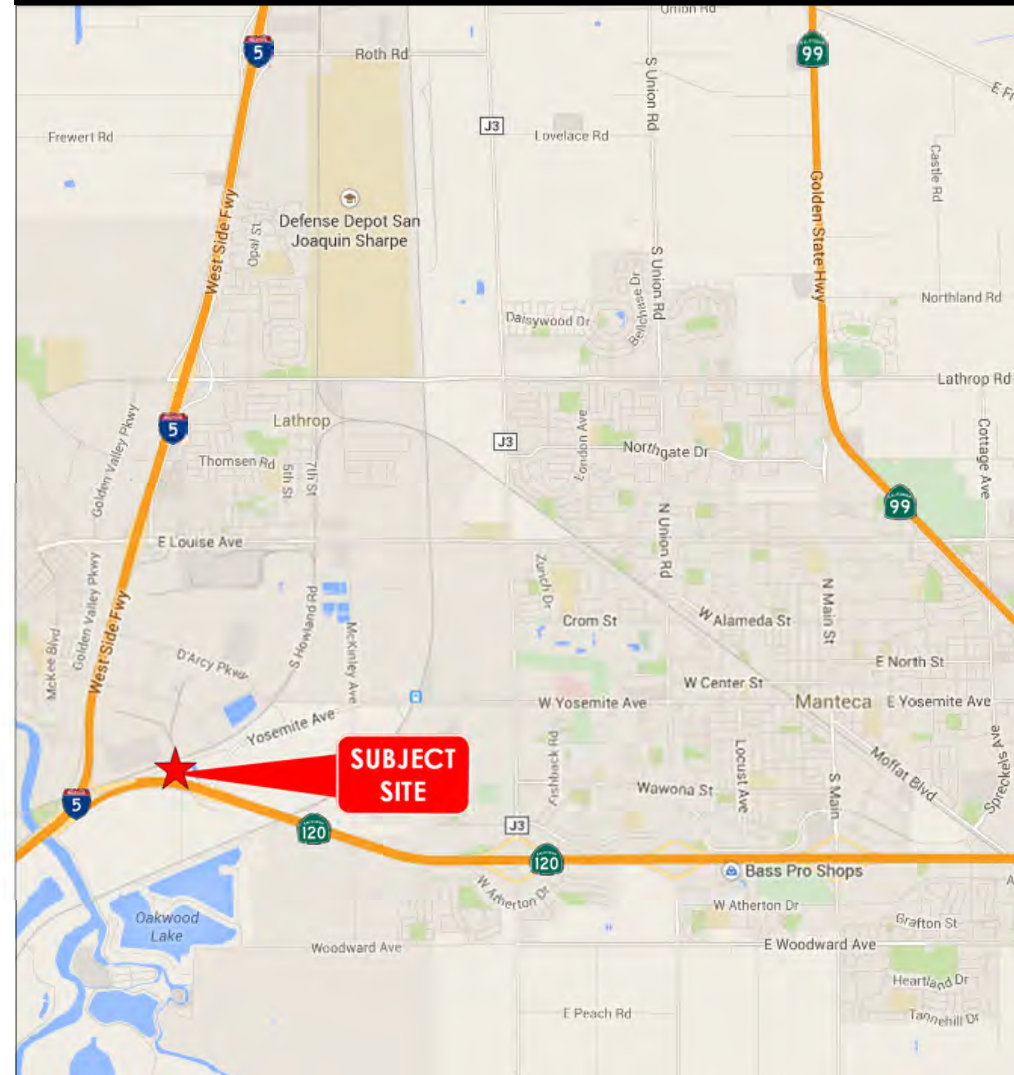

**Industrial Services Team - Exclusive Brokers:**

**Gregory O'Leary, SIOR**  
Executive Vice President  
(209) 475-5108 Direct  
g.oleary@colliers.com  
CA License No. 00924479

**Mike Goldstein, SIOR**  
Executive Managing Director  
(209) 475-5106 Direct  
michael.goldstein@colliers.com  
CA License No. 01319234



3439 Brookside Road, Suite 108  
Stockton, CA 95219  
Tel: 209-475-5100  
Fax: 209-475-5102  
www.colliers.com