

FOR SUBLEASE > OFFICE SPACE

Ion Solar Sublease/Co-working space



4801 N UNIVERSITY AVE , PROVO, UTAH, 84604



Property Information

- > 1,000-4,000 SF
- > 66 four-foot stations or 45 six-foot stations \$250/ Month per station
- > Co-working space
- > Located in the Riverwoods
- > Ample Parking
- > Close to many amenities and services

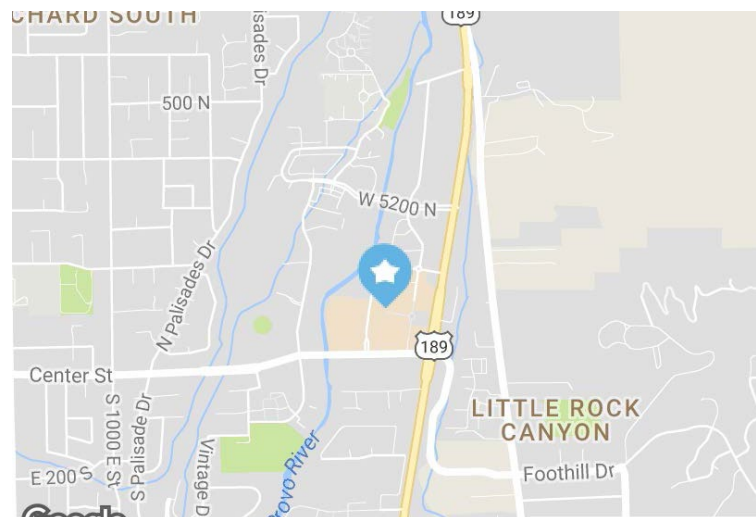

Cody Black
+1 801 687 0094
cody.black@colliers.com

Shad Webb
+1 435 459 0212
shad.webb@colliers.com

Colliers International
2100 Pleasant Grove Blvd. | Suite 200
Pleasant Grove, UT 84062
P: +1 801 610 1300

FOR SUBLEASE > OFFICE SPACE

Ion Solar Sublease/Co-working space

4801 N UNIVERSITY AVE , PROVO, UTAH, 84604



Colliers International
2100 Pleasant Grove Blvd. | Suite 200
Pleasant Grove, UT 84062
P: +1 801 610 1300



FOR SUBLEASE > OFFICE SPACE

Ion Solar Sublease/Co-working space

4801 N UNIVERSITY AVE , PROVO, UTAH, 84604

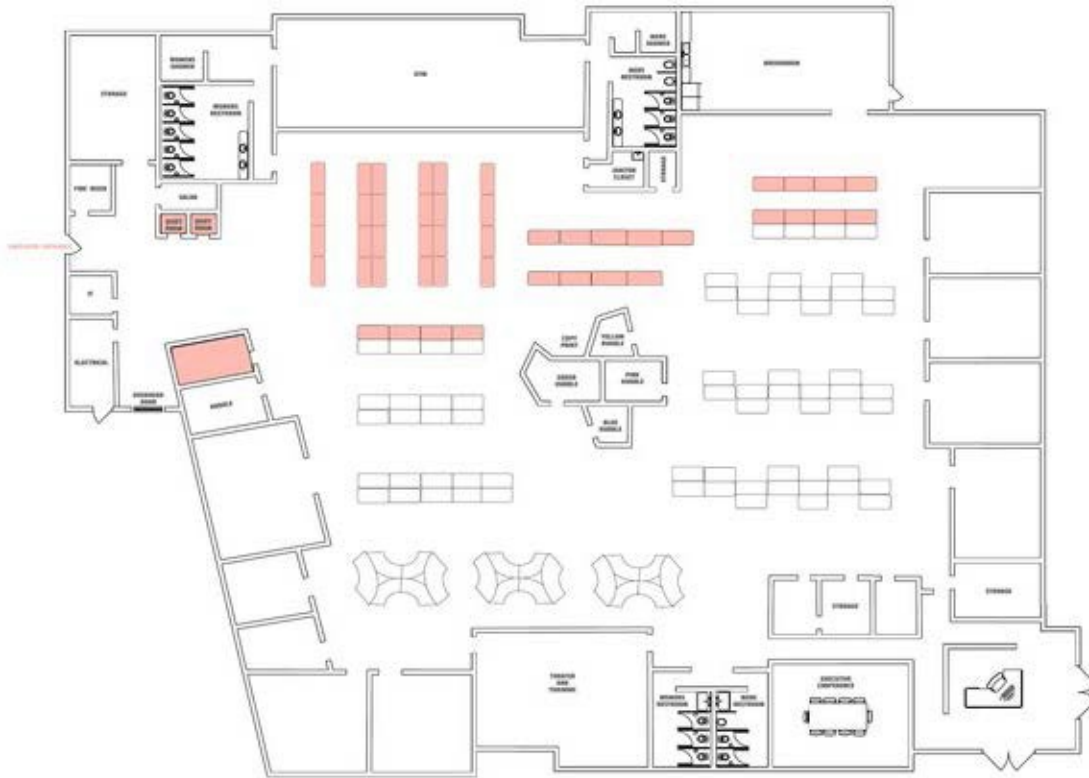

Colliers International
2100 Pleasant Grove Blvd. | Suite 200
Pleasant Grove, UT 84062
P: +1 801 610 1300



FOR SUBLEASE > OFFICE SPACE

Ion Solar Sublease/Co-working space

4801 N UNIVERSITY AVE , PROVO, UTAH, 84604

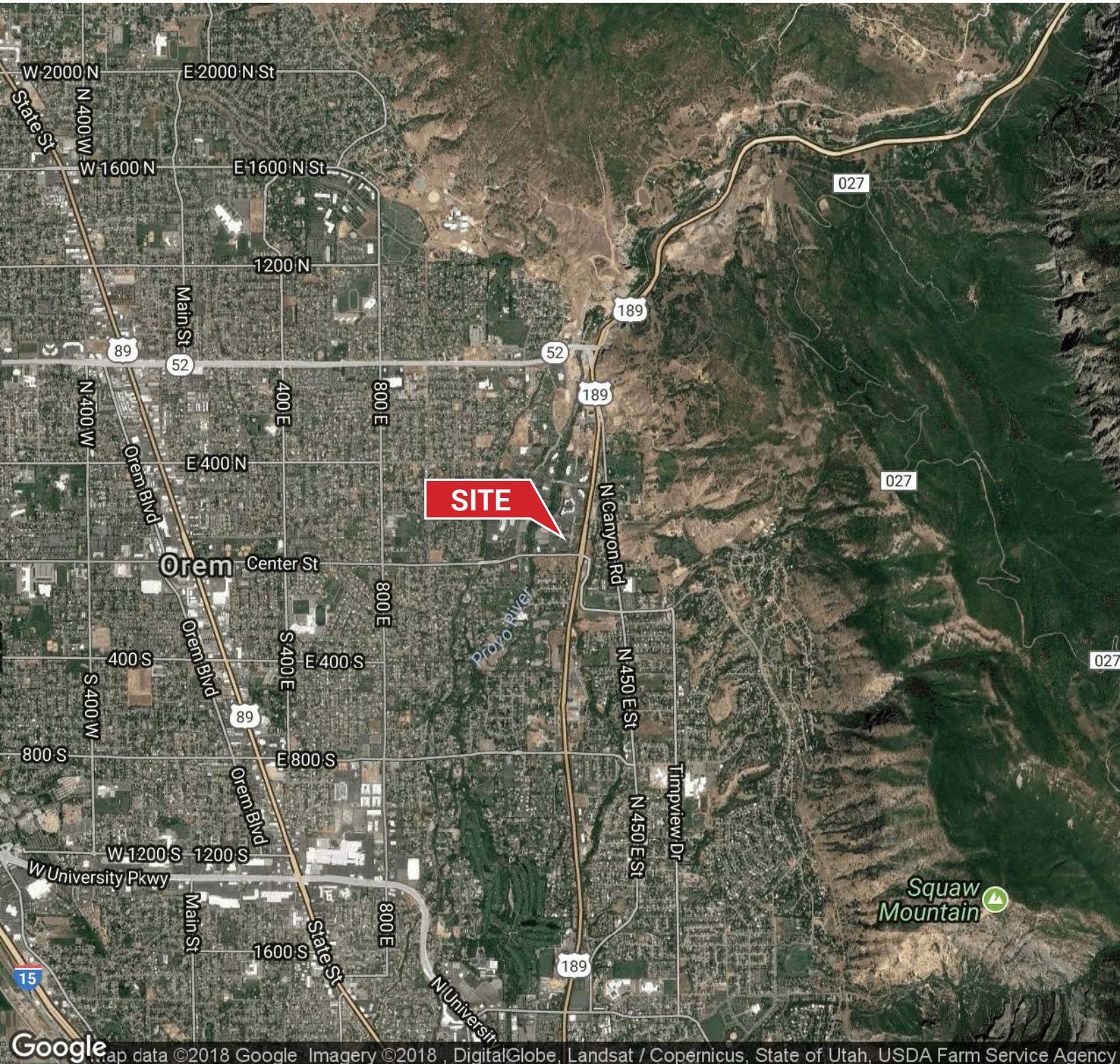

Google

Map data ©2018 Google Imagery ©2018 DigitalGlobe, Landsat / Copernicus, State of Utah, USDA Farm Service Agency

This document has been prepared by Colliers International for advertising and general information only. Colliers International makes no guarantees, representations or warranties of any kind, expressed or implied, regarding the information including, but not limited to, warranties of content, accuracy and reliability. Any interested party should undertake their own inquiries as to the accuracy of the information. Colliers International excludes unequivocally all inferred or implied terms, conditions and warranties arising out of this document and excludes all liability for loss and damages arising there from. This publication is the copyrighted property of Colliers International and/or its licensor(s). ©2017. All rights reserved.

Colliers International
2100 Pleasant Grove Blvd. | Suite 200
Pleasant Grove, UT 84062
P: +1 801 610 1300

