

AVAILABLE > 8,823 SF

5621 Howard Street

NILES, IL

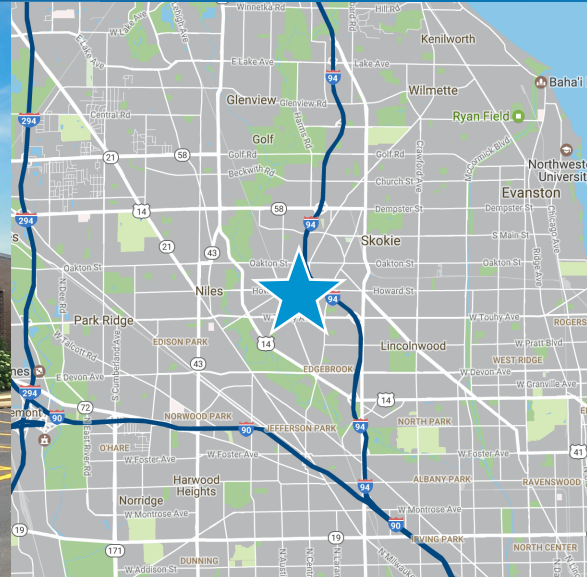

About This Property

- > Location: Howard Plaza IV
- > Space Available: 8,823 RSF
- > Office: 2,780 SF (32%)
- > Total Building Size: 64,969 SF
- > Construction: Masonry/Steel
- > Ceiling Height: 14' Clear
- > Loading: Two common interior depressed docks with levelers
- > HVAC: Office: Gas-fired forced air heat; roof top AC
- > Warehouse: Gas-fired hanging unit heaters
- > Electric Capacity: 400 Amps @ 208 volts
- > Sprinklers: Wet System
- > Taxes: 2018 Estimated \$2.74 PSF
- > CAM: 2018 Estimated \$1.05 PSF
- > Rental Rate: \$7,198.10 /month (\$6.00/SF Net)
- > Availability: Immediate
- > Public transportation on Howard Street
- > Gas & electric utilities are separately metered
- > ¼ mile west of Eden's Expressway (I-94)
- > On-site property management

Contact Us

BRENDAN C. GREEN
847 698 8227
brendan.green@colliers.com

CHRIS VOLKERT
847 698 8237
chris.volkert@colliers.com

B R E N N A N
I N V E S T M E N T
G R O U P

No warranty or representation is made to the accuracy of the foregoing information.
Terms of sale or lease and availability are subject to change or withdrawal without notice.

COLLIERS INTERNATIONAL
6250 N. River Road, Suite 11-100
Rosemont, IL 60018
www.colliers.com

5621 Howard Street > Floor Plan

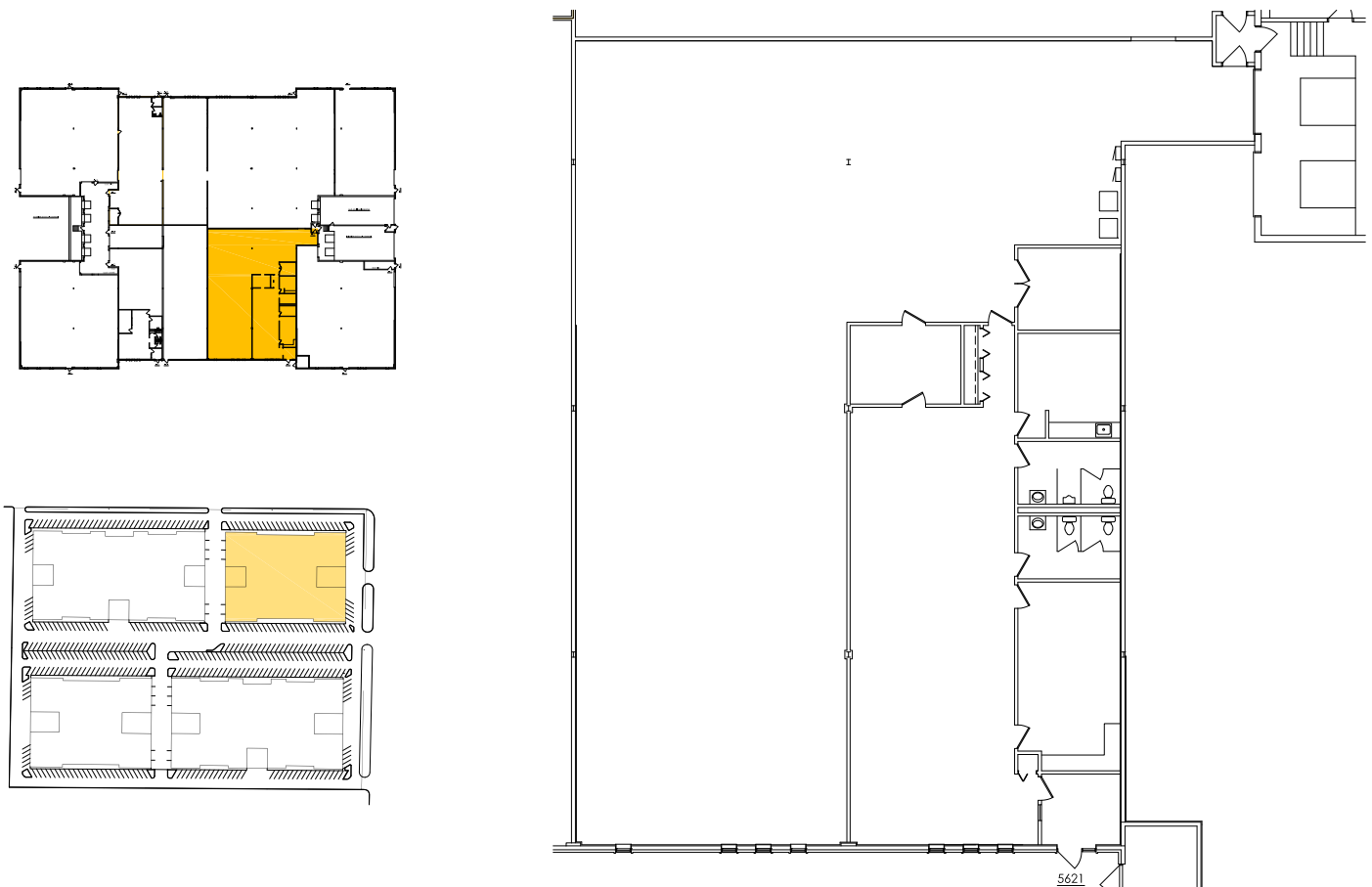

BRENDAN C. GREEN
847 698 8227
brendan.green@colliers.com

CHRIS VOLKERT
847 698 8237
chris.volkert@colliers.com

