

26533 Evergreen Road

Office Space For Sublease

33,786 Full Floor Sublease Opportunity

Southfield, Michigan





Impressive 13th Floor Views

Great Building Amenities

26533 Evergreen Road is Tower II of a 2-building Office Complex named Travelers Towers. The Sublease space encompasses the entire 13th Floor.

Sublease Features:

- 33,786 Rentable SF Available (Full Floor)
- Possibly Divisible to 8,000 ± SF
- Furniture Negotiable
- Sublease Rental Rate: \$14.00 SF Plus Electric
- Sublease Expiration Date: 5/31/2021

Building Amenities:

- Courtyard
- Conference Facility
- Laundry
- Onsite Management
- Security
- Covered Parking Available
- Lobby Recently Renovated

Complex Amenities:

- Fitness Facility
- Cafe
- Quick Service Sundry Shop
- Coden Florists



Central Southfield Location

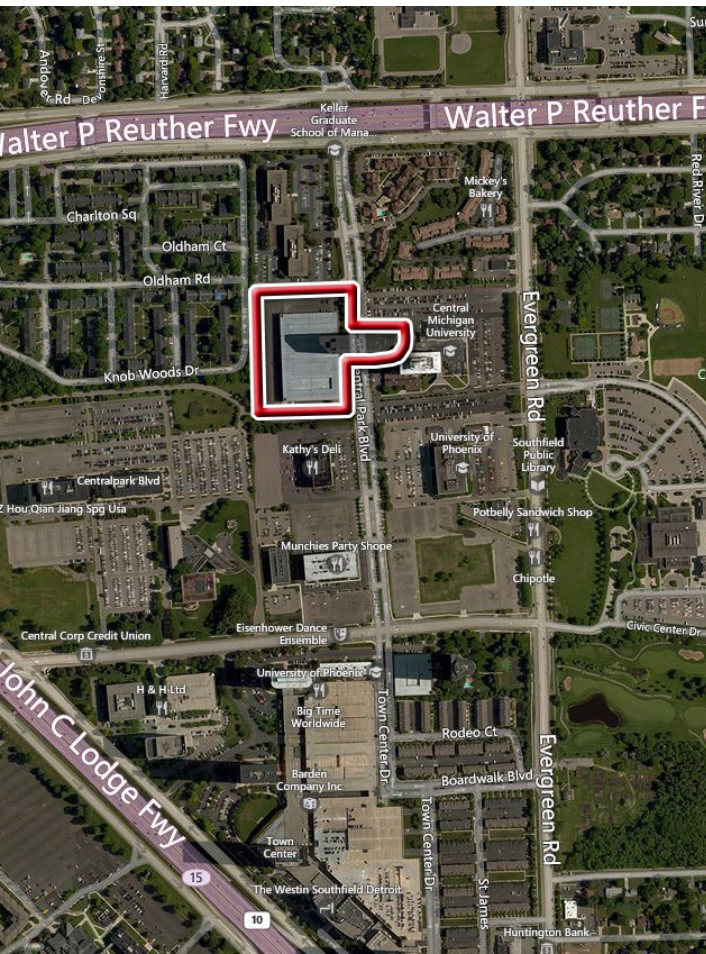

FLOOR PLAN

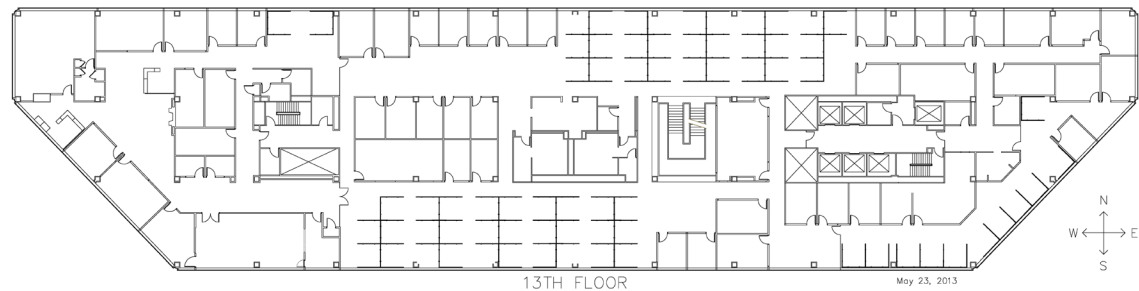

Within Walking Distance:

- TGI Friday's
- Potbelly's
- Beyond Juice
- Subway
- Chipotle
- Jimmy Johns

Please Contact Us for More Information or a Building Tour

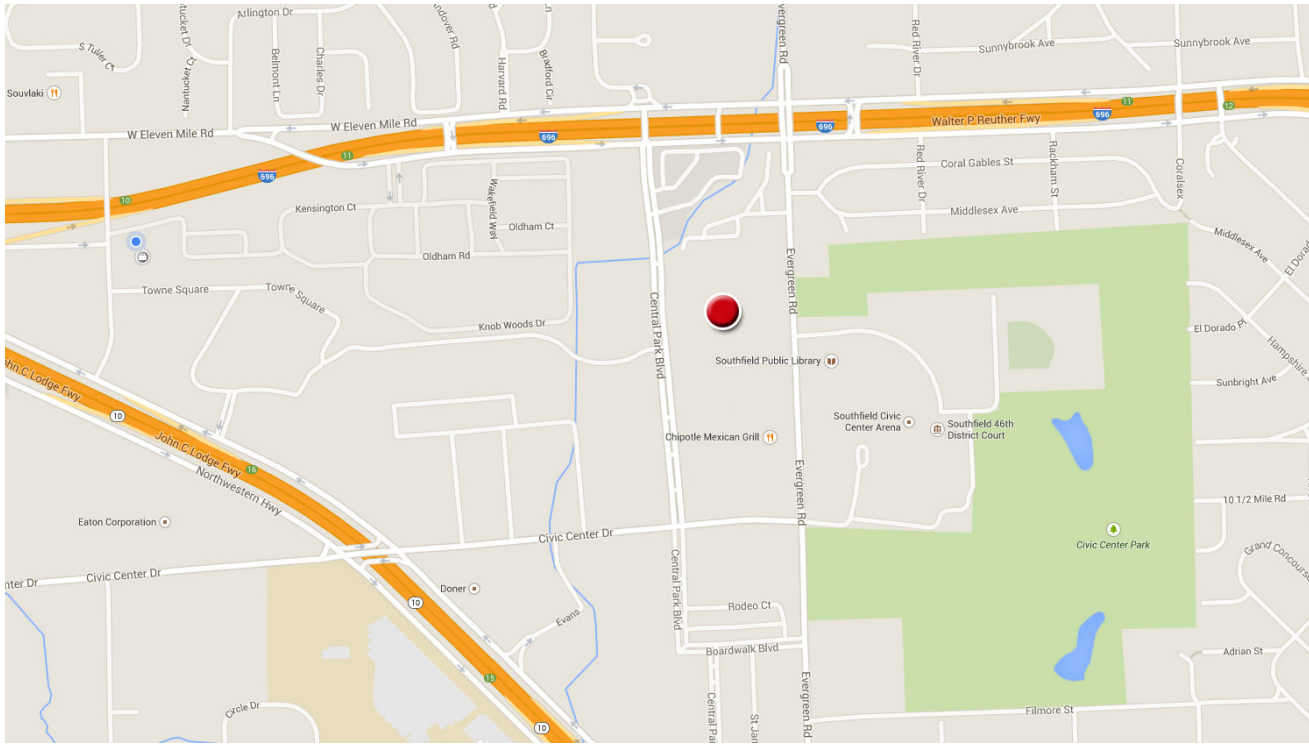

Located between 2 major highways, Travelers Tower II - 26533 Evergreen Road is perfectly positioned for any type of commuting to and from Southfield

FIRST FLOOR FITNESS FACILITY

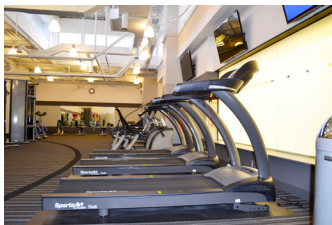

WORK STATIONS AND KITCHENETTE



26533 Evergreen Road

LEASING INFORMATION:

MIKE BENNETT, SIOR

Senior Vice President
+1 248 540 1000 | Ext. 1808
michael.bennett@colliers.com

GARY P. GROCHOWSKI, SIOR

Senior Vice President
+1 248 540 1000 | Ext. 1856
gary.grochowski@colliers.com

BRYAN BARNAS

Associate
+1 248 540 1000 | Ext. 1638
bryan.barnas@colliers.com



Colliers International | Detroit
2 Corporate Drive
Suite 300
Southfield, MI 48076

www.colliers.com

Information contained herein has been obtained from the owners or from other sources deemed reliable. We have no reason to doubt its accuracy, but we regret we can not guarantee it. All properties subject to change or withdrawal without notice. LEED®, and its related logo, is a trademark owned by the U.S. Green Building Council® and is used with permission