

# FOR LEASE »

## ±9,306 Square Feet

Colliers  
INTERNATIONAL



## 1550 S. LEWIS STREET | Anaheim, CA

### Property Features

- Located within the Anaheim Business Center. A Professionally Managed Business Park
- Excellent Freestanding Manufacturing/Warehouse Distribution Building
- ±1,480 Sq. Ft. of HVAC Office Area
- One (1) Ground Level Loading Door (10' x 12')
- Power: 400 Amps (verify)
- 16' Minimum Warehouse Ceiling Height
- Fully Fire Sprinklered (verify calculations)
- Anaheim Utility Benefits
- Excellent Anaheim Stadium Location
- Immediate Access to the Santa Ana (5), Orange (57) and Riverside (91) Freeways. Close Proximity to the Garden Grove (22) and Costa Mesa (55) Freeways.

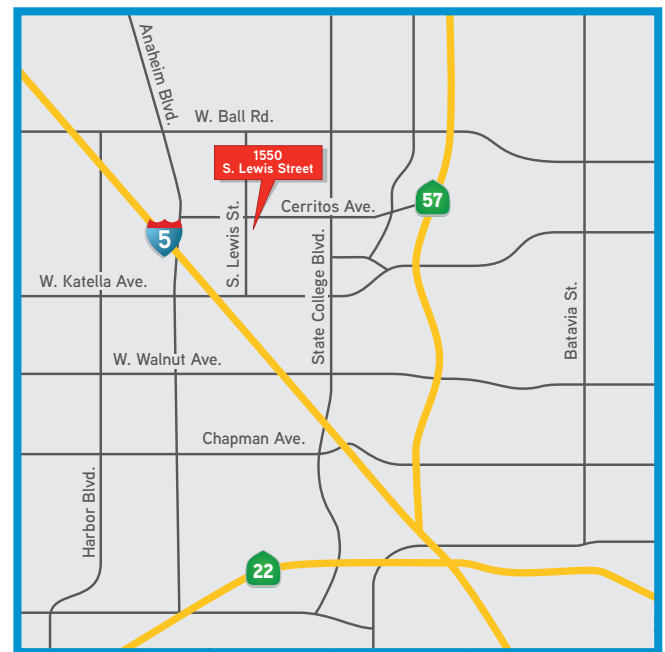

BRIAN CHASTAIN  
949 724 5520  
brian.chastain@colliers.com  
License No. 01835064

CHUCK WILSON  
949 724 5502  
chuck.wilson@colliers.com  
License No. 00947221

COLLIERS INTERNATIONAL  
3 Park Plaza, Suite 1200  
Irvine, CA 92614  
www.colliers.com

# FOR LEASE

±9,306 Square Feet

1550 South Lewis Street | Anaheim, CA

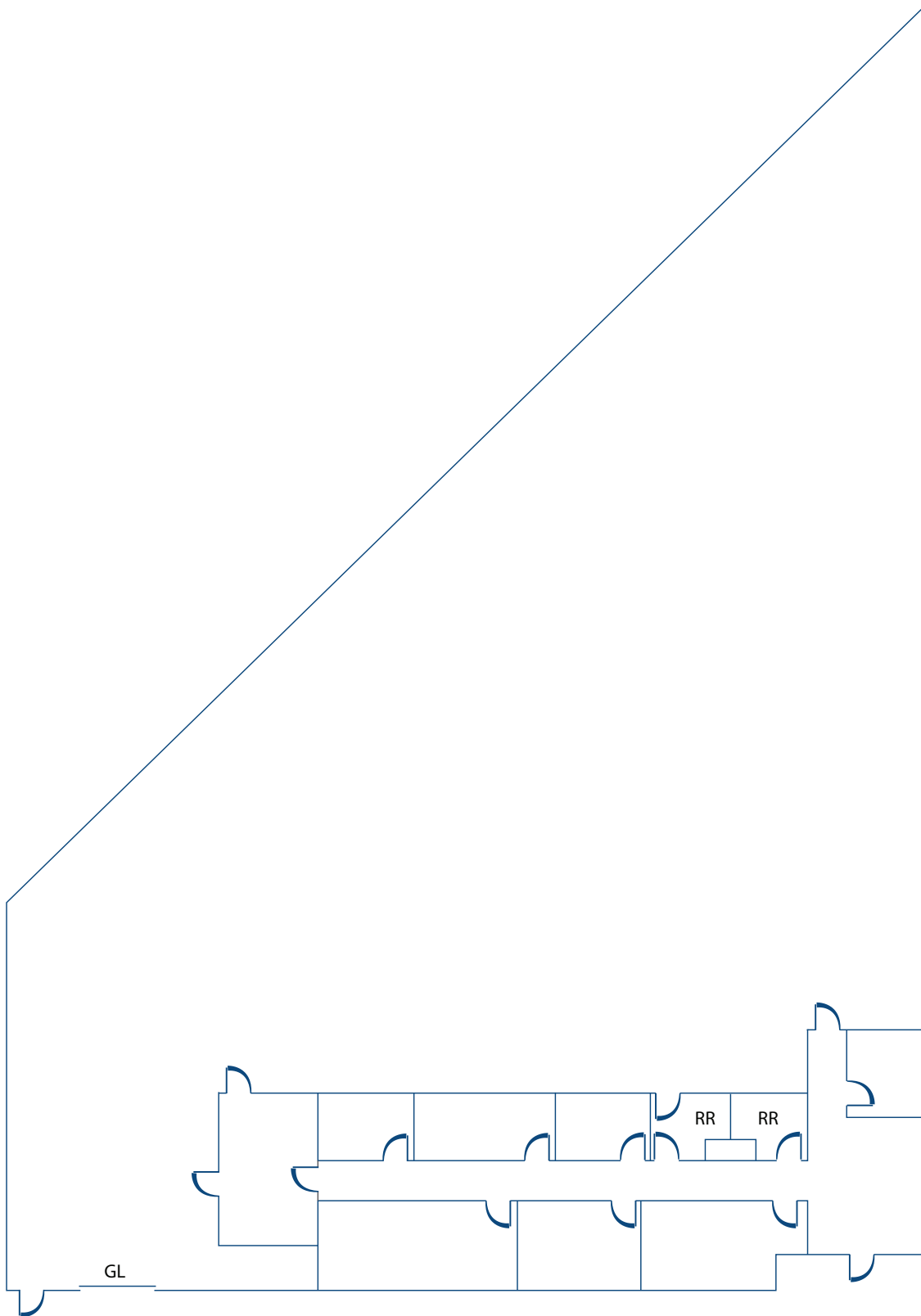

BRIAN CHASTAIN  
949 724 5520  
brian.chastain@colliers.com  
License No. 01835064

CHUCK WILSON  
949 724 5502  
chuck.wilson@colliers.com  
License No. 00947221

COLLIERS INTERNATIONAL  
3 Park Plaza, Suite 1200  
Irvine, CA 92614  
[www.colliers.com](http://www.colliers.com)