



Industrial For Lease

Pacific West Business Center, Bldg B

18868 72nd Ave S, Kent, WA 98032

PROPERTY HIGHLIGHTS

- 5,000 SF total
- 600 SF office
- 1 dock high door
- 22' clear height
- New roof as of June 2025
- Ample parking
- Great location with quick and easy access to Interstate 5 and Hwy 167
- Available now



BILL CONDON, SIOR
+1 206 235 9732
bill.condon@colliers.com

MATT MCGREGOR, SIOR
+1 206 624 7401
matt.mcgregor@colliers.com

JACK MURPHY
+1 206 384 1084
jack.murphy@colliers.com

This document has been prepared by Colliers for advertising and general information only. Colliers makes no guarantees, representations or warranties of any kind, expressed or implied, regarding the information including, but not limited to, warranties of content, accuracy and reliability. Any interested party should undertake their own inquiries as to the accuracy of the information. Colliers excludes unequivocally all inferred or implied terms, conditions and warranties arising out of this document and excludes all liability for loss and damages arising there from. This publication is the copyrighted property of Colliers and/or its licensor(s). ©2025. All rights reserved.

Pacific West Business Center, Bldg B

18868 72nd Ave S, Kent, WA 98032

SITE PLAN

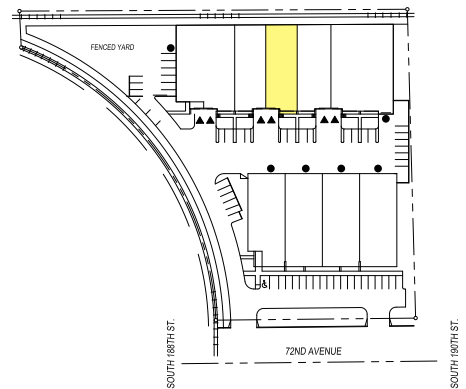
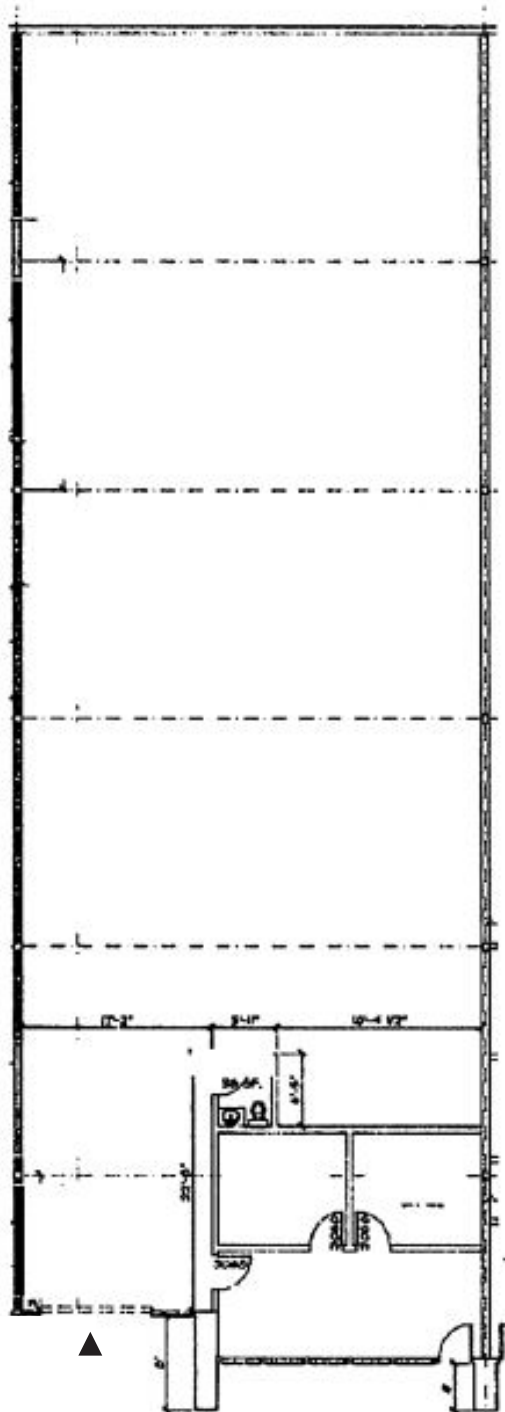

▲ Dock-high door



BILL CONDON, SIOR
+1 206 235 9732
bill.condon@colliers.com

MATT MCGREGOR, SIOR
+1 206 624 7401
matt.mcgregor@colliers.com

JACK MURPHY
+1 206 384 1084
jack.murphy@colliers.com