

FOR SUBLEASE > 57,600 SF



# NW Corporate Park, Kent, Bldg. H

20219 87TH AVE S | KENT, WASHINGTON 98031



## AVAILABILITY AND FEATURES

- > 57,600 SF total available for sublease
- > 3,088 SF office
- > Dock high and grade level doors
- > T5 Lighting
- > ESFR sprinklers
- > Great access to I-5 and SR-167
- > Available with 45 days notice
- > Sublease term expires March 31, 2020
- > \$0.45 PSF shell / \$0.85 PSF office, NNN

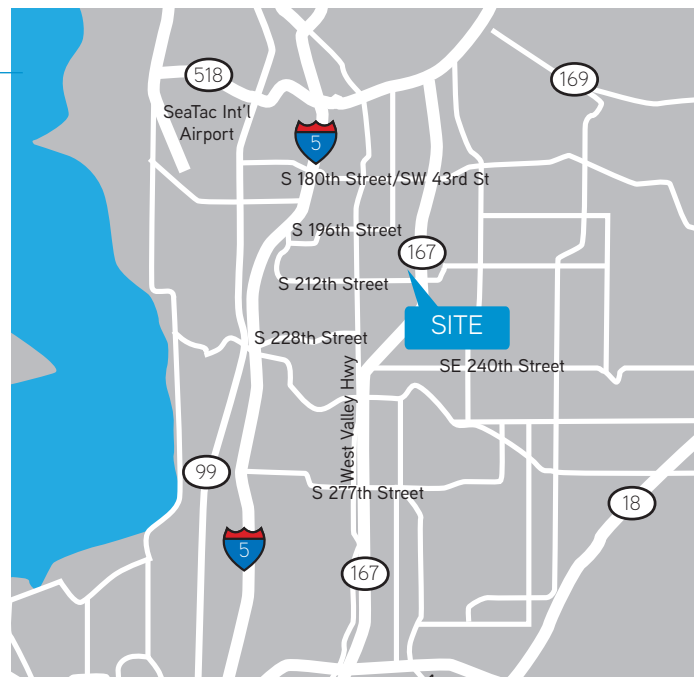

BILL CONDON, SIOR  
+1 206 624 7400  
SEATTLE, WA  
[bill.condon@colliers.com](mailto:bill.condon@colliers.com)

MATT MCGREGOR, SIOR  
+1 206 624 7401  
SEATTLE, WA  
[matt.mcgregor@colliers.com](mailto:matt.mcgregor@colliers.com)

COLLIERS INTERNATIONAL  
601 Union Street, Suite 5300  
Seattle, WA 98101  
[www.colliers.com](http://www.colliers.com)

FOR SUBLEASE > 57,600 SF



# NW Corporate Park, Kent, Bldg. H

20219 87TH AVE S | KENT, WASHINGTON 98031

## Floor Plan

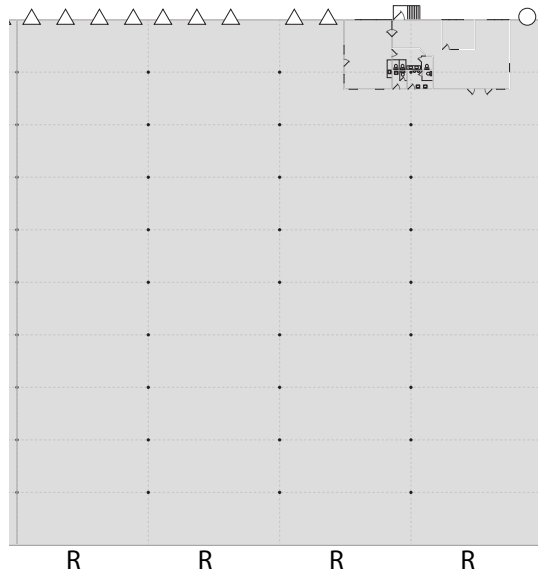

54,512 Warehouse  
3,088 Office  

---

57,600 Total Available

BUILDING H	
○	Grade Level Door
△	Dock High Door
R	Rail Door

## Building Plan

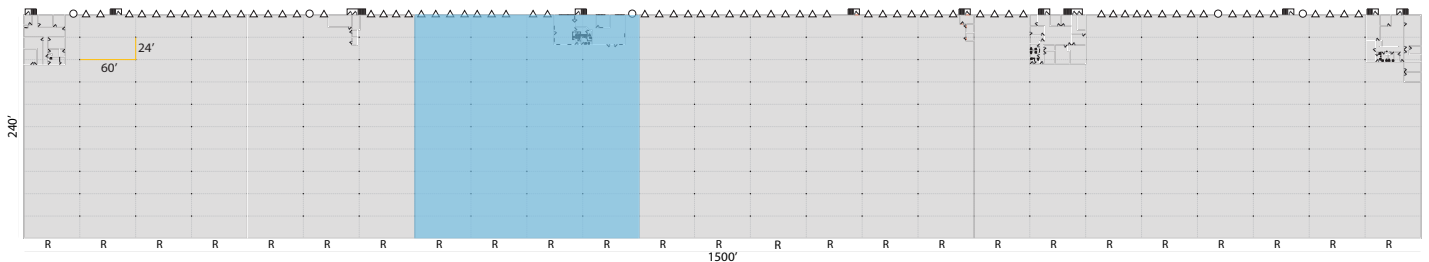

## Site Aerial



This document has been prepared by Colliers International for advertising and general information only. Colliers International makes no guarantees, representations or warranties of any kind, express or implied, regarding the information including, but not limited to, warranties of content, accuracy and reliability. Any interested party should undertake their own inquiries as to the accuracy of the information. Colliers International excludes unequivocally all inferred or implied terms, conditions and warranties arising out of this document and excludes all liability for loss and damages arising there from. Colliers International is a worldwide affiliation of independently owned and operated companies. This publication is the copyrighted property of Colliers International and /or its licensor(s). © 2018. All rights reserved.

BILL CONDON, SIOR  
+1 206 624 7400  
SEATTLE, WA  
bill.condon@colliers.com

MATT MCGREGOR, SIOR  
+1 206 624 7401  
SEATTLE, WA  
matt.mcgregor@colliers.com

COLLIERS INTERNATIONAL  
601 Union Street, Suite 5300  
Seattle, WA 98101  
www.colliers.com