



MANUFACTURING AND WAREHOUSE SPACE AVAILABLE

50,000 - 200,000 SF

475,000 +/- TOTAL
SF

Lease Rate:

\$2.50-
\$2.95/SF

DANVILLE INDUSTRIAL CENTER

1857 SOUTH DANVILLE BY-PASS | DANVILLE, KY 40423

FEATURES

- 50,000 - 475,000 SF
- 10 docks
- 2 drive-in doors
- 25' - 33' clear height
- 3 electrical feeds
- Bus ducts power distribution
- Floor drains
- Upgraded lighting
- Ample restrooms
- Gas flair heat
- 100% sprinklered
- Zoned Industrial

colliers.com/cincinnati



Accelerating success.

Contact us:

Michael E. Daly, SIOR

Brokerage Senior Vice President

+1 513 562 2206

michael.daly@colliers.com

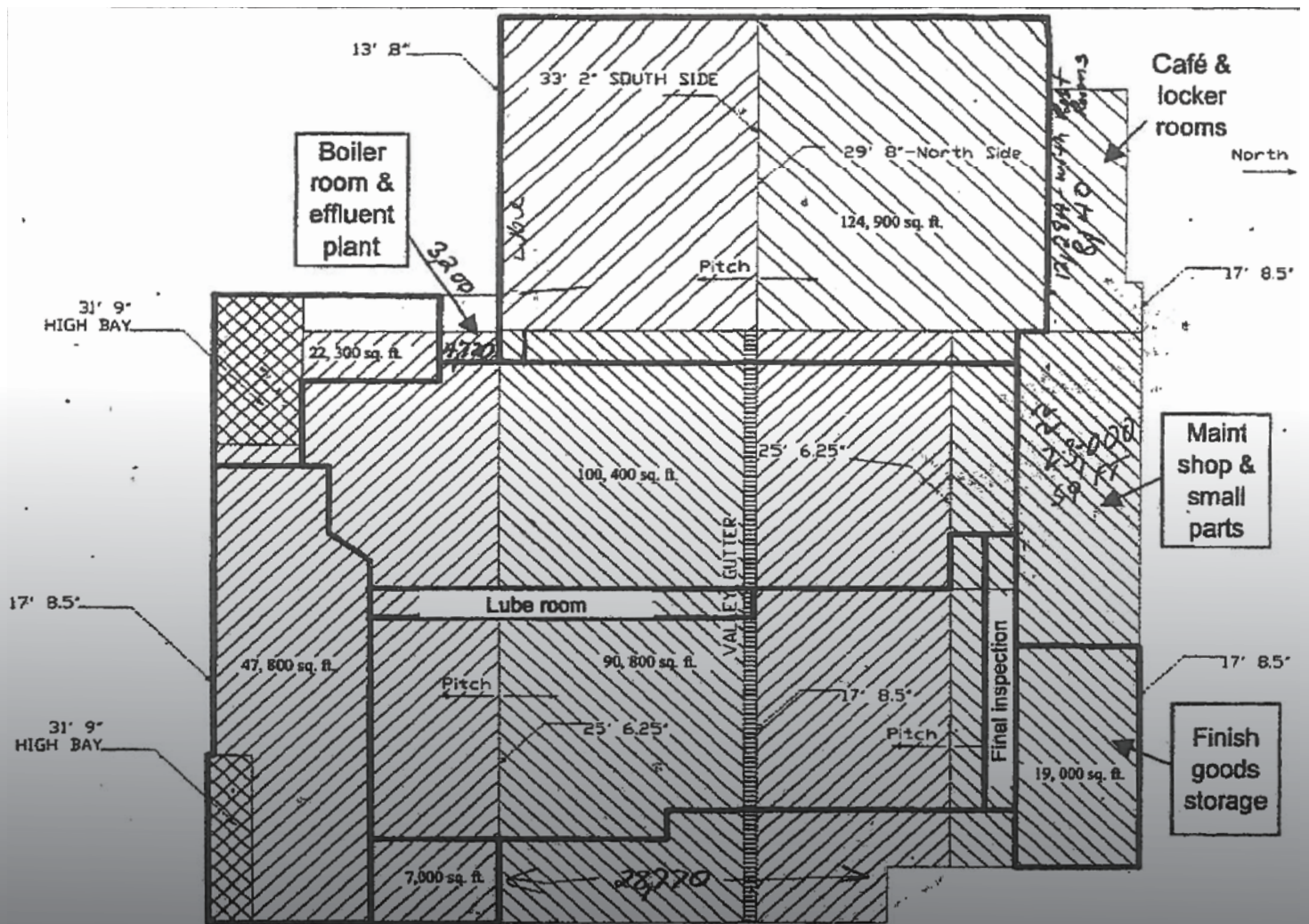

ABOUT DANVILLE, KENTUCKY

- Became part of the Commonwealth of Kentucky when Kentucky became a state in 1792
- Danville is called the "Birthplace of the Bluegrass" since the first Constitutional Convention in the West was held at Constitution Square in 1792 when Kentucky's first Constitution was signed.
- The City's broad-based economy includes agricultural, commercial, industrial, and educational enterprises. Danville, as the economic hub of Boyle County, has evolved into a regional commerce center. Residents of the City and surrounding areas shop, work, obtain a college education, and receive medical care in Danville.



Accelerating success.