

FOR SALE > VACANT LAND

# Highly Visible Land On I-25

SOUTH EAST CORNER OF I-25 & GIBSON, ALBUQUERQUE, NM 87102



## Details

- > Price: \$6.00 / SF
- > Lot Sizes:
  - +/- 4.532 Acres (\$1,185,000)
  - +/- 2.8 Acres (\$732,000)
- > Ideal for hotel, retail and restaurants uses
- > Zoning: SU-IP

## Contact Us

BEN PERICH  
SENIOR ASSOCIATE  
+1 505 880 7054  
ALBUQUERQUE, NM  
[ben.perich@colliers.com](mailto:ben.perich@colliers.com)

TERRIE HERTWECK, CCIM  
VICE PRESIDENT  
+1 505 880 7022  
ALBUQUERQUE, NM  
[terrie.hertweck@colliers.com](mailto:terrie.hertweck@colliers.com)

COLLIERS INTERNATIONAL  
+1 505 883 7676 Main  
5051 Journal Center Blvd NE, Suite 200  
Albuquerque, NM 87110  
[www.colliers.com](http://www.colliers.com)

*Independently Owned and Operated*

The information contained herein was obtained from sources believed reliable; however, Colliers International makes no guarantees, warranties or representations as to the completeness or accuracy thereof. The presentation of this property is submitted subject to errors, omissions, change of price or conditions prior to sale or lease, or withdrawal without notice.



# Parcel Map

SOUTH EAST CORNER OF I-25 & GIBSON, ALBUQUERQUE, NM 87102

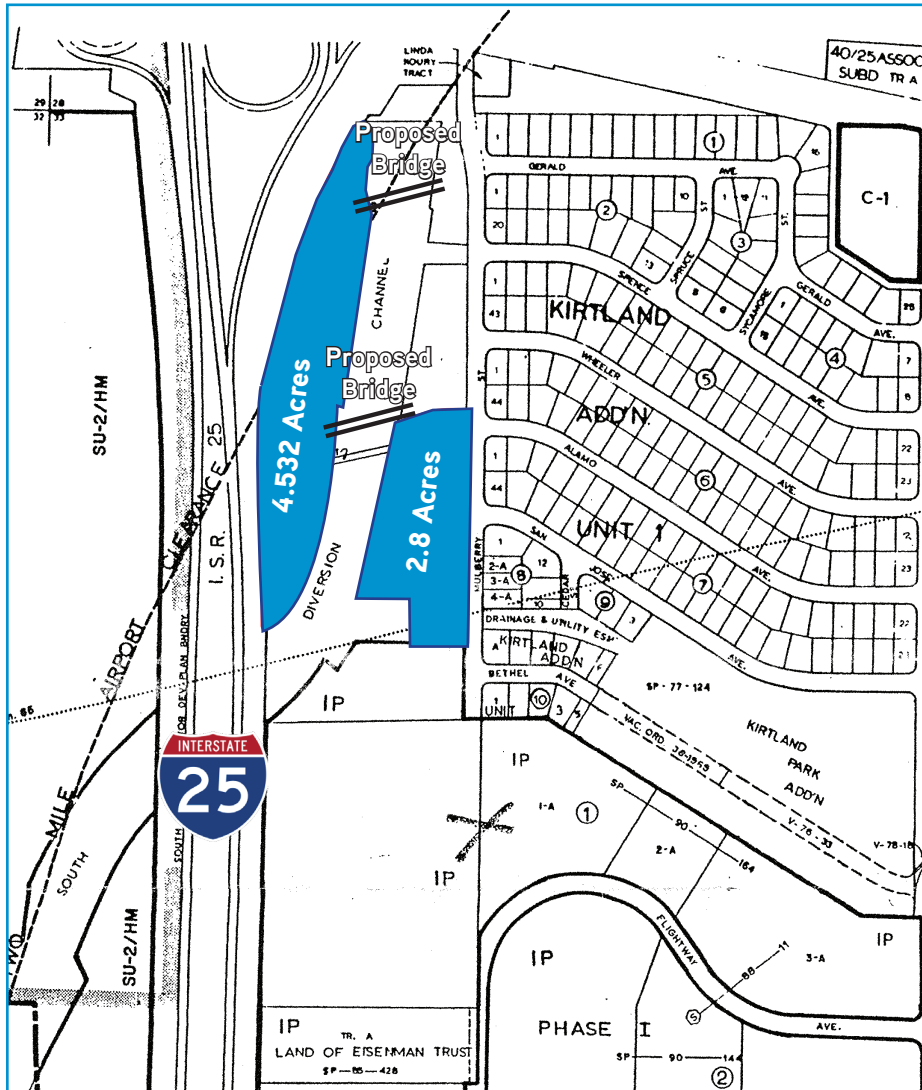

## Site Amenities

- > I-25 frontage with convenient access from the Gibson Blvd interchange.
- > Proposed bridge across diversion channel
- > Ideal location for casual dining, fast food, hospitality or multi-family uses.
- > Close proximity to Sunport International Airport, University of New Mexico, Central New Mexico University, Kirtland Airforce Base, VA Hospital, Davita Clinic and Downtown Albuquerque
- > Immediately north of Valley View Villas, a 786 bed student housing project.

## Area Tenants





FOR SALE > VACANT LAND

# Intersection Aerial

SOUTH EAST CORNER OF I-25 & GIBSON, ALBUQUERQUE, NM 87102





TERRIE HERTWECK, CCIM  
 VICE PRESIDENT  
 +1 505 880 7022  
 ALBUQUERQUE, NM  
[terrie.hertweck@colliers.com](mailto:terrie.hertweck@colliers.com)

	1-Mile	3-Mile	5-Mile
Total Population	7,561	70,479	199,991
Total Households	2,520	29,897	80,253
Average HH Income	\$38,553	\$50,730	\$50,801
Median HH Income	\$27,030	\$32,333	\$34,775

