

VIEW ONLINE 

[colliers.com/richmond](http://colliers.com/richmond)

# Convenient access to Route 288

**FOR LEASE | Chesterfield Business Center & Airpark Business Center**  
Whiteline Road | Richmond, VA

## FEATURES

- Six office/warehouse buildings totaling approximately 200,000 SF
- Brick and glass facade with private entrances
- 12' - 14' ceiling heights
- Suites available from 2,851 SF – 7,905 SF of office/warehouse space
- Dock and drive-in loading available
- I-1 zoning (Chesterfield County light industrial)
- Ample parking on site
- High Speed internet available via Comcast
- Convenient access to Route 288
- Owned and managed by Baker Properties - Richmond Limited Partnership

**Matt Anderson, SIOR**  
Executive Vice President  
+1 804 240 8833  
[matt.anderson@colliers.com](mailto:matt.anderson@colliers.com)

**Jimmy Martin**  
Vice President  
+1 804 267 7218  
[jimmy.martin@colliers.com](mailto:jimmy.martin@colliers.com)



**Colliers International**  
6641 W Broad St | Suite 101  
Richmond, VA 23230  
P: +1 804 320 5500  
F: +1 804 320 4839

Accelerating success.

**FOR LEASE | Chesterfield Business Center & Airpark Business Center**  
 Whitepine Road | Richmond, VA



**Chesterfield Business Center**  
 Available Space

|                                 |          |
|---------------------------------|----------|
| <b>7361-7419 WHITEPINE</b>      |          |
| Suite 7419                      | 2,851 SF |
| <b>7421-7441 WHITEPINE</b>      |          |
| Suite 7435-37                   | 5,358 SF |
| Suite 7441 (available 5/1/2020) | 2,057 SF |
| <b>7445-7471 WHITEPINE</b>      |          |
| Suite 7449                      | 2,850 SF |
| <b>7475-7499 WHITEPINE</b>      |          |
| Suite 7487                      | 7,905 SF |

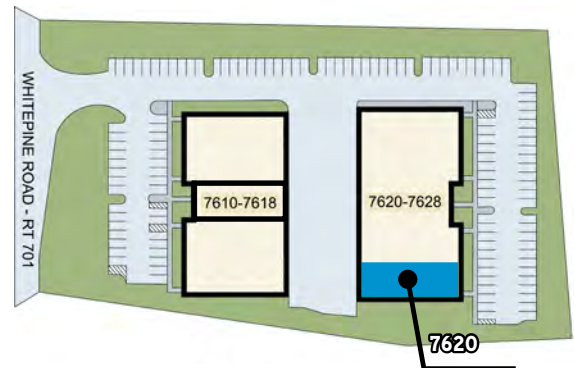

**Airpark Business Center**  
 Available Space

|                            |          |
|----------------------------|----------|
| <b>7620-7628 WHITEPINE</b> |          |
| Suite 7620                 | 4,400 SF |

Contact us:

**Matt Anderson, SIOR**  
 Executive Vice President  
 +1 804 240 8833  
 matt.anderson@colliers.com

**Jimmy Martin**  
 Vice President  
 +1 804 267 7218  
 jimmy.martin@colliers.com

**Colliers International** | 6641 W Broad St | Suite 101 | Richmond, VA 23230  
 P: +1 804 320 5500 | F: +1 804 320 4839

This document has been prepared by Colliers International for advertising and general information only. Colliers International makes no guarantees, representations or warranties of any kind, expressed or implied, regarding the information including, but not limited to, warranties of content, accuracy and reliability. Any interested party should undertake their own inquiries as to the accuracy of the information. Colliers International excludes unequivocally all inferred or implied terms, conditions and warranties arising out of this document and excludes all liability for loss and damages arising there from. This publication is the copyrighted property of Colliers International and/or its licensor(s). ©2020. All rights reserved.

**VIEW ONLINE**

[colliers.com/richmond](https://colliers.com/richmond)



Accelerating success.



**FOR LEASE | Chesterfield Business Center & Airpark Business Center**  
Whiteline Road | Richmond, VA



Contact us:

**Matt Anderson, SIOR**

Executive Vice President

+1 804 240 8833

matt.anderson@colliers.com

**Jimmy Martin**

Vice President

+1 804 267 7218

jimmy.martin@colliers.com

Colliers International | 6641 W Broad St | Suite 101 | Richmond, VA 23230

P: +1 804 320 5500 | F: +1 804 320 4839

VIEW ONLINE 

[colliers.com/richmond](https://colliers.com/richmond)



Accelerating success.