

FOR LEASE > RETAIL SPACE



Marks & Bullard Shopping Center

SWC BULLARD AND MARKS AVENUES, FRESNO, CALIFORNIA

Anchor and Shops Spaces Available!



Bullard Avenue Signage



Bullard/Marks Corner Sign

- 1,200 SF to 16,531 SF Available.
- Anchored by Fresno County Library.
- High Income Area.
- Large Parking Area.
- Monument Signage Available.

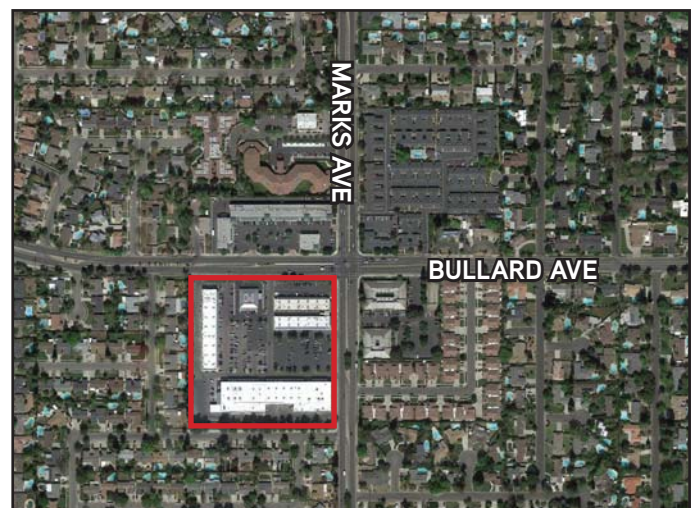

AGENT: GERALD CROSS
559.221.1271 | EXT. 103
FRESNO, CA
gerald.cross@colliers.com
BRE # 00992292

AGENT: STEVE RONTTELL
559.221.1271 | EXT. 113
FRESNO, CA
steve.ronttell@colliers.com
BRE #00932510

COLLIERS INTERNATIONAL
7485 N. Palm Avenue #110
Fresno, CA 93711
www.colliers.com/fresno

FOR LEASE > RETAIL SPACE

Marks & Bullard Shopping Center

SWC BULLARD AND MARKS AVENUES, FRESNO, CALIFORNIA

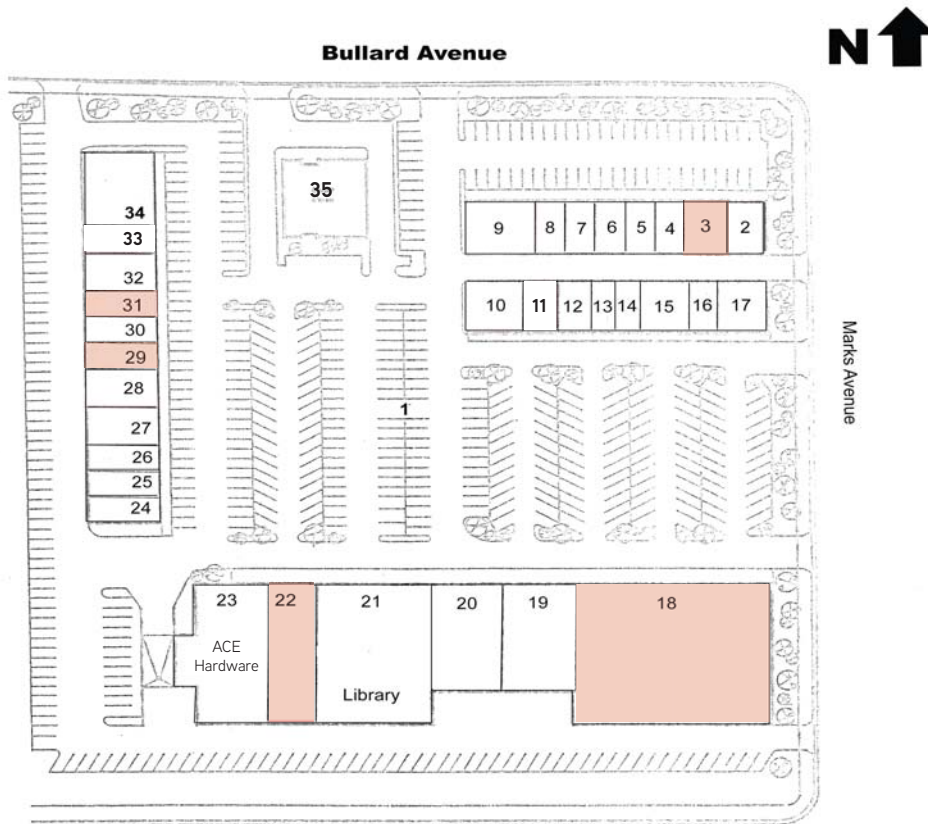

PROPERTY SUMMARY

Location

Southwest corner of Bullard and Marks Avenues, Fresno, CA

Zoning

C-C, Commercial Community

Size Availability

1,200 SF to 16,531 SF

Customer Traffic

Over 25,000 cars per day in intersection

Customer Demographics

	Population	Avg. HH Income
1 Mile:	15,466	\$87,155
2 Miles:	54,667	\$87,139
3 Miles:	117,451	\$75,223
4 Miles:	193,896	\$69,397
5 Miles:	264,848	\$66,002

Asking Rent

See Site Plan (NNN approx. \$0.33 psf)

COLLIERS INTERNATIONAL
7485 N. Palm Avenue, #110
Fresno, CA 93711
559 221 1271

www.colliers.com

1. Spruce Juice
2. Well Plus Pharmacy
3. **AVAILABLE 1,600 SF (\$1.25 PSF)**
4. A Golden Touch
5. Supercuts Training
6. Benediction Restaurant
7. Valley Pool
8. Valley Pool
9. Old Doc's Liquor
10. Pamela Leads Photography
11. Malibu Fashions and Storage
12. Sanchez Barber Shop
13. Kenmor Jewelers
14. Gili/Alterations
15. Classic Cleaners
16. Fat Boys Sports Bar and Tacqueria
17. Fat Boys Sports Bar and Tacqueria

18. **AVAILABLE 16,531 SF (\$0.90 PSF)**
(Previous Shapemakers)
19. Religious Supply - Coming Soon
20. Dethrone Base Camp MMA
21. Fresno County Library
22. **AVAILABLE 7,460 SF (\$0.65 PSF)**
23. ACE Hardware
24. Door Art Gallery
25. Enchanted Nails
26. Personal Trainer
27. Radiance Salon (2,400 SF)
28. Optometry
29. **AVAILABLE 1,200 SF (\$1.00 PSF)**
30. Coast to Coast Electronics
31. **AVAILABLE 1,200 SF (\$1.00 PSF)**
32. Fresno Fit
33. The Frame Shop
34. Ovidio's Restaurant
35. Fresno County Employees Credit Union (NAP)