



# Milpitas 10 Business Park

1503 N. Milpitas Boulevard, Milpitas, CA 95035

Milpitas 10 Business Park is located at the intersection of North Milpitas Boulevard and Washington Drive. This park offers easy access to I-880 and I-680.

**Available Now - Market Ready Underway with new LED lighting in the office areas, new paint and carpet.**

**Specifications**

**5,760 sq. ft.**  
AVAILABLE NOW

**40%**  
OFFICE AREA

**16'**  
CLEAR HEIGHT\*  
\*Owner willing to remove drop ceiling in warehouse area

**Grade Level**  
LOADING

**Fully Sprinklered**  
FIRE SPRINKLERS

**3.1/1,000 Ratio**  
AUTO PARKING

**200 Amps, 110/208 V, 3P**  
POWER

**Highway Services**  
ZONING

**Building frontage, signage and identity along North Milpitas Boulevard**

**Close proximity to Interstates 880 & 680 for excellent access to East & South Bay labor pool**

**More than 50 local amenities within a 1-mile radius**

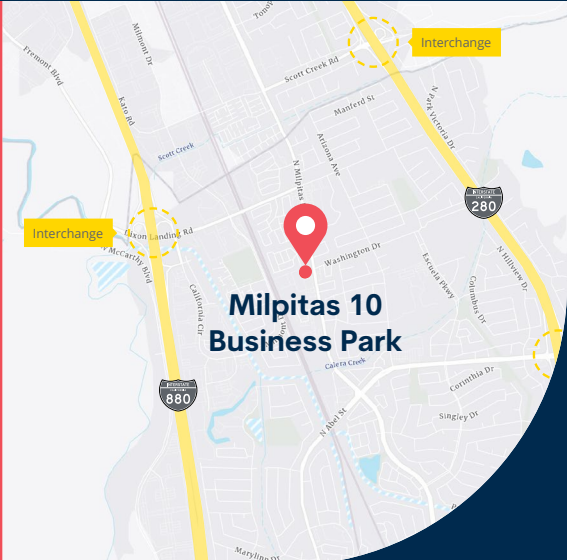

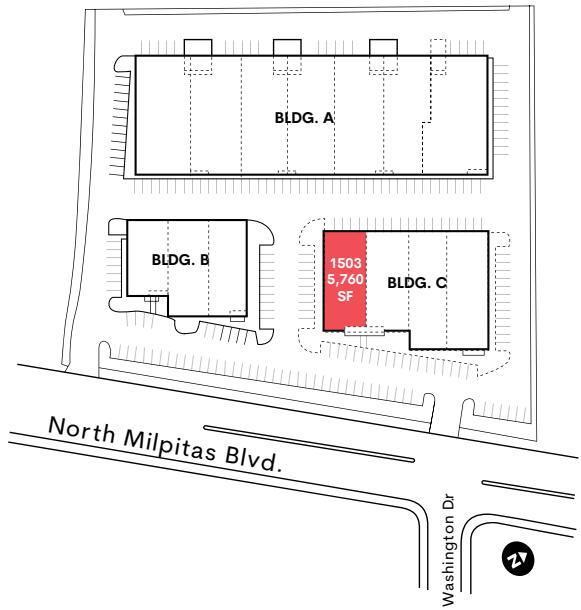
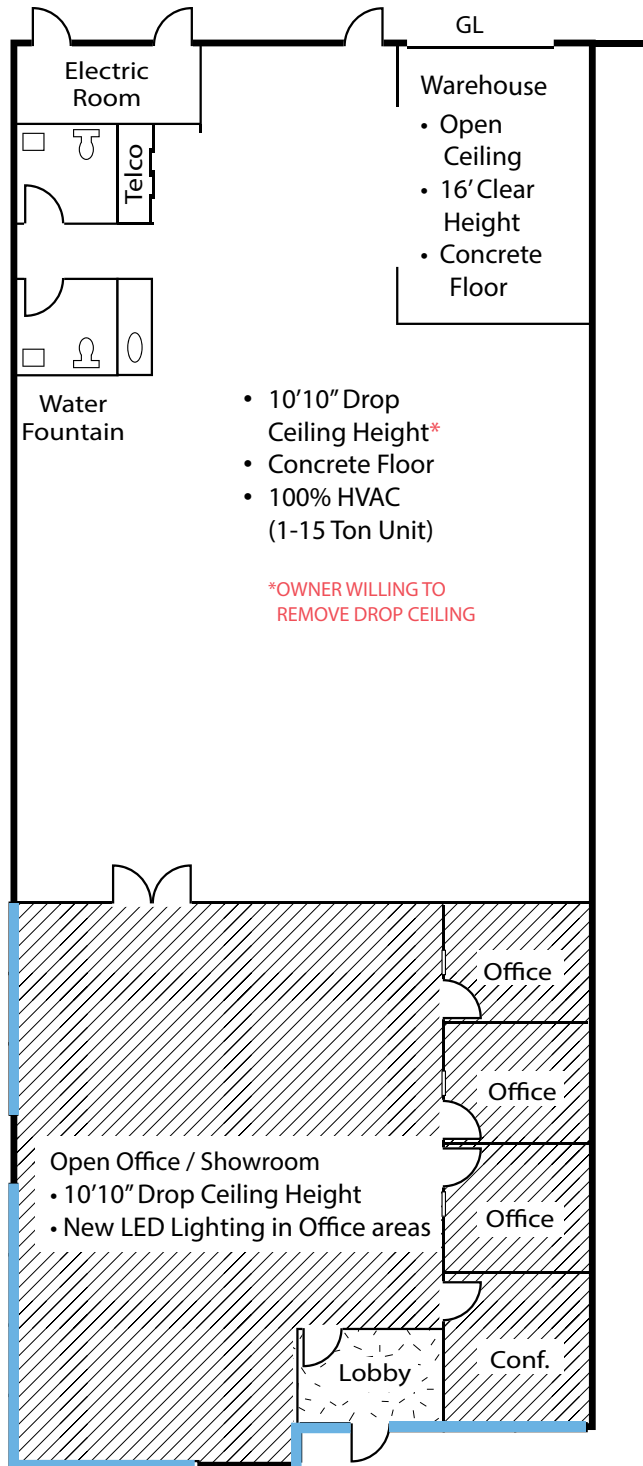

# 1503 N. Milpitas Boulevard 5,760 sq. ft.

- Leased
- Available
- LVT Flooring
- Carpet Flooring
- Glass
- GL Grade Level Roll-up Door

## Contacts

**Craig Fordyce, SIOR, CCIM**  
 D 408.282.3911  
 craig.fordyce@colliers.com  
 Lic. 00872812

**Michael Rosendin, SIOR, CCIM**  
 D 408.282.3900  
 michael.rosendin@colliers.com  
 Lic. 00826095





## Contacts

**Craig Fordyce, SIOR, CCIM**  
D 408.282.3911  
craig.fordyce@colliers.com  
Lic. 00872812

**Michael Rosendin, SIOR, CCIM**  
D 408.282.3900  
michael.rosendin@colliers.com  
Lic. 00826095





Contacts

Craig Fordyce, SIOR, CCIM  
 D 408.282.3911  
 craig.fordyce@colliers.com  
 Lic. 00872812

Michael Rosendin, SIOR, CCIM  
 D 408.282.3900  
 michael.rosendin@colliers.com  
 Lic. 00826095

