



Accelerating success.



For Lease

15955 N Dial Blvd

Suite 1, Scottsdale AZ 85260

Greg Hopley

Executive Vice President
+1 480 655 3333
greg.hopley@colliers.com

Dillon Hopley

Vice President
+1 480 655 3301
dillon.hopley@colliers.com

- Vacant approx. 4,197± SF
- Available September 2025 approx. ±1,125 SF
- NEW IMPROVEMENTS UNDERWAY: new carpet, paint, and lighting in the office area and expansion of warehouse
- Building signage available
- Premier North Scottsdale location with easy access to Loop 101
- Proximity to the unique blend of retail, dining and entertainment of Kierland Commons and Scottsdale Quarter
- Over 140 restaurants, upscale retail, and hotels within walking distance

For Lease | 15955 N Dial Blvd, Suite 1

First Floor

■ Vacant ■ Available September 2025

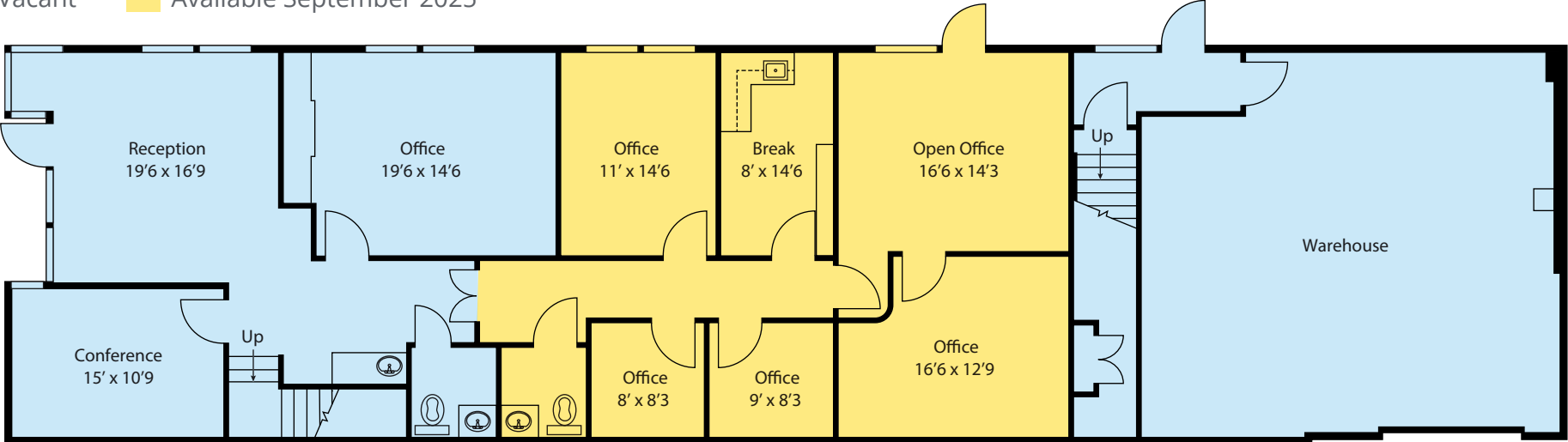

Second Floor

■ Vacant

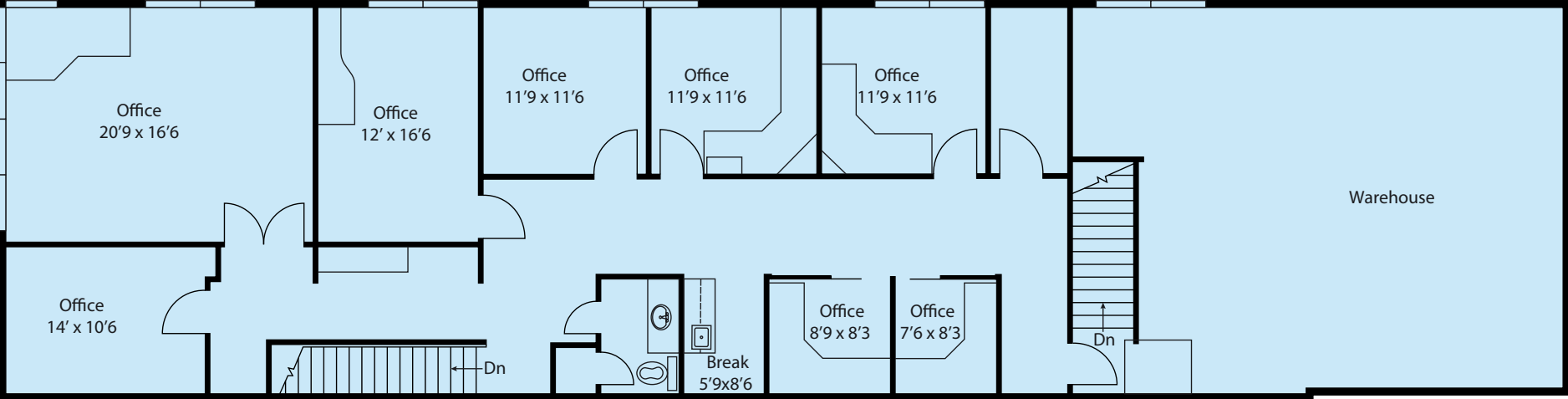

**floor plan is approximate and not to scale*

For Lease

15955 N Dial Blvd

Suite 1, Scottsdale AZ 85260

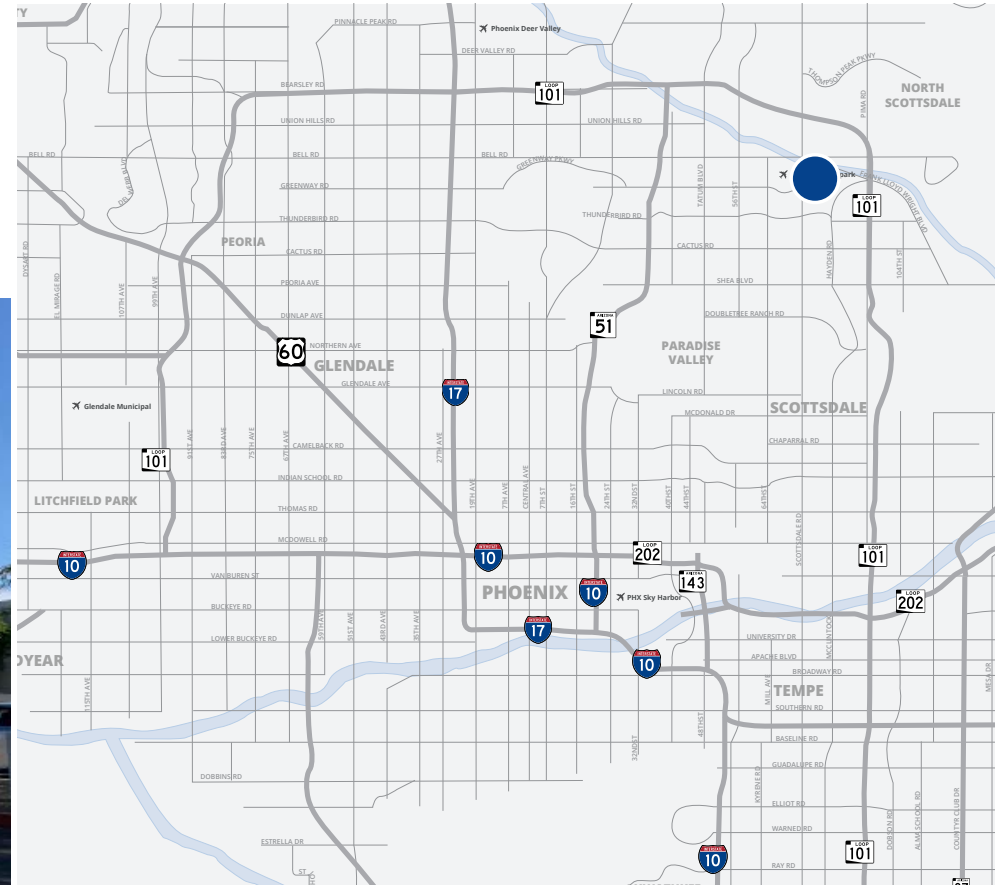

Colliers

8360 E Raintree Dr, Ste 130
Scottsdale, AZ 85260
+1 480 596 9000
colliers.com/arizona

Greg Hopley

Executive Vice President
+1 480 655 3333
greg.hopley@colliers.com

Dillon Hopley

Vice President
+1 480 655 3301
dillon.hopley@colliers.com

This document/email has been prepared by Colliers for advertising and general information only. Colliers makes no guarantees, representations or warranties of any kind, expressed or implied, regarding the information including, but not limited to, warranties of content, accuracy and reliability. Any interested party should undertake their own inquiries as to the accuracy of the information. Colliers excludes unequivocally all inferred or implied terms, conditions and warranties arising out of this document and excludes all liability for loss and damages arising there from. This publication is the copyrighted property of Colliers and /or its licensor(s). © 2025. All rights reserved. This communication is not intended to cause or induce breach of an existing listing agreement. Colliers International AZ, LLC.