

FOR LEASE > OFFICE SPACE

1901 Bragaw Street

ANCHORAGE, ALASKA 99508



Property Information

- > 3-story professional office building just minutes away from Midtown, U-Med District and Downtown.
- > Located in an office center complex with ample employee and clientele parking
- > \$2.40/SF, Full Service
- > Available spaces:
 - 3rd Floor - Approximately 2,400-9,100 SF

DEMOGRAPHICS	1 MILE	3 MILE	5 MILE
Population			
2022	12,623	106,388	168,510
Households			
2022	4,802	40,286	65,463
Income			
2022 Median HHI	\$62,121	\$67,493	\$71,744
2022 Average HHI	\$88,021	\$93,539	\$99,723
2022 Per Capita	\$32,531	\$35,604	\$38,878

Information provided by ESRI Business Analyst

Elisha Martin
+1 907 561 5155
elisha.martin@colliers.com

Tyler Leslie
+1 907 561 5155
tyler.leslie@colliers.com

Colliers International
2600 Cordova St | Suite 205
Anchorage, AK 99503

1901 Bragaw Street

ANCHORAGE, ALASKA 99508

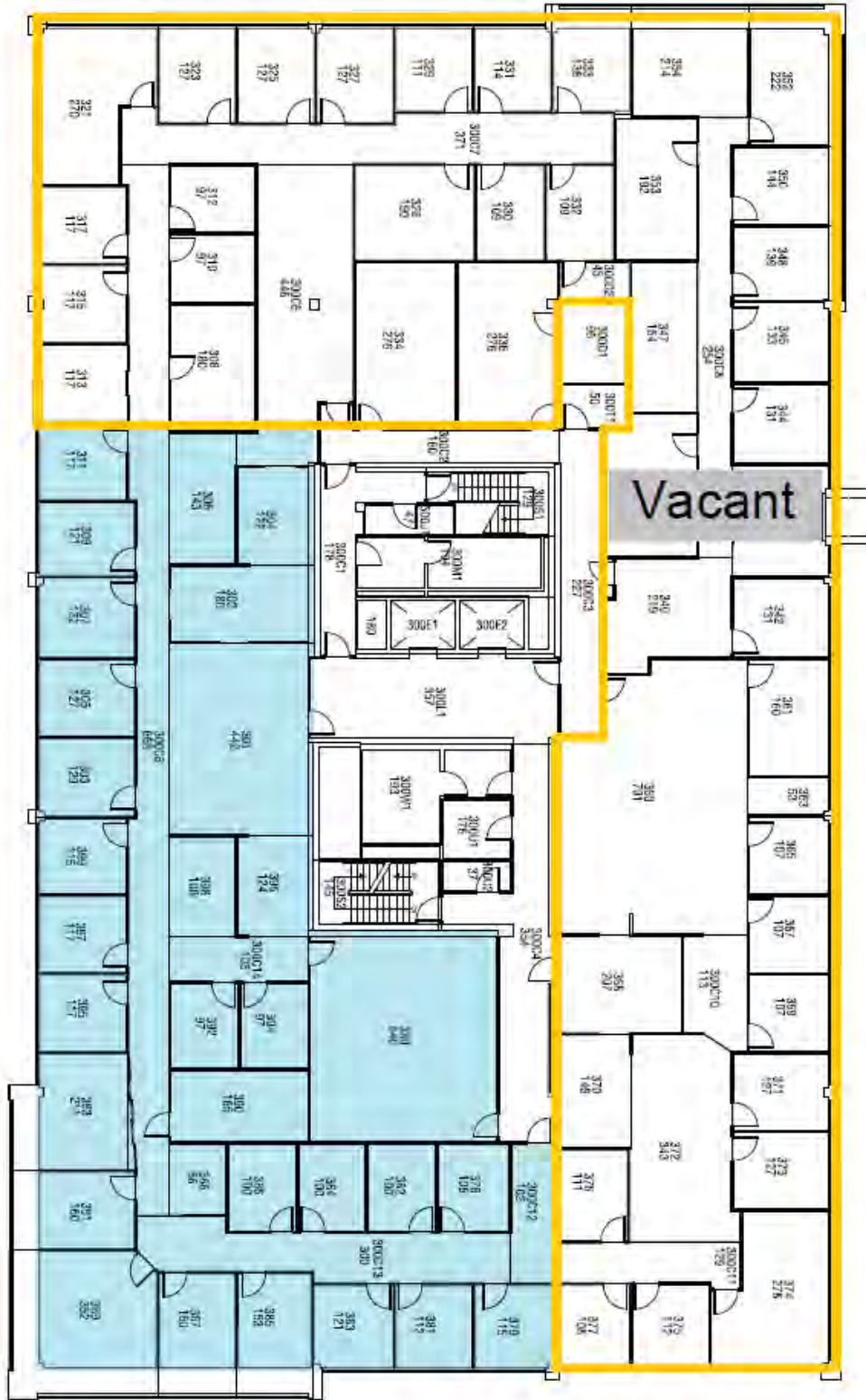

3rd Floor
approx. 2,400-9,100 RSF
available

1901 Bragaw Street

ANCHORAGE, ALASKA 99508



This document has been prepared by Colliers International for advertising and general information only. Colliers International makes no guarantees, representations or warranties of any kind, expressed or implied, regarding the information including, but not limited to, warranties of content, accuracy and reliability. Any interested party should undertake their own inquiries as to the accuracy of the information. Colliers International excludes unequivocally all inferred or implied terms, conditions and warranties arising out of this document and excludes all liability for loss and damages arising there from. This publication is the copyrighted property of Colliers International and/or its licensor(s). ©2019. All rights reserved.

Colliers International
2600 Cordova St | Suite 205
Anchorage, AK 99503
P: +1 907 561 5155



FOR LEASE > OFFICE SPACE

1901 Bragaw Street

ANCHORAGE, ALASKA 99508

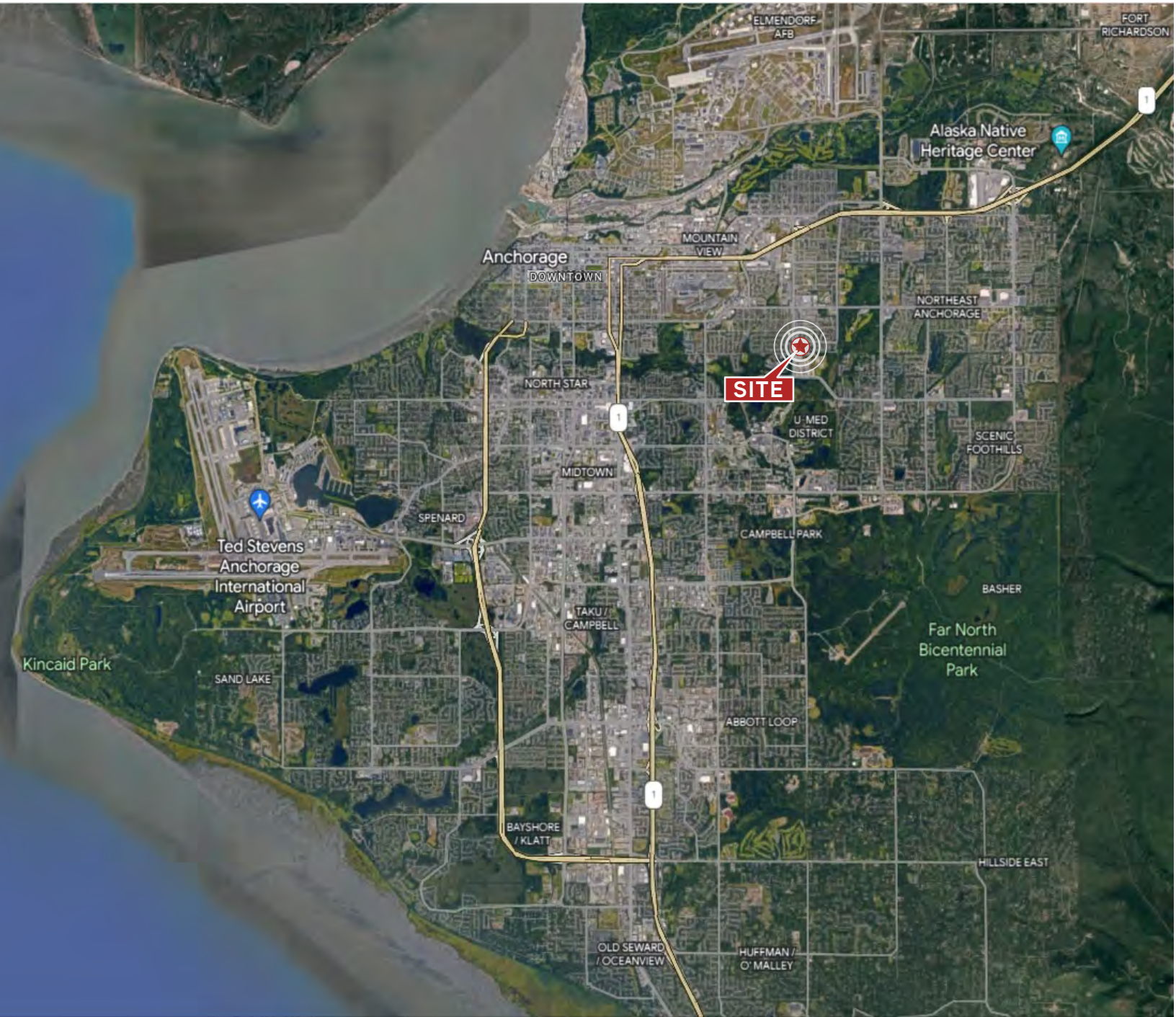

Colliers International
2600 Cordova St | Suite 205
Anchorage, AK 99503
P: +1 907 561 5155

