



# County Road 42 Burnsville Land

FOR  
BUILD-TO-LEASE  
OR SALE





# County Road 42

## Burnsville Land

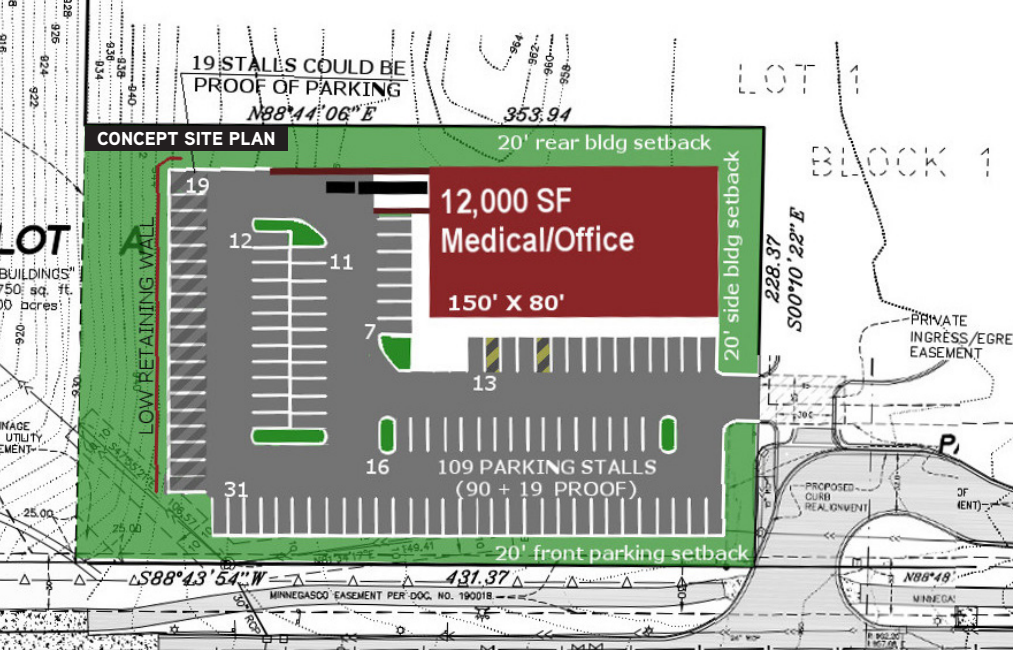

## Details

- 1.85 acres Available for Build-to-Lease or Sale
- I-2 Zoning
- Daycare, medical, office, limited retail
- High visibility site directly west of Burnsville Center (36,000 daily traffic counts on County Road 42)
- 1.4 miles from I-35W and 1.7 miles from I-35E
- Sale Price: \$1,150,000

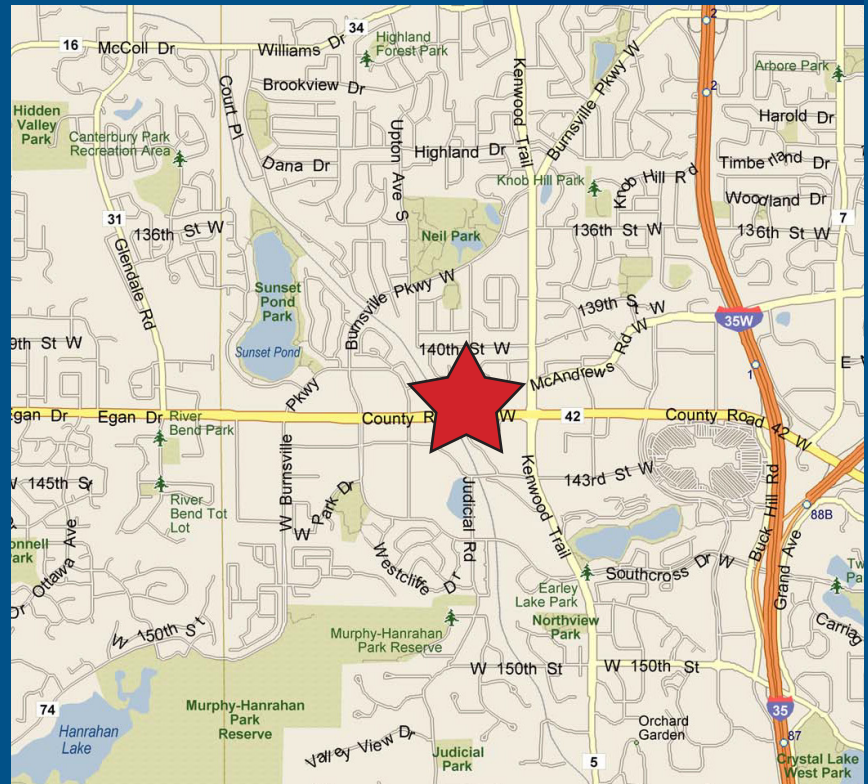

STEVE NILSSON SIOR, CCIM  
952 897 7899  
steve.nilsson@colliers.com

[www.colliers.com/msp](http://www.colliers.com/msp)



This document has been prepared by Colliers International for advertising and general information only. Colliers International makes no guarantees, representations or warranties of any kind, expressed or implied, regarding the information including, but not limited to, warranties of content, accuracy and reliability. Any interested party should undertake their own inquiries as to the accuracy of the information. Colliers International excludes unequivocally all inferred or implied terms, conditions and warranties arising out of this document and excludes all liability for loss and damages arising there from. This publication is the copyrighted property of Colliers International and/or its licensor(s). ©2012. All rights reserved.