



Industrial For Lease

Tom Haverty

Executive Vice President
+1 816 556 1105
tom.haverty@colliers.com

Colliers Kansas City

4520 Main Street, Suite 1000
Kansas City, Missouri 64111
+1 816 531 5303
colliers.com/kansascity

8150 Monticello Terrace Shawnee, Kansas

Property Features

- 4,000 SF space available
 - Includes 1,000± SF mezzanine office space
- Fully air conditioned
- Loading: drive-in door
- Clear height: 16'6"-18'
- Excellent access and visibility to K-7 Highway
- Lease rate: \$14.00 PSF, gross industrial (includes CAM)

8150 Monticello Terrace

Floor Plan

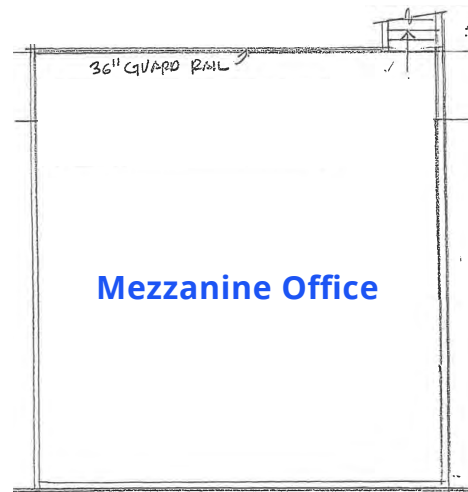
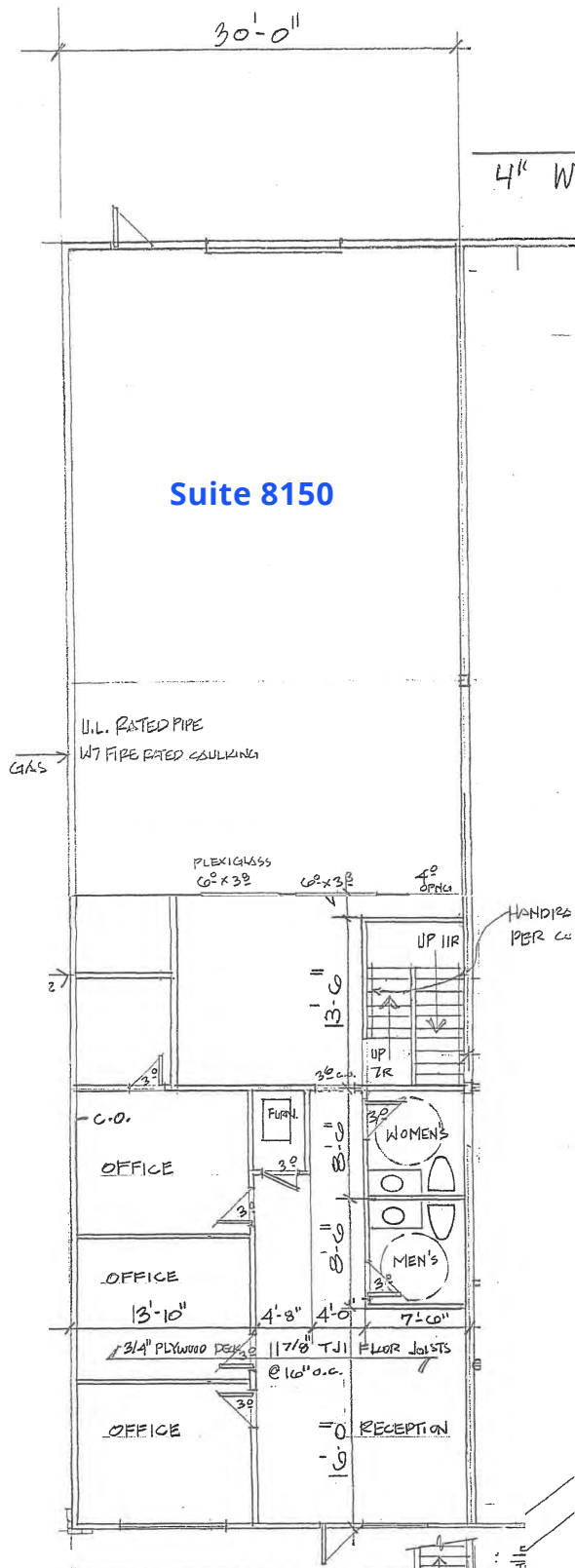

Available For Lease

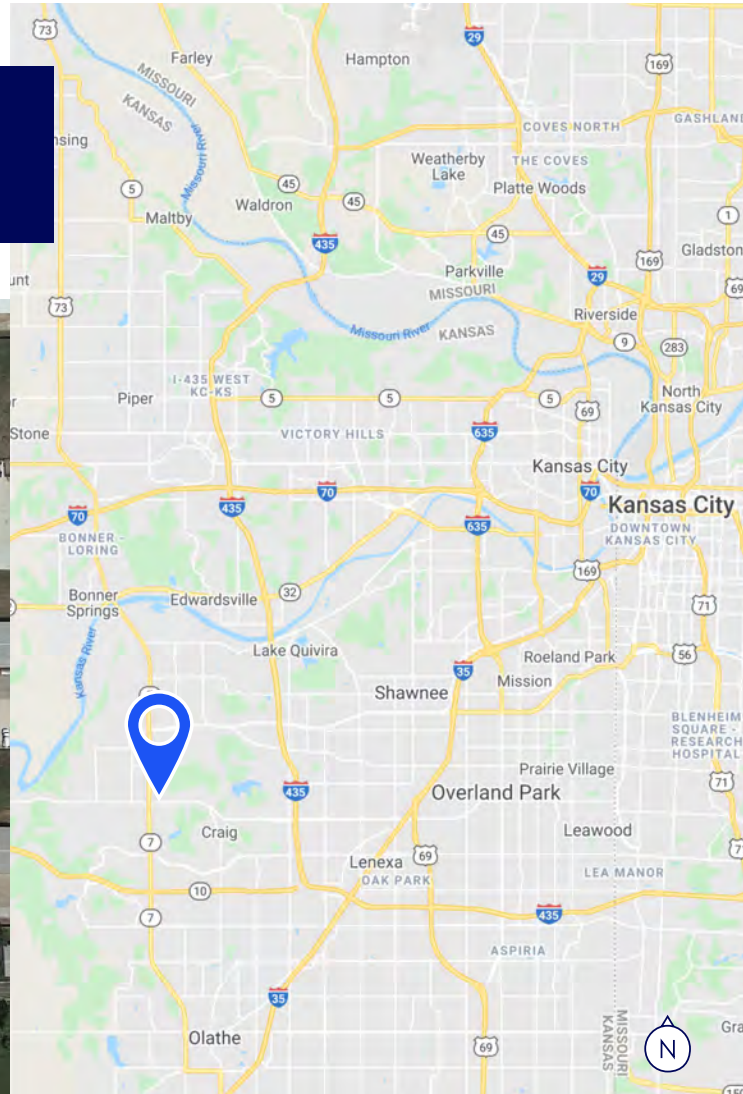
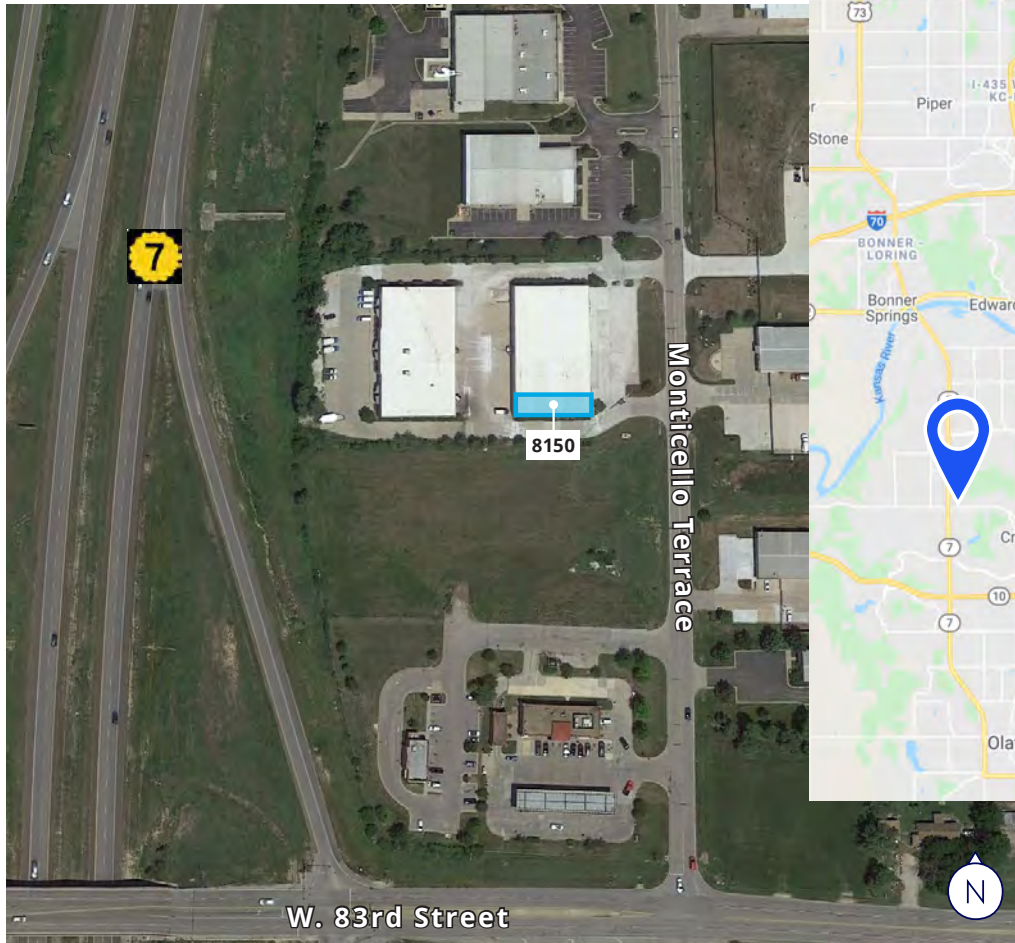

Tom Haverty

Executive Vice President
+1 816 556 1105
tom.haverty@colliers.com

Colliers Kansas City

4520 Main Street, Suite 1000
Kansas City, MO 64111
+1 816 531 5303
colliers.com/kansascity



This document has been prepared by Colliers for advertising and general information only. Colliers makes no guarantees, representations or warranties of any kind, expressed or implied, regarding the information including, but not limited to, warranties of content, accuracy and reliability. Any interested party should undertake their own inquiries as to the accuracy of the information. Colliers excludes unequivocally all inferred or implied terms, conditions and warranties arising out of this document and excludes all liability for loss and damages arising therefrom. This publication is the copyrighted property of Colliers and /or its licensor(s). ©2025. All rights reserved. This communication is not intended to cause or induce breach of an existing listing agreement.