



Wisconsin's newest and only rail served BTS site with unmatched power capabilities

Two remaining pad ready sites to accommodate up to 1.8M SF with rail siding

# LogistiCenter® at Pleasant Prairie

Pleasant Prairie, WI

[logisticcenteratpleasantprairie.com](http://logisticcenteratpleasantprairie.com)



[Dermody.com](http://Dermody.com)



[Colliers.com](http://Colliers.com)

# Southeast Wisconsin



CHICAGO

45 Minutes



MILWAUKEE

40 Minutes



MITCHELL INT'L  
AIRPORT

25 Minutes



O'HARE INT'L  
AIRPORT

40 Minutes

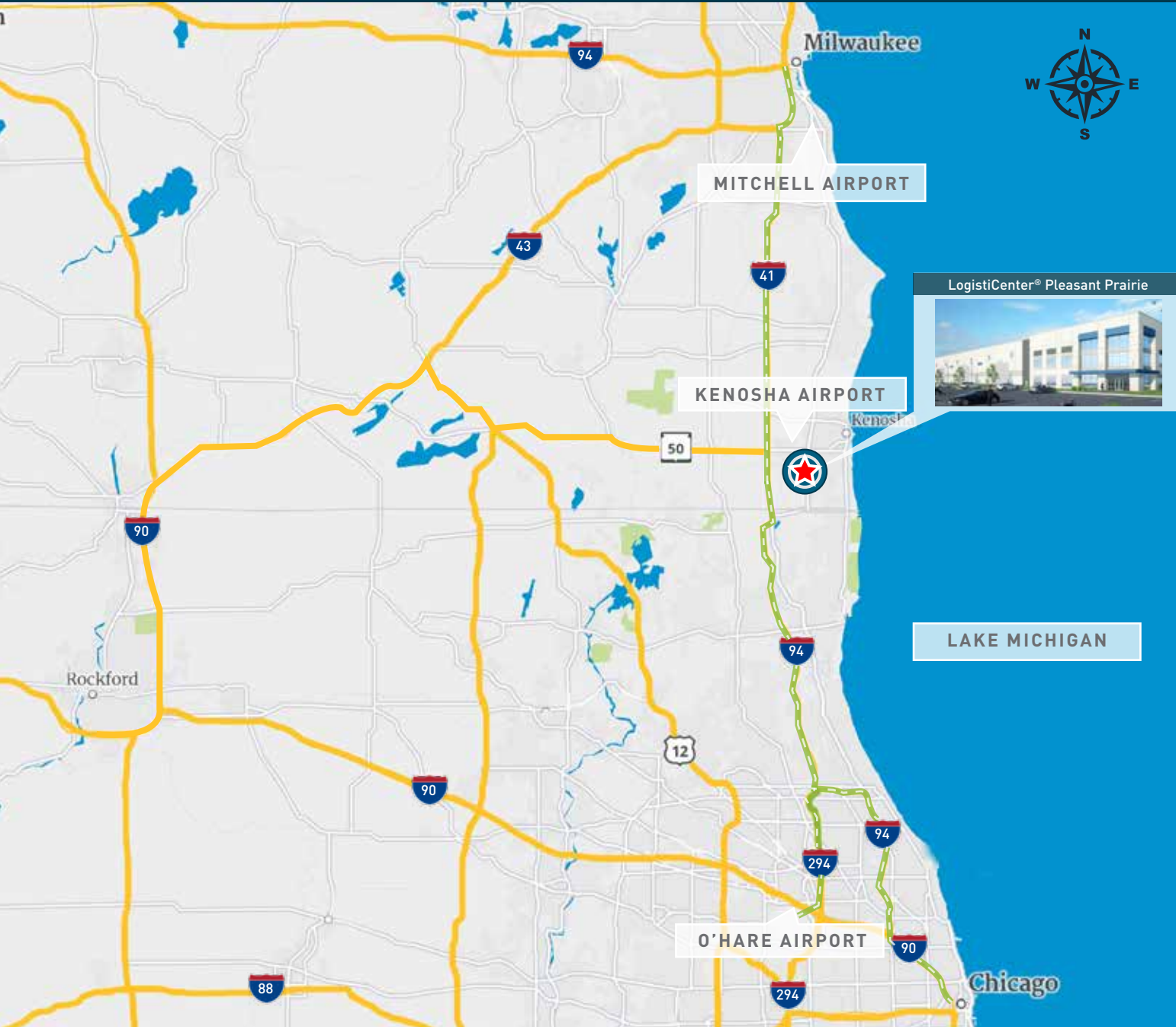

LogistiCenter® Pleasant Prairie

- Planned as a 3-building logistics campus totaling 2,384,765 square feet
- Flexibility to accommodate build to suits from 250,000 square feet to 1.8M square feet
- Over 3.5 million people reside within 45 minutes of the park
- Dual Rail Service (Union Pacific & Canadian Pacific Kansas City)
- Active Union Pacific rail spur by Q1 25
- Pad sites ready
- Flexible clear heights
- Trailer parking
- Unmatched fresh water service from Lake Michigan
- 345KV transmission line available to directly connect with potential for 100+ megawatts
- Adjacent to 1,496 acre Lakeview Corporate Park that includes a 170-acre office and commercial park and a 425-acre nature conservancy area

# Corporate Neighbors



KENOSHA

Microsoft

LogistiCenter® Pleasant Prairie

**ULINE**  
SHIPPING SUPPLY SPECIALISTS

**amazon**

**Gordon**  
FOOD SERVICE

PLEASANT PRAIRIE

**RUST-OLEUM**

inSink erator

pepsi VW meijer

IRIS YAMAHA Jelly Belly EMCO  
CHEMICAL DISTRIBUTORS

scJohnson niagara Hospira **ULINE**  
SHIPPING SUPPLY SPECIALISTS

Aurora Health Care

PLEASANT PRAIRIE  
PREMIUM OUTLETS

**HARIBO** NEXUS  
PHARMACEUTICALS

**ULINE**  
SHIPPING SUPPLY SPECIALISTS

LAKEVIEW  
CORPORATE PARK

Wisconsin  
Illinois

Wisconsin  
Illinois

# Connectivity

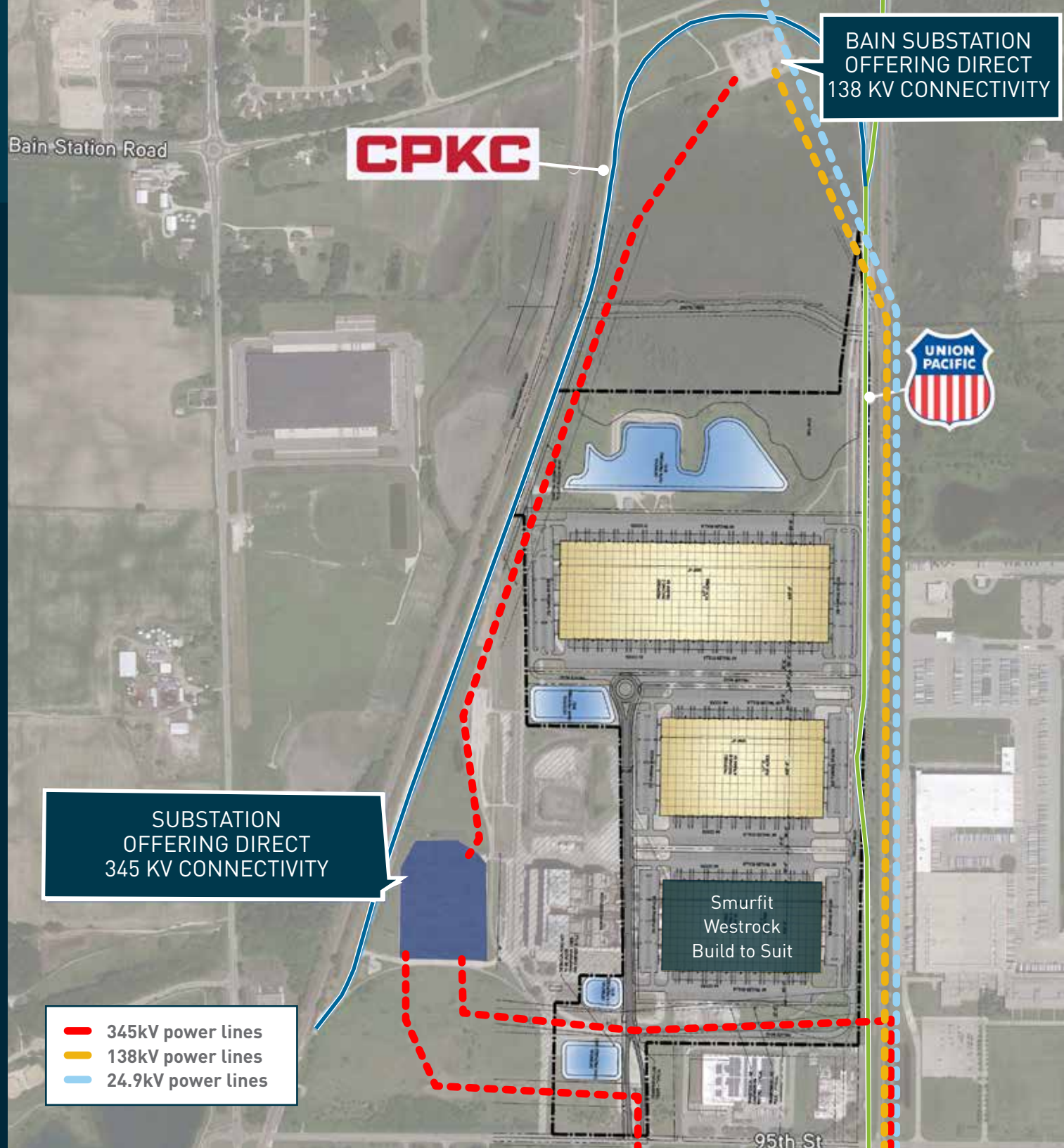



# Property Overview

Building B Concept Plan - 675,200 SF  
Flexible to accommodate BTS requirements

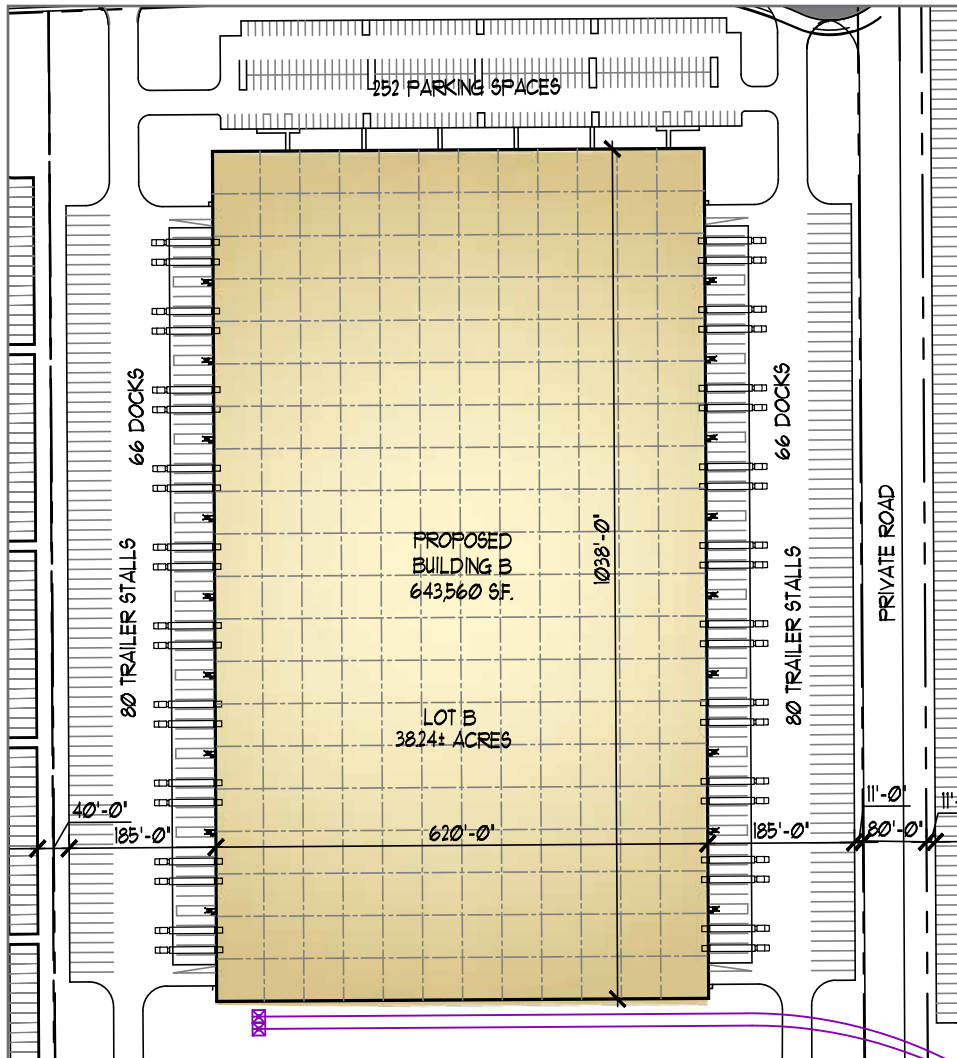

<b>Building Dimensions:</b> 675,200	<b>Clear Height:</b> 40'
<b>Drive-In Doors:</b> 4	<b>Column Spacing:</b> 50'x52'
<b>Dock Doors:</b> 132	<b>Office Area:</b> To Suit
<b>Trailer Parking:</b> 160	<b>Floors:</b> 8" Un-Reinforced
<b>Car Parking:</b> 252	<b>Lighting:</b> To Suit
<b>Zoning:</b> M-2 General Manufacturing	<b>HVAC Systems:</b> 80/20 MAU's
<b>Year Built:</b> 2023	<b>Electric:</b> 3000 AMPS
<b>Structure Exterior:</b> Precast Concrete Wall Panels	<b>Roof:</b> 45 Mil EPDM Ballasted



# Demographics



**342,514**  
Employees



**5,664**  
Businesses



**66% Between**  
Ages 15-64

	5 Miles	10 Miles	20 Miles
Total Population	108,726	214,779	774,985
Total Households	42,690	82,167	288,056
Average Household Income	\$89,118	\$90,624	\$106,708
Median Age	37.2	36.8	37.8

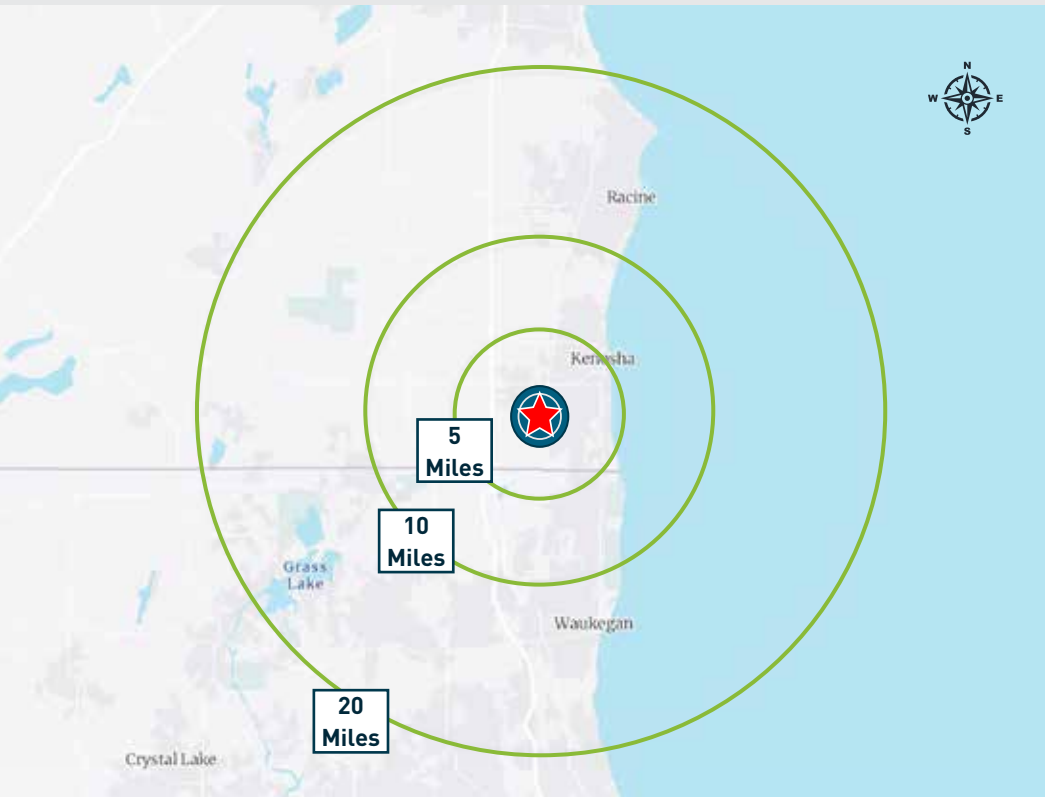

# Drive Times

City	Drive Time (Hours)
Milwaukee	0.5
Chicago	1.0
Indianapolis	4.5
St. Louis	5.5
Detroit	5.5
Des Moines	5.5
Minneapolis	5.5
Louisville	6.0
Cincinnati	6.0
Cleveland	6.5
Omaha	7.5
Kansas City	8.0
Pittsburgh	8.5
Nashville	8.5
Memphis	9.0

# LogistiCenter® at Pleasant Prairie

Pleasant Prairie, WI

[logisticcenteratpleasantprairie.com](http://logisticcenteratpleasantprairie.com)

## About Dermody

Dermody is a privately-owned real estate investment, development and management firm that specializes in the acquisition and development of logistics real estate in strategic locations for e-commerce fulfillment centers, third-party logistics and distribution customers. Founded in 1960, Dermody has invested more than \$10 billion of total capital across all platforms nationwide, having acquired and developed approximately 110 million square feet of logistics and industrial facilities. In addition to its corporate office in Reno, Nev., it has regional offices in northern and southern California, Atlanta, Phoenix, Seattle, Chicago, Dallas and New Jersey. For more information, visit [www.Dermody.com](http://www.Dermody.com).

## About the LogistiCenter® Brand

LogistiCenter® is a national trademark brand, owned and developed by Dermody. It represents the firm's business philosophy of developing Class A distribution facilities that meet the supply-chain requirements of the most innovative companies. All LogistiCenter® facilities are designed to meet best practices in sustainable design and construction, and incorporate building features, such as additional clear height and extra trailer and car parking, that enable companies to execute their operations more effectively and efficiently.

## About Colliers

Colliers (NASDAQ, TSX: CIGI) is a leading diversified professional services and investment management company. With operations in 62 countries, our 17,000 enterprising professionals work collaboratively to provide expert real estate and investment advice to clients. For more than 27 years, our experienced leadership with significant inside ownership has delivered compound annual investment returns of 20% for shareholders. With annual revenues of \$4.3 billion and \$65 billion of assets under management, Colliers maximizes the potential of property and real assets to accelerate the success of our clients, our investors and our people. Learn more at [corporate.colliers.com](http://corporate.colliers.com), Twitter @Colliers or LinkedIn.

This document/email has been prepared by Colliers for advertising and general information only. Colliers makes no guarantees, representations or warranties of any kind, expressed or implied, regarding the information including, but not limited to, warranties of content, accuracy and reliability. Any interested party should undertake their own inquiries as to the accuracy of the information. Colliers excludes unequivocally all inferred or implied terms, conditions and warranties arising out of this document and excludes all liability for loss and damages arising there from. This publication is the copyrighted property of Colliers and /or its licensor(s). © 2023. All rights reserved. This communication is not intended to cause or induce breach of an existing listing agreement. Colliers International, Inc.

### Neal Driscoll

Dermody

Partner, Midwest Region

+1 224 567-8503

[ndriscoll@dermody.com](mailto:ndriscoll@dermody.com)

### Brian Kling

Colliers

Principal

+ 1 847 698 8223

[brian.kling@colliers.com](mailto:brian.kling@colliers.com)

### Ned Frank

Colliers

Executive Vice President

+1 847 698 8261

[ned.frank@colliers.com](mailto:ned.frank@colliers.com)

### Mike Senner

Colliers

Executive Vice President

+1 847 698 8234

[mike.senner@colliers.com](mailto:mike.senner@colliers.com)



[Colliers.com](http://Colliers.com)



[Dermody.com](http://Dermody.com)