

FOR SALE OR LEASE > INDUSTRIAL

MULTI-TENANT BUILDING

22900-23000 INTERSTATE ROAD | CLINTON TOWNSHIP, MI



ZONED I-1 LIGHT INDUSTRIAL

> PROPERTY HIGHLIGHTS

- 23,192 SF Two-Tenant Industrial Building
- 6" Reinforced Concrete Floors
- Truckwell and Three 14' Overhead Doors
- 20' Clear Height
- Heavy Power 3,200 AMP/240 Volt
- Two Story Brick and Block Construction

COLLIERS INTERNATIONAL
2 Corporate Drive | Suite 300
Southfield, Michigan 48076

For More Information Call:

JUSTIN FRANCECK
PHONE 248 540 1000 EXT 1652
justin.franceck@colliers.com



colliers.com/detroit



FOR SALE OR LEASE > INDUSTRIAL

MULTI-TENANT BUILDING

22900-23000 INTERSTATE ROAD | CLINTON TOWNSHIP, MI



> PROPERTY PHOTOS



JUSTIN FRANCEK
PHONE 248 540 1000 EXT 1652
justin.francek@colliers.com



COLLIERS INTERNATIONAL
2 Corporate Dr. | Suite 300
Southfield, Michigan 48076

FOR SALE OR LEASE > INDUSTRIAL

MULTI-TENANT BUILDING

22900-23000 INTERSTATE ROAD | CLINTON TOWNSHIP, MI



> PROPERTY PHOTOS

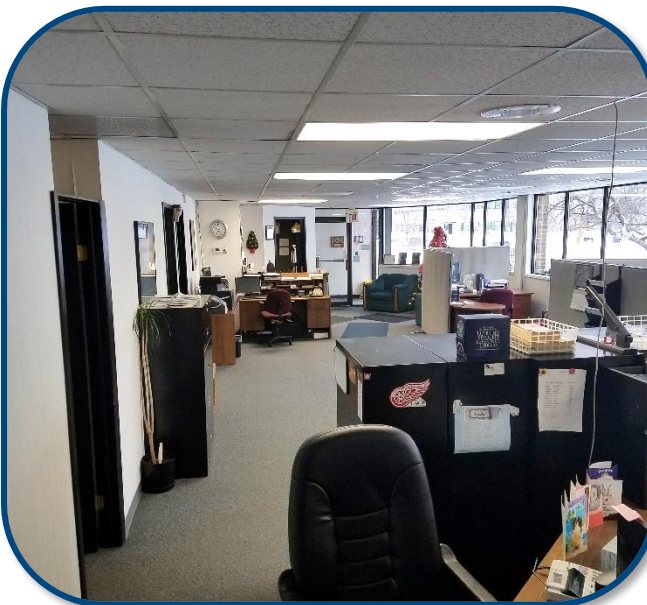

JUSTIN FRANCEK
PHONE 248 540 1000 EXT 1652
justin.francek@colliers.com



COLLIERS INTERNATIONAL
2 Corporate Dr. | Suite 300
Southfield, Michigan 48076

FOR SALE OR LEASE > INDUSTRIAL

MULTI-TENANT BUILDING

22900-23000 INTERSTATE ROAD | CLINTON TOWNSHIP, MI



> FLOOR PLAN

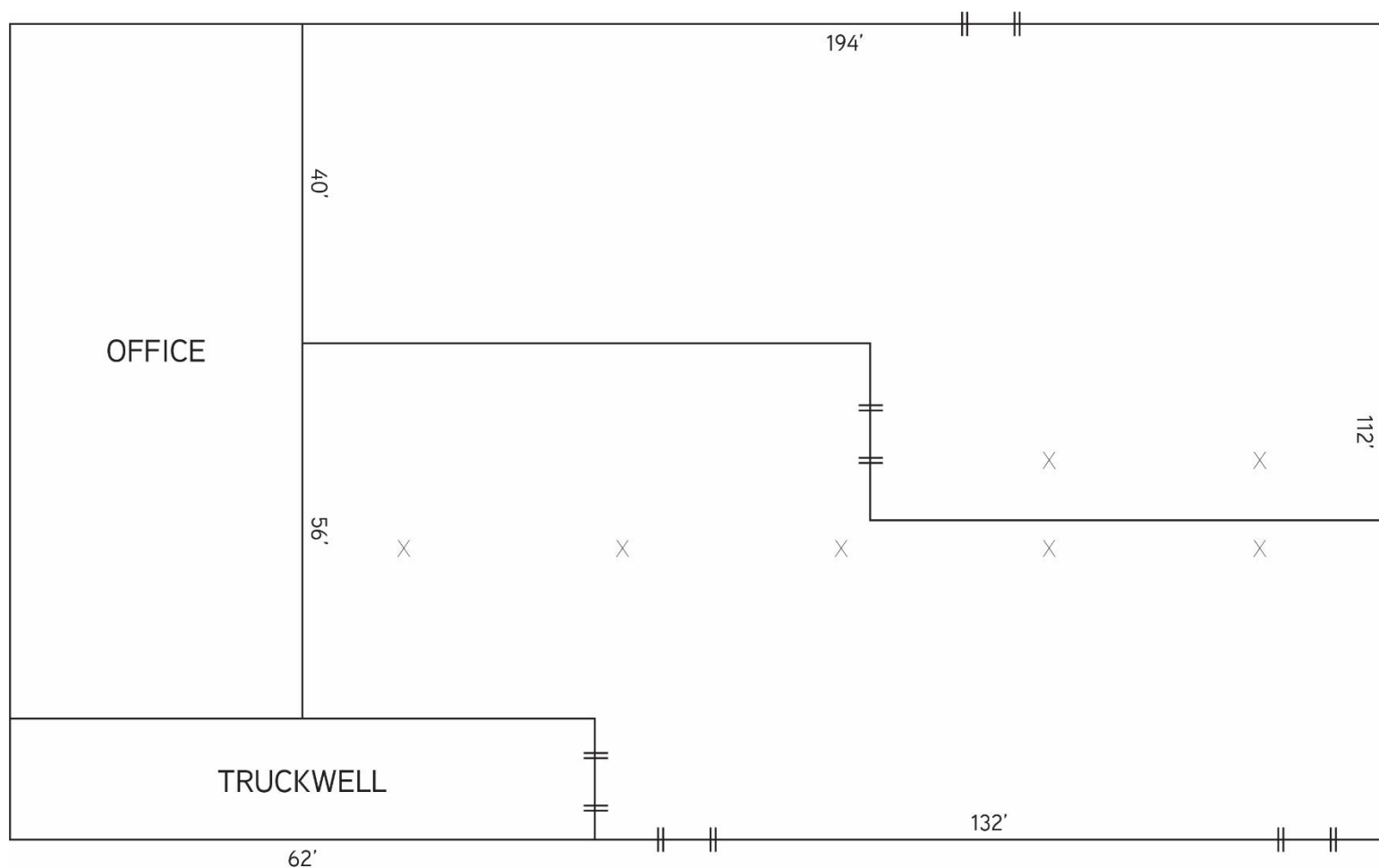

JUSTIN FRANCEK
PHONE 248 540 1000 EXT 1652
justin.francek@colliers.com



COLLIERS INTERNATIONAL
2 Corporate Dr. | Suite 300
Southfield, Michigan 48076

FOR SALE OR LEASE > INDUSTRIAL

MULTI-TENANT BUILDING

22900-23000 INTERSTATE ROAD | CLINTON TOWNSHIP, MI



> LOCATION MAP

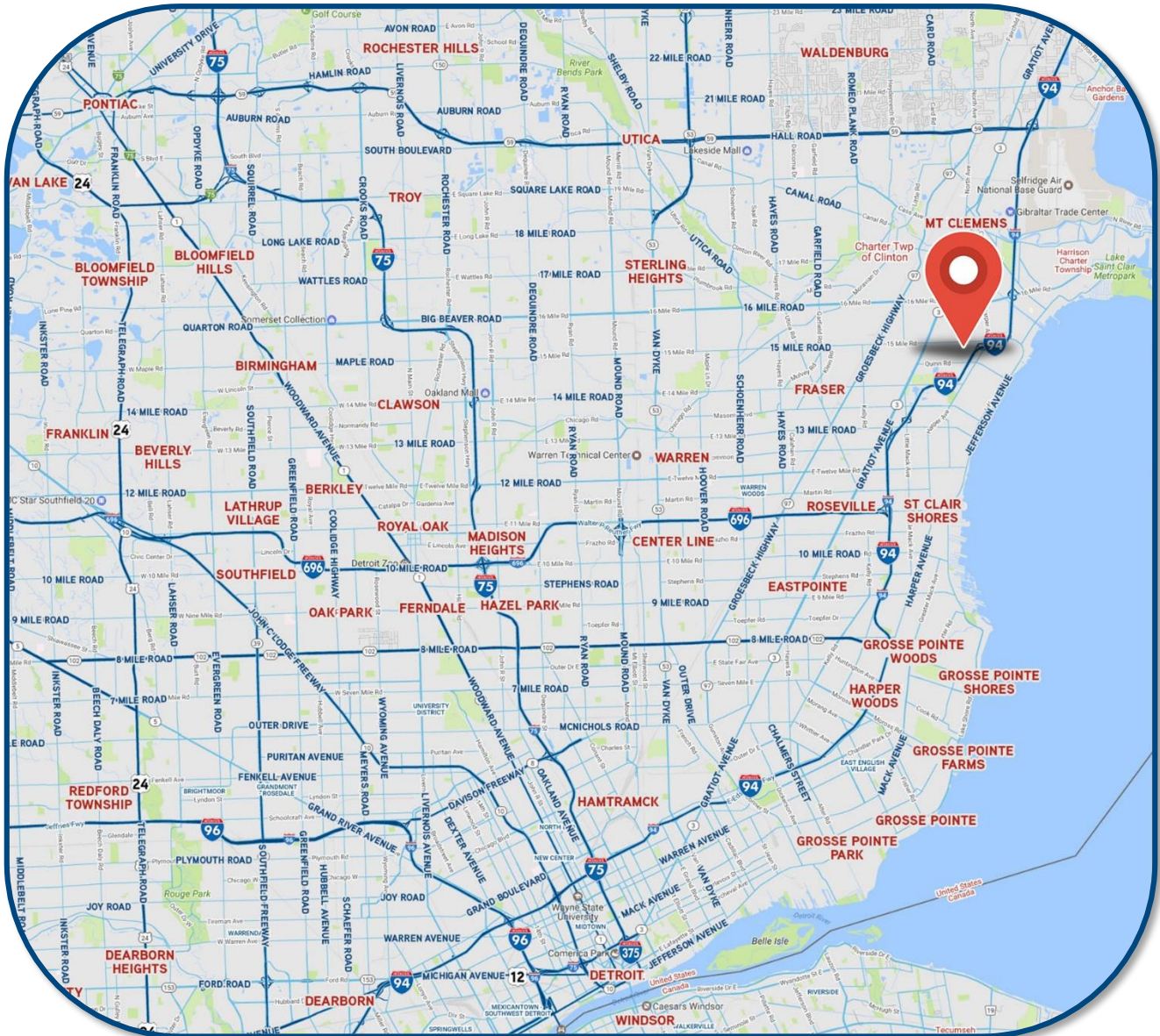

JUSTIN FRANCEK
PHONE 248 540 1000 EXT 1652
justin.francek@colliers.com



COLLIERS INTERNATIONAL
2 Corporate Dr. | Suite 300
Southfield, Michigan 48076

FOR SALE OR LEASE > INDUSTRIAL

MULTI-TENANT BUILDING

22900-23000 INTERSTATE ROAD | CLINTON TOWNSHIP, MI



> AERIAL MAP



JUSTIN FRANCEK
PHONE 248 540 1000 EXT 1652
justin.francek@colliers.com



COLLIERS INTERNATIONAL
2 Corporate Dr. | Suite 300
Southfield, Michigan 48076

Industrial Availability

For Sale / Lease

22900-23000 Interstate Road

Clinton Township, MI 48035



Sale Price: \$1,225,000
Sale Price SF : \$54.00
Lease Rate : \$5.55###
Gross Sq Ft: 23,192
Vacant Sq Ft: 23,192
Min Available Sq Ft: 23,192
Max Contiguous Sq Ft: 23,192
Date Built/Renovated: 1980 /
Percent Occupied:
Property Taxes/Year: \$22,174
Property Taxes/SF:
Parking: 46

For more information, contact:

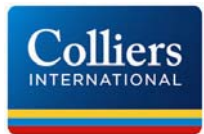

Justin Francek

justin.francek@colliers.com

(248) 540-1000

2 Corporate Drive, Suite 300
Southfield, MI 48076
248 540 1000

400 E. Washington St.
Ann Arbor, MI 48104
734 994 3100

County: Macomb
Crossroads: S. of 15 Mile Road; Just West of I-94

- 23,192 SF Two-Tenant Industrial Building
- 6" Reinforced Concrete Floors
- Truckwell and Three 14' Overhead Doors
- 20' Clear Height
- Heavy Power 3,200 AMP/240 Volt
- Two Story Brick and Block Construction

Ceiling Ht:
Doors: 3
Docks: 1
Bay Size:
Cranes: No
Underhook: No
Fixtures:
Power: 3200 AMP/240 Volt
Heating:
Buss Duct:
Railroad: No

| | |
|------------------|--------------|
| Shop SF: | Office SF: |
| Shop Rate: | Office Rate: |
| Shop Dimensions: | |

| | |
|--------------|--------------------------------|
| Acres: 3.058 | Site Status: Existing |
| Sub-Type: | Zoning: I-1 = Light Industrial |

| | |
|------------------------|-----------------|
| Construction: Existing | Roof: |
| Multi-tenant: Yes | Floors: 2 |
| Free-standing: Yes | Sprinklers: Yes |
| Basement: | |

www.colliers.com

Colliers International has prepared this document/email for advertising or general information only. Information contained herein has been obtained from the owners or from other sources deemed reliable. We have no reason to doubt its accuracy but regret we cannot guarantee it. All properties subject to change or withdrawal without notice.